



Flat 6 Nuthatch Apartments 16 Shearwater Drive, London, NW9 7GD

£507 Per Week



Flat 6 Nuthatch Apartments 16 Shearwater Drive, London, NW9 7GD

£507 Per Week

Welcome to Nuthatch Apartments, a charming property located at 16 Shearwater Drive in the heart of London. This delightful flat boasts a spacious 814 sq ft of living space, perfect for those seeking a comfortable and stylish home.

Upon entering, you are greeted by a welcoming reception room, ideal for entertaining guests or simply relaxing after a long day. The property features two cosy bedrooms, offering a peaceful retreat for a good night's sleep. With two bathrooms, convenience is key, ensuring there's no need to queue during the morning rush.

Situated in a prime location, Nuthatch Apartments provides easy access to all that London has to offer. Whether you fancy a leisurely stroll in the nearby parks, a shopping spree in the trendy boutiques, or a cultural outing to the museums and galleries, this property is the perfect base for your adventures.

Don't miss out on the opportunity to make this flat your own and experience the best of London living. Contact us today to arrange a viewing and take the first step towards calling Nuthatch Apartments your new home.

Description

Situation

Furnished/unfurnished
Council Tax Band: New Build
Available: 28th June 2024



Floor Plans

Shearwater Drive, NW9 7GD

Approx Gross Internal Area = 70.04 sq m / 754 sq ft
 Balcony = 5.61 sq m / 60 sq ft
 Total = 75.65 sq m / 814 sq ft

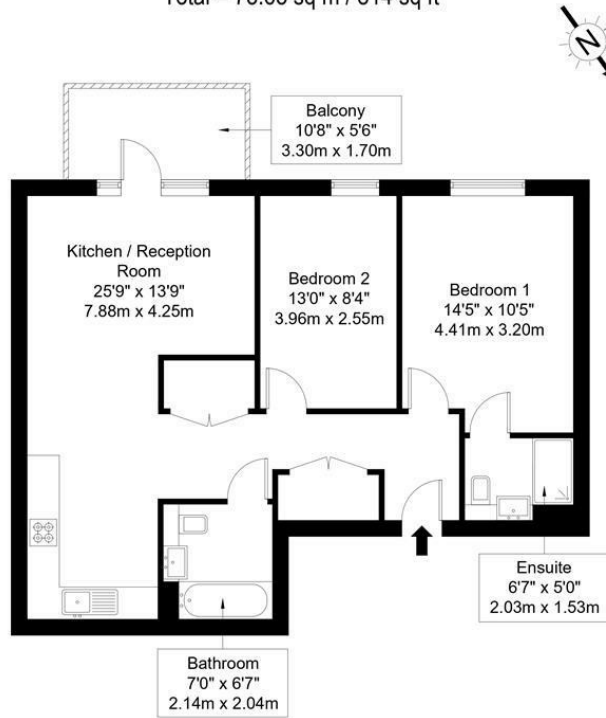

First Floor

Ref :

Copyright **BLEU PLAN**

The Floor plan is not to scale and measurements and areas shown are approximate and therefore should be used for illustrative purposes only. The plan has been prepared in accordance with the RICS code of Measuring Practice and whilst we have confidence in the information produced it must not be relied on. Maximum lengths and widths are represented on the floor plan. If there is any aspect of particular importance, you should carry out or commission your own inspection of the property.
 Copyright @ BLEUPLAN

Area Map

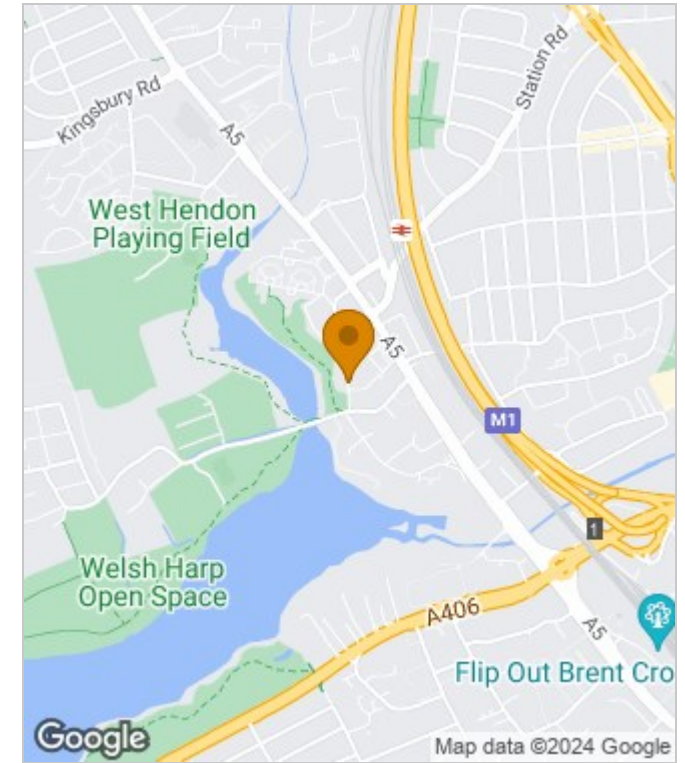

Energy Performance Graph

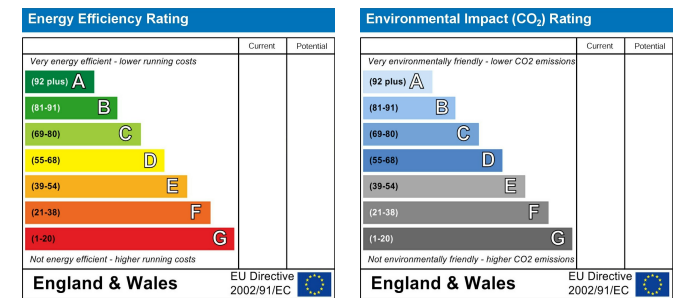

These particulars, whilst believed to be accurate are set out as a general outline only for guidance and do not constitute any part of an offer or contract. Intending purchasers should not rely on them as statements of representation of fact, but must satisfy themselves by inspection or otherwise as to their accuracy. No person in this firm's employment has the authority to make or give any representation or warranty in respect of the property.

3 Shortlands, Hammersmith, London, W6 8DA

Tel: 020 8124 1073 Email: management@lessel.co.uk <https://www.lessel.co.uk>