

Kingsquarter, SL6

MØVELI



## Kingsquarter, SL6

### Stylish 2-Bedroom Apartment with Balcony – No Onward Chain

- No Onward Chain
- First Floor Apartment
- Large Private Balcony
- Two Double Bedrooms
- Two Modern Bathrooms (one en suite)
- Allocated Parking
- Spacious Open Plan Kitchen / Reception



Welcome to Burghley Court, a beautifully presented first-floor apartment situated in the sought-after Kingsquarter development in Maidenhead. Offering modern living with a generous layout, this two-bedroom, two-bathroom home is perfect for professionals, couples, or downsizers looking for comfort and convenience.

The apartment features a bright and spacious open-plan kitchen and reception area, ideal for both entertaining and relaxing. The kitchen is well-equipped with integrated appliances and sleek cabinetry. From the reception area, step out onto a large private balcony, perfect for enjoying a morning coffee or evening unwind.

The principal bedroom benefits from a stylish en suite shower room, while the second double bedroom is served by a contemporary family bathroom. A separate study provides valuable additional space—ideal for working from home or as a hobby room.

In excellent order and offered with no onward chain, this property is ready to move into and enjoy.

Located within easy reach of Maidenhead town centre and the train station (with Elizabeth Line services), this home offers excellent connectivity alongside modern living in a well-maintained development.



LOCATION

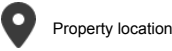

ENERGY PERFORMANCE  
CERTIFICATE (EPC)

Current: **83**

Potential: **83**

FLOOR PLAN

736 sq ft (68 sq m)

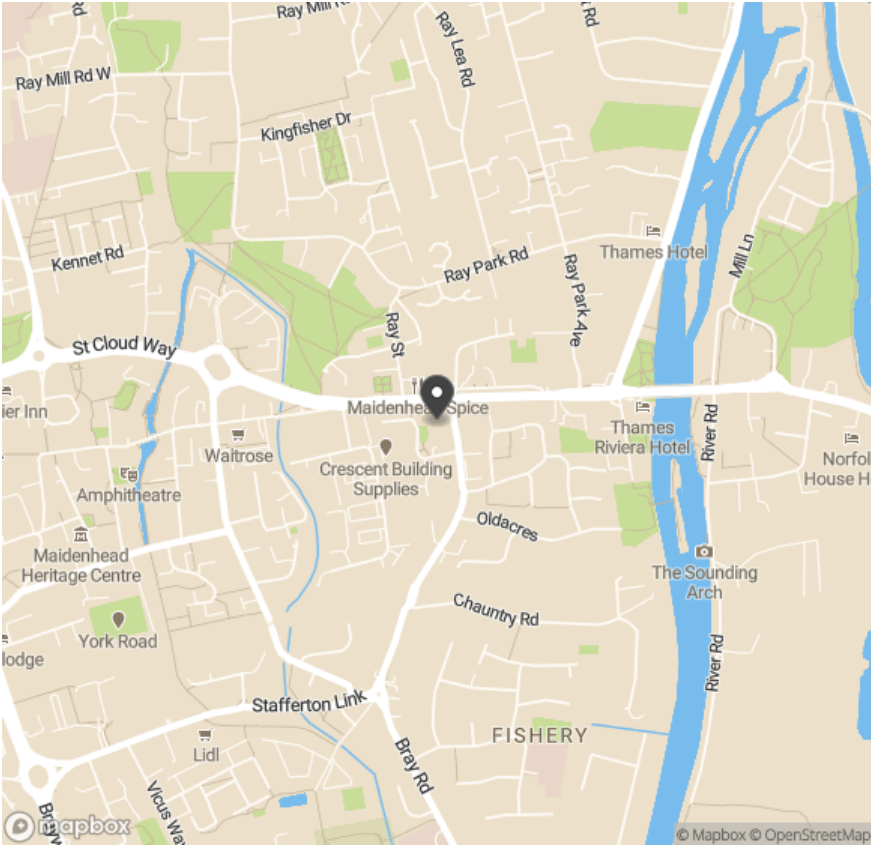

Approximate Gross Internal Area = 68.4 sq m / 736 sq ft

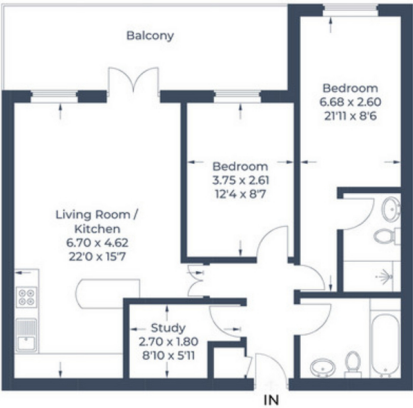

Illustration for identification purposes only.  
measurements are approximate, not to scale.  
© C3 Property Marketing Produced for Charles Perry-Adlam - Movelli

Important notice: Movelli give notice that: all text, photographs and plans on these brochure are for guidance only and are not necessarily comprehensive; any areas, measurements or distances given are approximate; these details do not constitute part of an offer or contract and must not be relied upon as statements or representations of fact; it should not be assumed that the property has all the necessary planning permissions and building regulations approvals; we are not authorised to give any representations or warranties in relation to this property whatsoever; potential purchasers must satisfy themselves as to the correctness of all details by inspection or otherwise. Alpinum Limited T/A Movelli, Brewery Farm, Old Coach Road, Axbridge, Somerset BS26 2EH Tel: 020 3150 0733 Email: hello@movelli.com

Charles Perry-Adlam

For viewings, further information or a free property valuation contact:

📞 (44) 7957-352-773 | 0203405514

✉️ [charles@moveli.co.uk](mailto:charles@moveli.co.uk)

MOVELI