



Ratcliffe Cross Street, E1

£500,000

Welcome to this charming two bedroom home moments away from Limehouse DLR station. The property also includes a long lease, private balcony, large communal garden, and bike storage.

The Kiln Works is just 0.2 miles from Limehouse DLR station, offering great links into the City and Canary Wharf.

Features

- Modern Throughout
- Two Double Bedrooms
- Long Lease
- Private Balcony
- Communal Garden
- Bike Storage

Ratcliffe Cross Street, London, E1

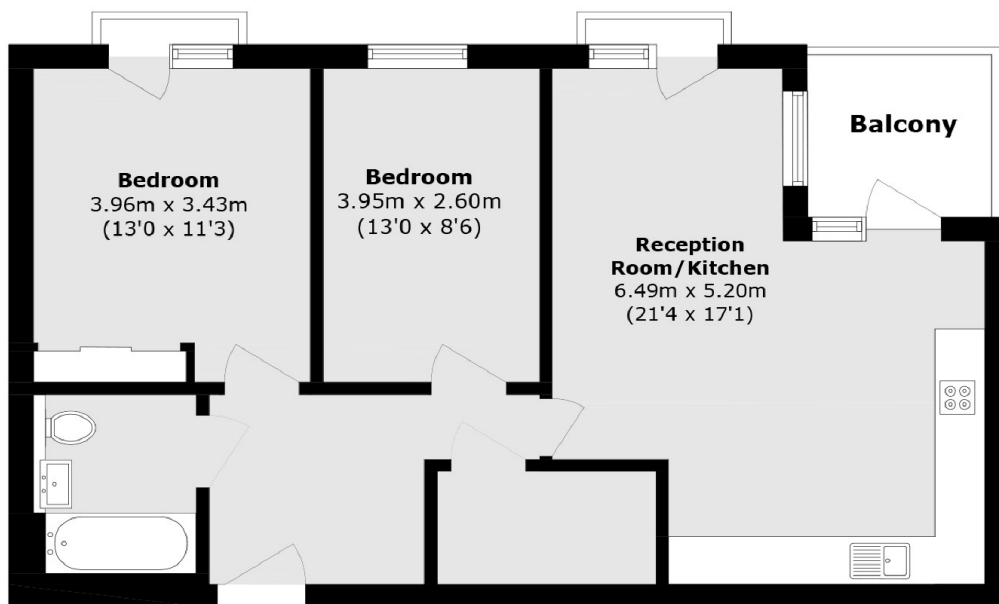

Total area (approx.): 68.9 sq. m (741.6.0 sq. ft)

Balcony area (approx.): 4.4 sq. m (47.3.0 sq. ft)