



Narrow Street, E14

£750,000

Offering 977 sq.ft is this River facing two bedroom, sixth floor home in the sought after development, Victoria Wharf. Features to include wooden flooring throughout, two private balconies, long lease, allocated parking and a concierge service. This property is also being offered chain free.

Victoria Wharf is a quarter of a mile to Limehouse DLR Station which provides excellent links to The City and Canary Wharf. The development is located on Narrow Street which has a selection of restaurants and riverside pubs including Gordon Ramsey's The Narrow.

Features

- Share Of Freehold
- River Facing
- Two Private Balconies
- Long Lease
- Allocated Parking
- Concierge Service

Narrow Street, London, E14

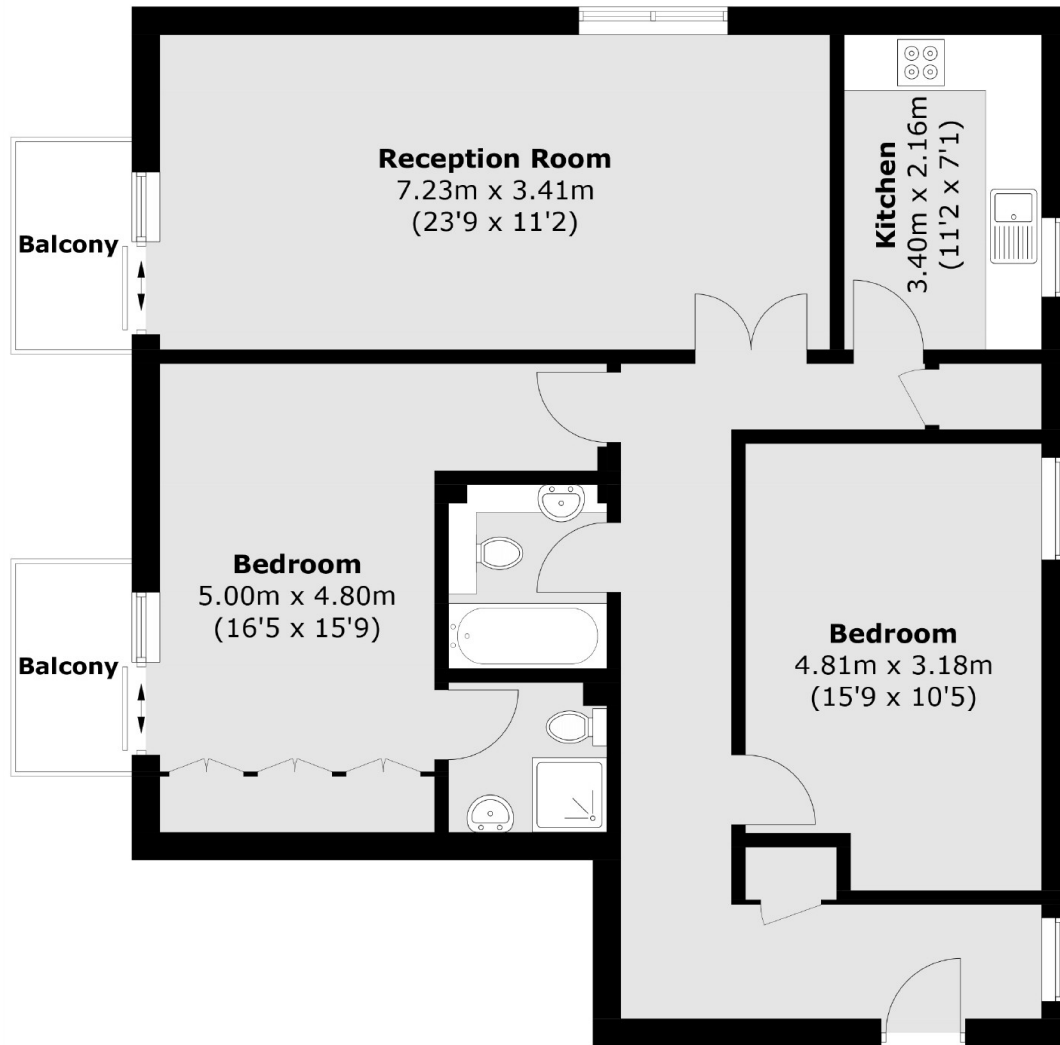

Sixth Floor

Total area (approx.): 90.8 sq. m (977.4 sq. ft)
Balcony area (approx.): 5.6 sq. m (60.3 sq. ft)