



## Artichoke Hill, E1W

### £550,000

Offering almost 950 sq.ft of ample living space is this well proportioned apartment located in West Wapping. To include two double bedrooms, bathroom, open plan reception, private balcony and 900 plus year lease.

Artichoke Hill is close to Tower Hill Station and Shadwell DLR with Aldgate and Aldgate East Tube just a little further but still within easy walking distance.

### Features

- 949.4 SqFt
- West Wapping Location
- Long Lease
- 88.3 sq.ft Private Balcony
- 900 Plus Year Lease
- EWS1 Compliant

# Artichoke Hill, London, E1W

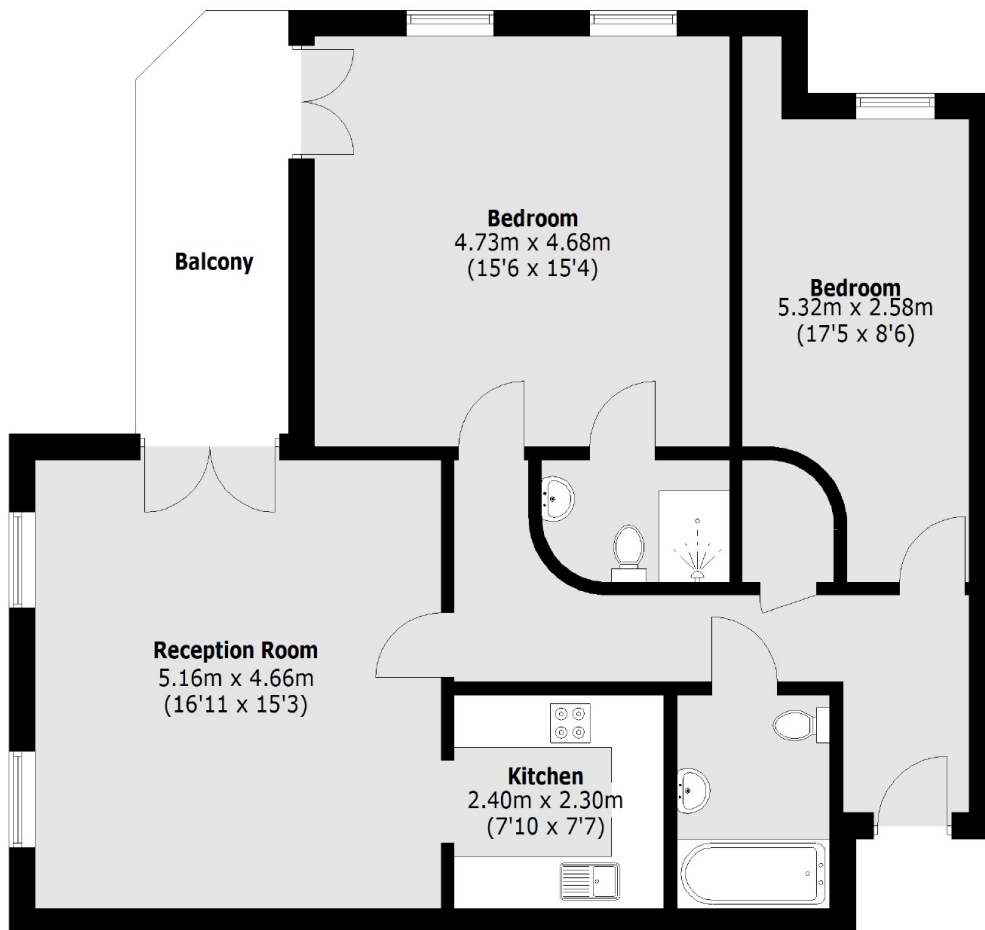

Total area (approx.): 88.2 sq. m (949.4 sq. ft)  
Balcony area: 8.2 sq. m (88.3 sq. ft)