

Artichoke Hill, E1W

£600,000

Offering almost 950 sq.ft of ample living space is this well proportioned apartment located in West Wapping. To include two double bedrooms, bathroom, open plan reception and private balcony.

Artichoke Hill is close to Tower Hill Station and Shadwell DLR with Aldgate and Aldgate East Tube just a little further but still within easy walking distance.

Features

- 949.4 sq.ft
- West Wapping Location
- Long Lease
- 88.3 sq.ft Private Balcony
- Two Double Bedrooms
- EWS1 Compliant

Artichoke Hill, London, E1W

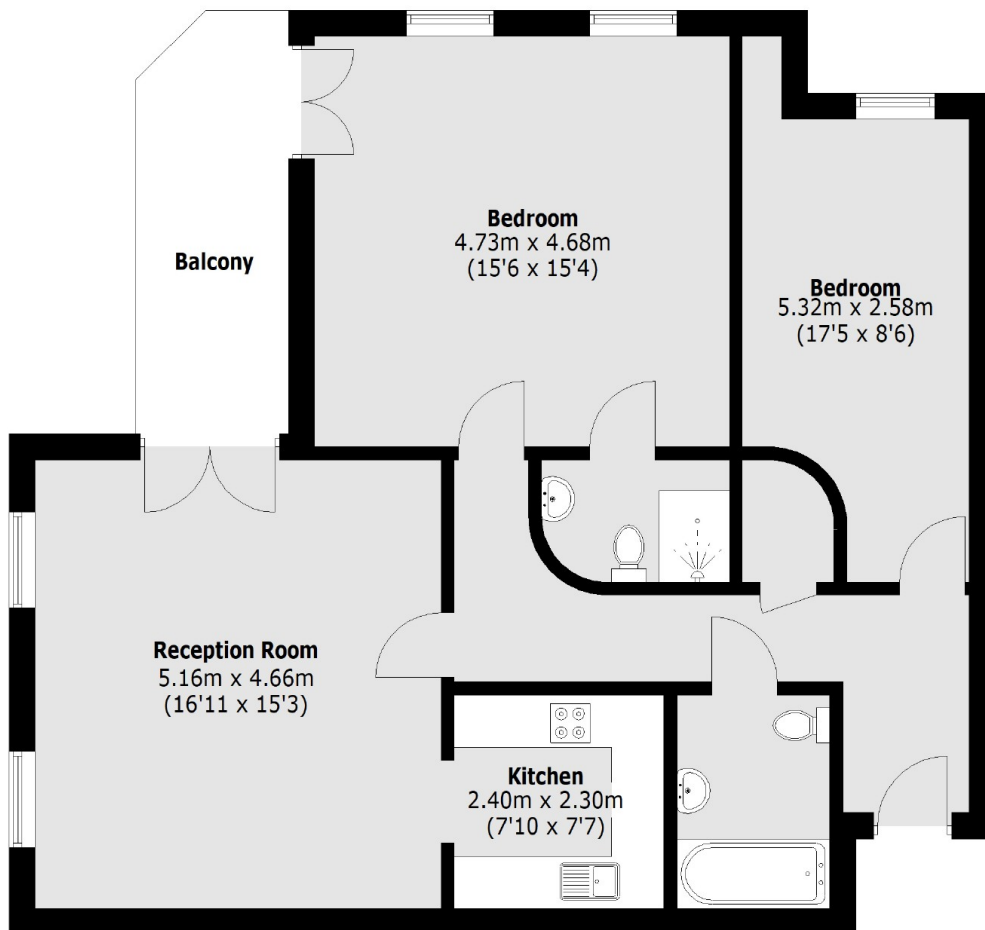

Total area (approx.): 88.2 sq. m (949.4 sq. ft)
Balcony area: 8.2 sq. m (88.3 sq. ft)