

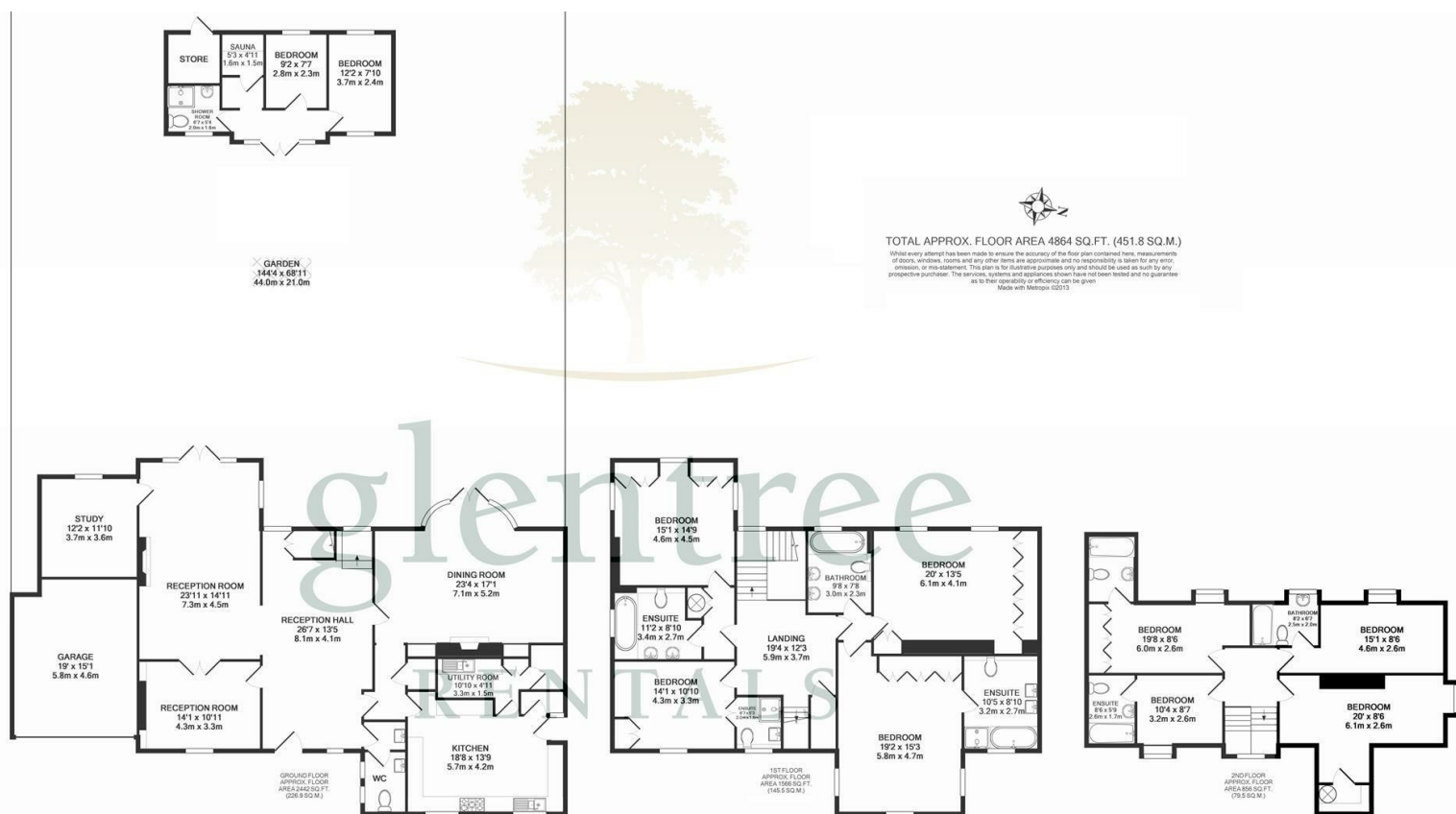

glentree
RENTALS

020 8209 1144
www.glentree.com



Winnington Road, N2

A substantial double fronted family home which is located on a premier road in Hampstead Garden Suburb and within walking distance to the green spaces of Hampstead Heath and Kenwood.

The property offers just under 5000 sq ft of excellent family living and entertaining space and comprises, 8 double bedrooms, 7 bathrooms (6 en-suite), 3 reception rooms, 1 study, 1 guest cloakroom, fully fitted eat-in kitchen, utility room, carriage driveway with off-street parking for up to 5 cars, garage and extensive private lawned garden with summer house.

Energy Efficiency Rating E54

£3,995 Per Week



RENTALS 020 8209 1144
SALES 020 8458 7311
FAX 020 8209 0307

E rentals@glentree.com
E sales@glentree.com
W www.glentree.com

Glentree Estates Ltd
698 Finchley Road
London NW11 7NE

