

Westridge Road,



3



2



1



Offers Over £375,000

Nestled on Westridge Road in Birmingham, this charming semi-detached house, built between 1930 and 1939, offers a wonderful opportunity for those seeking a property with great potential. Spanning an impressive 1,490 square feet, this residence features two spacious reception rooms, perfect for entertaining guests or enjoying family time. The three well-proportioned bedrooms provide ample space for relaxation, while the bathroom is conveniently located to serve the household.

One of the standout features of this property is the substantial plot size, measuring an impressive 9,150 square feet. This expansive land not only offers a generous outdoor space for gardening or recreational activities but also presents exciting possibilities for development, allowing you to tailor the property to your specific needs and desires.

While the house does require some updating, it is a blank canvas waiting for your personal touch. With parking available for up to six vehicles, convenience is assured for both residents and visitors alike.

This property is ideal for families or individuals looking to invest in a home with significant potential in a desirable Birmingham location. Don't miss the chance to transform this house into your dream home.



Westridge Road,

- Semi-Detached
- 3 Bedrooms
- Off-Road Parking
- Potential Development Project
- IMPRESSIVE 9150 PLOT SIZE Sq Ft
- 2 Reception Rooms
- Lockable Garage
- Desirable Location
- Potential To Become A Stunning Family Home
- CHAIN FREE!

Reception

15'5" x 11'0" (4.71m x 3.36m)

Double glazed bay window to front, carpet flooring, chimney breast, fireplace, wall mounted radiator, ceiling lights, wall lights, skirting, coving to ceiling

Living Room

18'6" x 10'5" (5.64m x 3.18m)

Double glazed window to rear, double glazed door to rear, laminate flooring, fireplace, chimney breast, ceiling light, skirting, wall mounted radiator, wall lights

Kitchen

18'5" x 8'6" (5.61m x 2.60m)

Double glazed window to rear, tile flooring, splash back tiling, ceiling lights, generous number of storage units, worktops, drainer sink with mixer tap, Plumbing for white goods, wall mounted radiator

Pantry

10'4" x 2'11" (3.14m x 0.88m)

Double glazed window to front rear, carpet laminate flooring, wall mounted radiator, skirting, ceiling light, Built up wardrobes

WC

5'1" x 2'23" (1.57 x .68)

Double glazed window to side, tile flooring, toilet, ceiling light

Garage 1

14'7" x 7'9" (4.45m x 2.37m)

Garage door, ceiling light, concrete flooring, door to kitchen

Garage 2

15'0" x 11'3" (4.56m x 3.44m)

Garage door, windows on side, ceiling light, concrete flooring, door to garden

Bedroom 1

13'8" x 10'11" (4.16m x 3.34m)

Double glazed window to front, carpet flooring, wall mounted radiator, skirting, ceiling light

Bedroom 2

10'7" x 10'11" (3.23m x 3.33m)

Double glazed window to rear, carpet flooring, wall mounted radiator, skirting, ceiling light

Bedroom 3

8'6" x 6'7" (2.60m x 2.00m)

Double glazed window to front, carpet flooring, wall mounted radiator, skirting, ceiling light

Directions



Westridge Road,



Bathroom

6'3" x 9'0" (1.91m x 2.74m)

Privacy double glazed window to rear, carpet flooring, wall tiles, bathtub with separate taps, shower unit, pedestal sink with separate taps, extractor fan, wall mounted radiator

Separate Toilet

2'4" x 5'2" (0.72m x 1.58m)

Double glazed window to side, laminate flooring, toilet, ceiling light

Garden

Spacious garden, IMPRESSIVE 9150 Sq Ft PLOT SIZE, garden slabs, privacy from rear, Fence panels to boundaries, laid lawn, Hedge shrubs



Westridge Road,



Westridge Road,

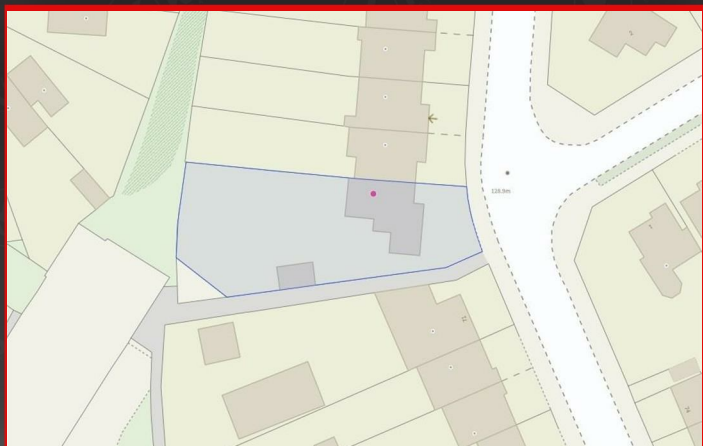
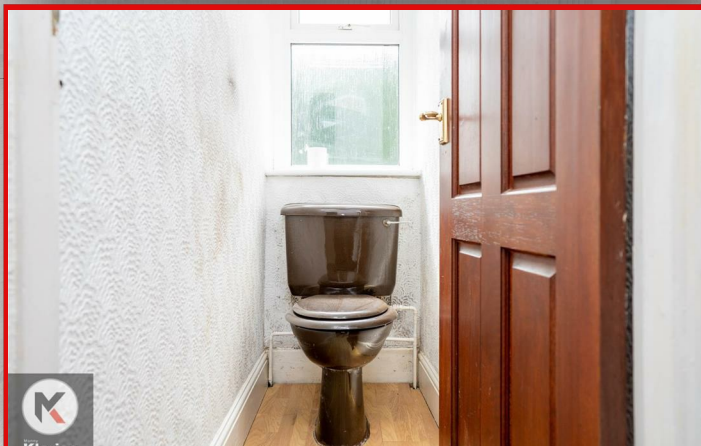

Westridge Road,

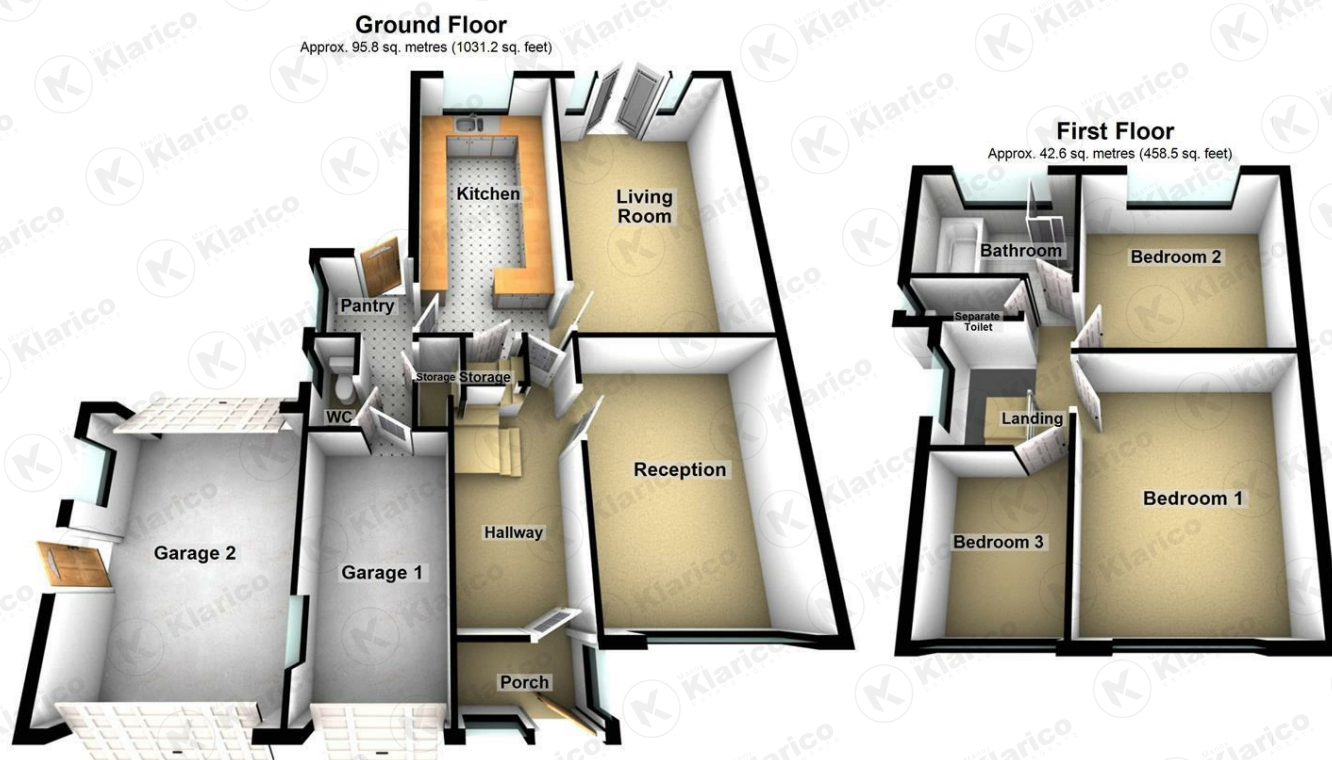

Total area: approx. 138.4 sq. metres (1489.7 sq. feet)



Manny
Klarico
ESTATE AGENTS

176 Highfield Road
Hall Green
Birmingham
West Midlands
B28 0HT

0121 777 7211
www.mannyklarico.co.uk

