

# Warwick Gardens, Hall Green



4



2



2



B

£1,950 PCM

KLARICO Estate Agents are delighted to present this impressive fully furnished detached property located within a prominent part of Hall Green, Birmingham. Benefits from having off-road parking for multiple vehicles and presented to a high standard.



# Warwick Gardens, Hall Green

- Detached
- Newly Built
- Open Plan Kitchen Diner
- Ideal Family Home
- 4 Bedrooms
- FULLY FURNISHED
- En-Suite
- Off-Road Parking
- UPVC Double Glazing

## Lounge

13'5" x 12'1" (4.10m x 3.70m)

Double glazed bay window to front, ceiling light, wall mounted radiator, corner sofa, tv stand, cushions, coffee table and side cupboard

## Kitchen/Diner

20'11" x 13'1" (6.40m x 4.00m)

Double glazed windows and patio doors to rear, ceiling downlights, ceramic floor tiling, wall mounted radiator, worktop, storage cupboard, drainer sink with mixer tap, extractor. Integrated appliances include a microwave, oven, gas cooker, tv

## WC

Ceiling light, heated towel rail, vanity wash unit with mixer tap, toilet

## Utility Room

7'8" x 5'6" (2.36m x 1.70m)

Access to side, worktop, drainer sink with mixer tap, storage cupboard, plumbing for white goods, washing machine, drying machine

## Bedroom 1

13'1" x 9'6" (4.00m x 2.91m)

Double glazed window to front, carpet, ceiling light, bed, wall mounted radiator, wardrobe and bedside cabinet

## Bedroom 2

12'5" x 10'9" (3.80m x 3.30m)

Double glazed window to rear, carpet, ceiling light, wall mounted radiator, access to en-suite, bed, wardrobe and bedside cabinet

## Bedroom 2 En-Suite

8'1" x 4'7" (2.48m x 1.40m)

Privacy double glazed window to side, double shower enclosure with thermostatic shower unit, toilet, vanity wash unit with mixer tap, ceiling light

## Bedroom 3

8'2" x 7'2" (2.50m x 2.20m)

Double glazed window to front, carpet, ceiling light, storage cupboard, wall mounted radiator, desk and office chair

## Bedroom 4

10'2" x 8'11" (3.10m x 2.72)

Double glazed window to rear, carpet, ceiling light, bed, storage cupboard, wall mounted radiator, desk and office chair

## Bathroom

7'2" x 6'6" (2.20m x 2.00m)

Ceiling downlights, bath with electric shower unit, vanity wash unit, toilet, floor and wall tiles

## Rear Garden

Patio, laid lawn, fence panels boundaries, side access to front

## Directions



Warwick Gardens, Hall Green



# Warwick Gardens, Hall Green



# Warwick Gardens, Hall Green



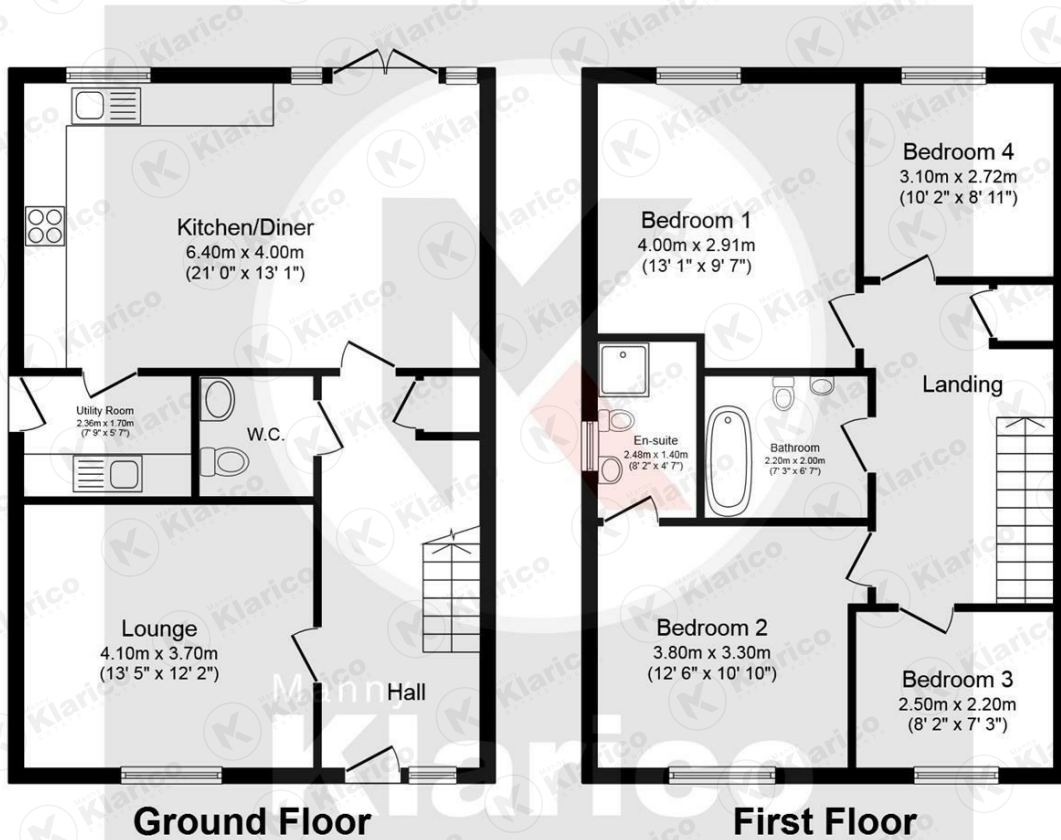

Total floor area 122.9 sq.m. (1,323 sq.ft.) approx

This plan is for illustration purposes only and may not be representative of the property. Plan not to scale. Powered by PropertyBox



Manny  
**Klarico**  
ESTATE AGENTS

176 Highfield Road  
Hall Green  
Birmingham  
West Midlands  
B28 0HT

0121 777 7211

[www.mannyklarico.co.uk](http://www.mannyklarico.co.uk)

