

Denville Crescent, Bordesley Green

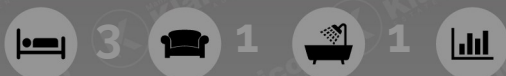

Contact us for more information 0121 777 7211

Denville Crescent, Bordesley Green



Directions



KLARICO Estate Agents are delighted to present this stunning 4 bedroom mid-terrace property situated within a sought after street in Bordesley Green Birmingham. Ideal Family Home.

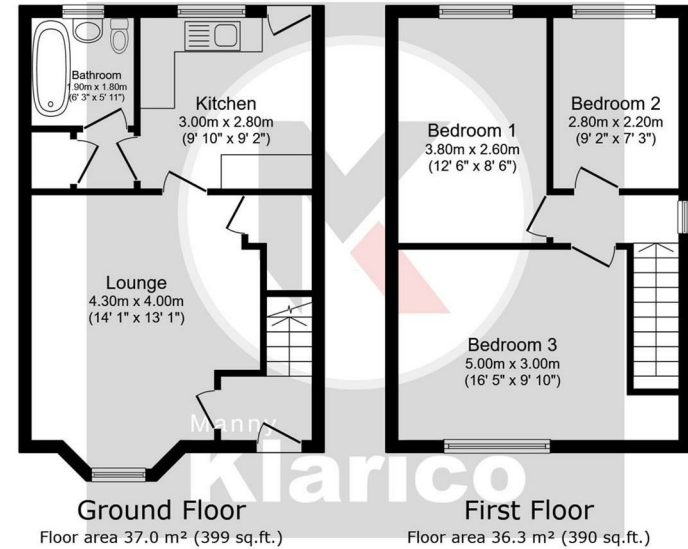

TOTAL: 73.3 m² (789 sq.ft.)

This floor plan is for illustrative purposes only. It is not drawn to scale. Any measurements, floor areas (including any total floor area), openings and orientations are approximate. No details are guaranteed, they cannot be relied upon for any purpose and do not form any part of any agreement. No liability is taken for any error, omission or misstatement. A party must rely upon its own inspection(s).

Lounge

4.30 x 4.00 (14'1" x 13'1")

Kitchen

3.00 x 2.80 (9'10" x 9'2")

Bathroom

1.90 x 1.80 (6'2" x 5'10")

Bedroom 1

3.80 x 2.60 (12'5" x 8'6")

Bedroom 2

2.80 x 2.20 (9'2" x 7'2")

Bedroom 3

5.00 x 3.00 (16'4" x 9'10")

Garden