

Boscombe Road,



**Offers Over £175,000**

KLARICO Estate Agents are delighted to present this stunning 3 bedroom mid terraced property located within a popular part of Birmingham. An ideal property for a first time buyer or a buy-to-let. Presented to a good standard.

The ground floor briefly comprises of two separate reception rooms with access into the kitchen leading into the bathroom. The first floor provides 3 spacious bedrooms. This property features a well presented rear garden. Within the local proximity can be found a number of facilities including a range of schools such as Al-Furqan Primary School and The Olive School. Nearby transport links including rail and bus are also found within a short walking distance.





## Boscombe Road,

- Mid Terraced
- 2 Reception Rooms
- UPVC Double Glazing
- Ideal Family Home
- 3 Bedroom
- Well Presented
- Gas Central Heating
- Ideal Buy-To-Let

### Reception Room

11'1" x 10'5" (3.40m x 3.20m)

Double glazed bay window to front, carpet, ceiling light, wall mounted radiator

### Lounge/Dining Room

11'1" x 10'5" (3.40m x 3.20m)

Double glazed window to rear, carpet, ceiling light, wall mounted radiator

### Kitchen

8'6" x 5'6" (2.60m x 1.70m)

Double glazed window to side, tiled flooring, ceiling light, worktop, storage cupboards, drainer sink with mixer tap

### Bathroom

8'6" x 5'6" (2.60m x 1.70m)

Privacy double glazed window to rear, wall cladding, bath with thermostatic shower unit, pedestal sink with mixer tap, toilet, ceiling light

### Bedroom 1

11'1" x 10'5" (3.40m x 3.20m)

Two double glazed windows to front, carpet, ceiling light, wall mounted radiator

### Bedroom 2

11'1" x 7'6" (3.40m x 2.30m)

Double glazed window to rear, wall mounted radiator, ceiling light, carpet

### Bedroom 3

8'6" x 5'10" (2.60m x 1.80m)

Double glazed window to rear, wall mounted radiator, ceiling light, carpet

### Rear Garden

Patio, laid lawn, fence panels to boundaries

## Directions





Boscombe Road,



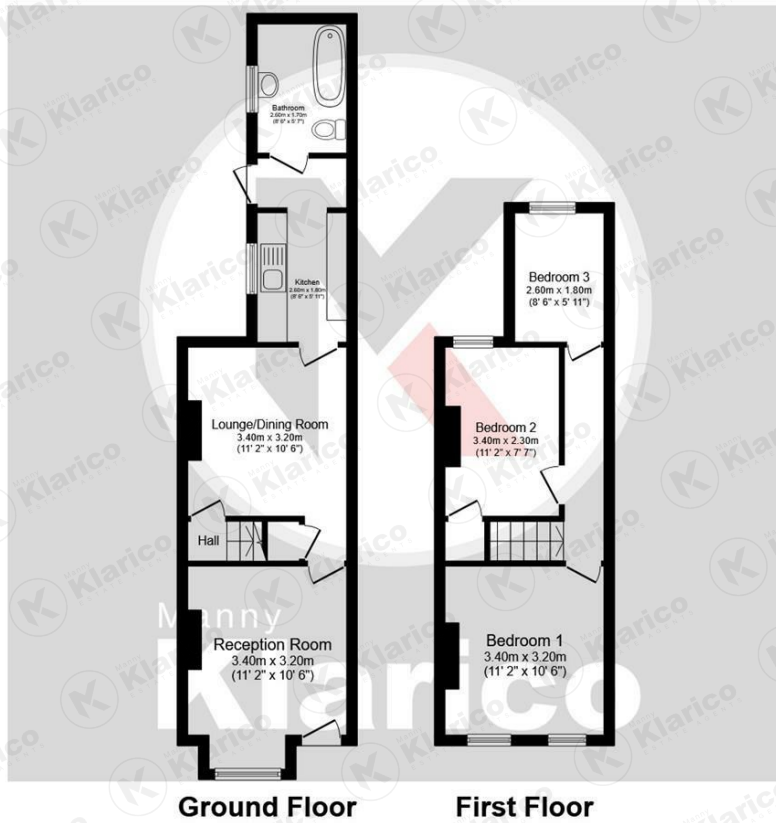

Total floor area 67.5 sq.m. (727 sq.ft.) approx

This plan is for illustration purposes only and may not be representative of the property. Plan not to scale.



Manny  
**Klarico**  
ESTATE AGENTS

176 Highfield Road  
Hall Green  
Birmingham  
West Midlands  
B28 0HT

0121 777 7211

[www.mannyklarico.co.uk](http://www.mannyklarico.co.uk)

