

Westfield Road, Kings Heath



Contact us for more information 0121 777 7211



Directions



KLARICO Estate Agents would like to present this 3 bedroom Terraced property situated within Kings Heath, Birmingham. Benefits from having a rear extension with the potential of becoming a stunning family home.

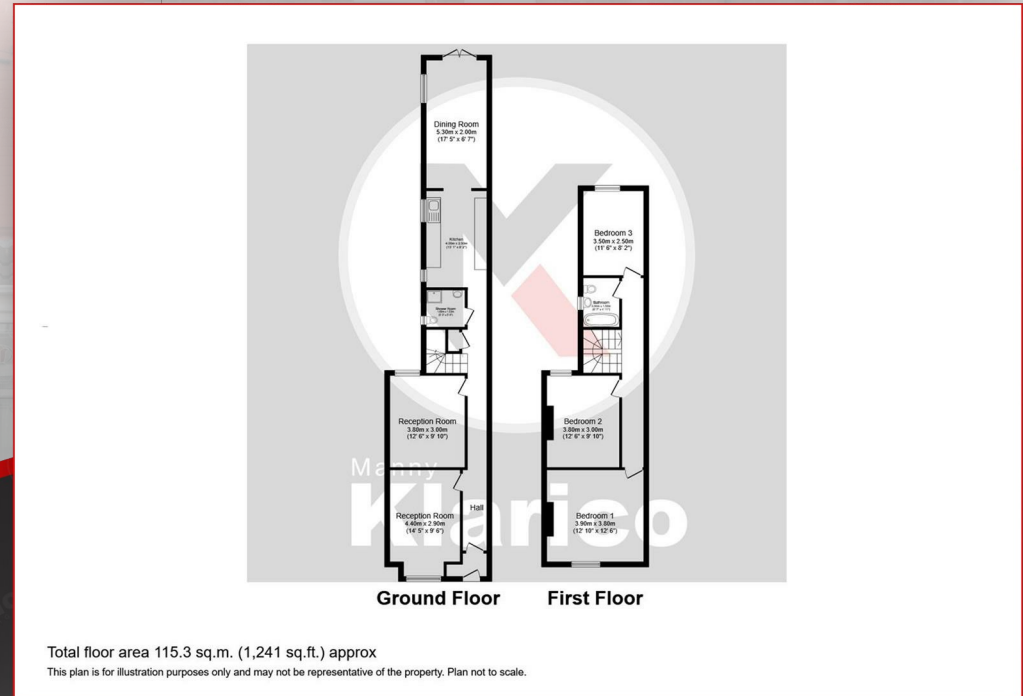

Reception Room
4.40m x 2.90m (14'5" x 9'6")

Reception Room
3.80m x 3.00m (12'5" x 9'10")

Shower Room

Kitchen
4.50m x 2.50m (14'9" x 8'2")

Dining Room
5.30m x 2.00m (17'4" x 6'6")

Bedroom 1
3.90m x 3.80m (12'9" x 12'5")

Bedroom 2
3.80m x 3.00m (12'5" x 9'10")

Bedroom 3
3.50m x 2.50m (11'5" x 8'2")

Bathroom