

Sherwood Road, Hall Green



4



2



1



D

£395,000

KLARICO Estate Agents are delighted to present this stunning 4 bed semi-detached property located within a sought after street on Hall Green, Birmingham. Benefits from having a large frontage to provide off-road parking for several vehicles and features a side extension.

The ground floor briefly comprises 2 reception rooms, a kitchen with access into the utility area. The first floor provides 4 spacious bedrooms along with a family bathroom. Presented to a good standard which the potential to become a stunning family home. This property features an impressive frontage with the additional space to the side.

Within the local proximity can be found a number of good schools and nurseries along with easy access to public transport links including rail and bus. This property sits approx 4 miles from Birmingham City Centre.



Sherwood Road, Hall Green

- Semi-Detached
- 4 Bedrooms
- Well Presented
- Gas Central Heating
- Chain Free
- Impressive Frontage With Land To The Side
- 2 Reception Rooms
- UPVC Double Glazing
- Ideal Family Home

Dining Room

15'8" x 10'5" (4.80m x 3.20m)

Double glazed bay window to front, wall mounted radiator, chimney breast with gas fireplace, ceiling light, wood flooring

Lounge

15'1" x 12'1" (4.60m x 3.70m)

Double glazed patio doors to rear, wall mounted radiator, chimney breast with gas fireplace, ceiling light, wood flooring

Kitchen

13'1" x 8'2" (4.00m x 2.50m)

Double glazed window to rear, worktop, drainer sink with mixer tap, storage cupboards, tiled flooring, ceiling downlights, wall mounted radiator

Utility

15'1" x 9'10" (4.60m x 3.00m)

Double glazed windows and door to rear, spacious, potential for conversion (stpp)

Garage

17'0" x 9'10" (5.20m x 3.00m)

Bedroom 1

15'5" x 11'9" (4.70m x 3.60m)

Double glazed bay window to front, wall mounted radiator, wood flooring, ceiling light

Bedroom 2

15'8" x 10'5" (4.80m x 3.20m)

Double glazed bay window to rear, wall mounted radiator, wood flooring, ceiling light

Bedroom 3

12'5" x 9'10" (3.80m x 3.00m)

Double glazed window to front, wall mounted radiator, wood flooring, ceiling light

Bedroom 4

8'6" x 6'10" (2.60m x 2.10m)

Double glazed window to front, wall mounted radiator, wood flooring, ceiling light

Shower Room

9'6" x 7'10" (2.90m x 2.40m)

Privacy double glazed window to rear and side, tiled flooring, wall tiles, bath, pedestal sink, shower cubicle with thermostatic shower unit, toilet, ceiling down lights, extractor

Rear Garden

patio, laid lawn, fence panels to boundaries

Directions

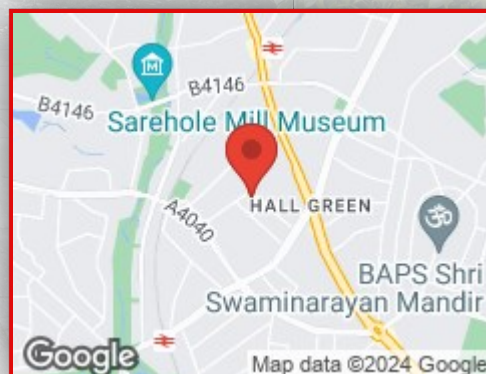



Sherwood Road, Hall Green



Sherwood Road, Hall Green



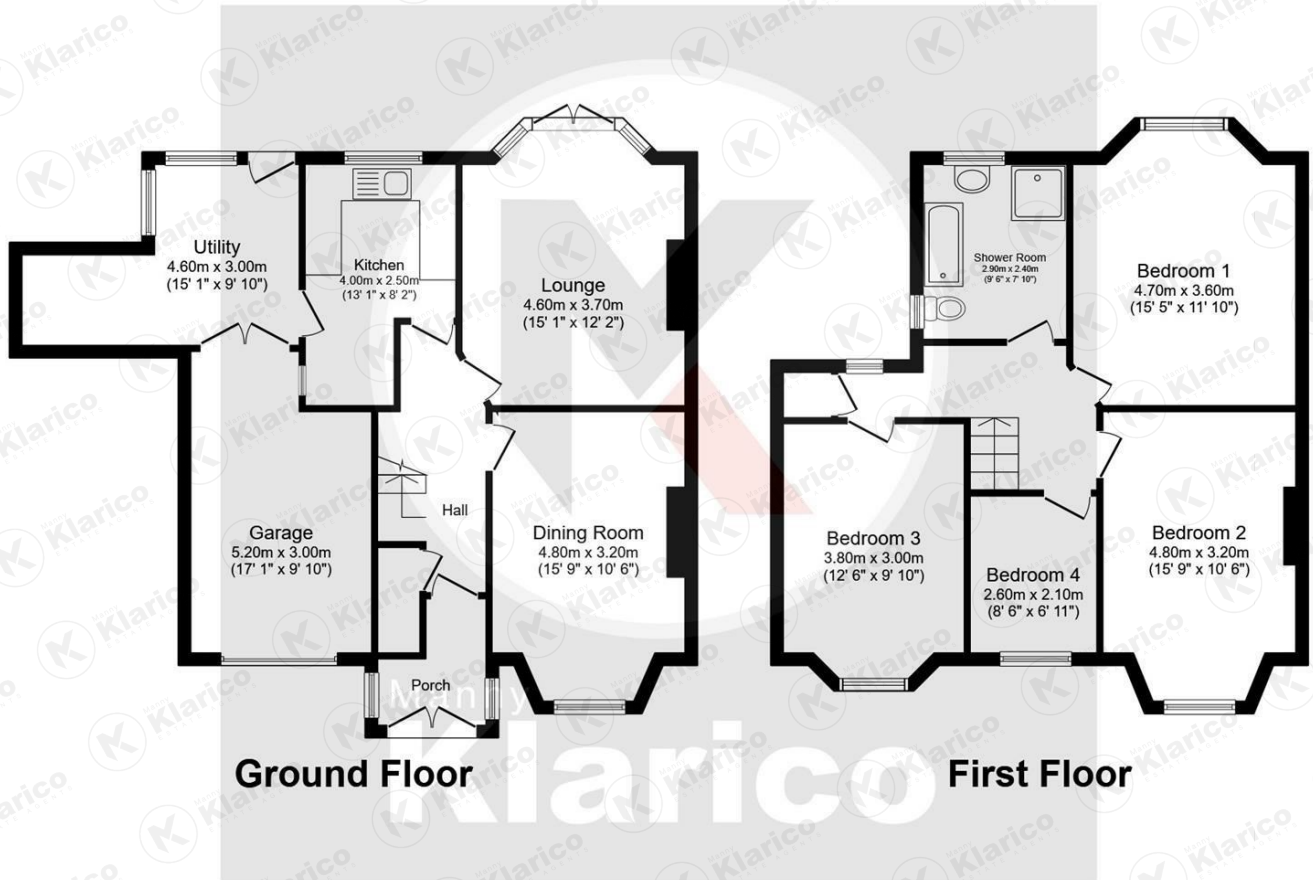

Total floor area 140.4 m² (1,512 sq.ft.) approx

This plan is for illustration purposes only and may not be representative of the property. Plan not to scale. Powered by PropertyBox



Manny
Klarico
ESTATE AGENTS

176 Highfield Road
Hall Green
Birmingham
West Midlands
B28 0HT

0121 777 7211

www.mannyklarico.co.uk

