



## 8 Kew Bridge Road, TW8

£2,650 pcm



- Two Bedrooms
- Two Bathrooms

- Modern Interior
- Concierge On Site

- Underground Parking
- Kew Bridge Station

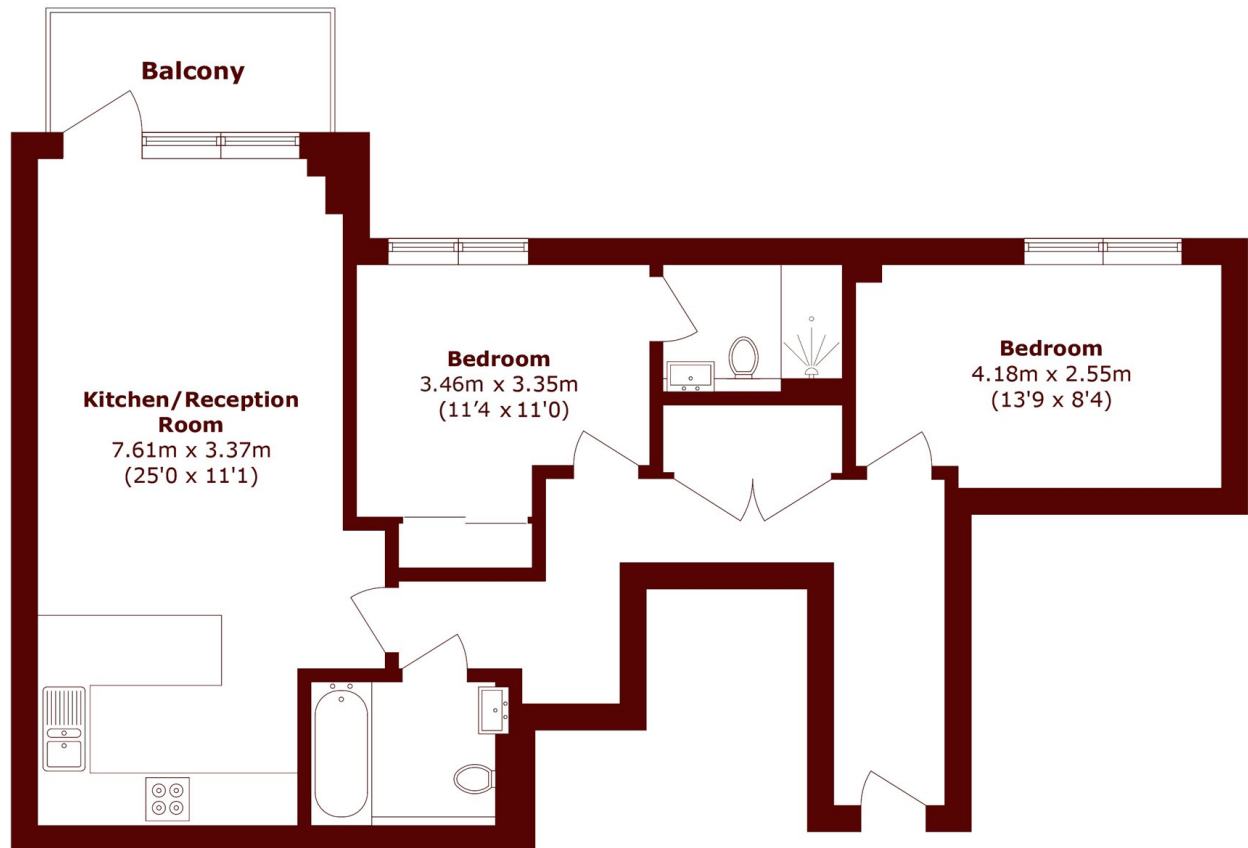

Total area (approx.): 69.2 sq. m (744.8 sq. ft)  
Balcony area (approx.): 4.3 sq. m (46.2 sq. ft)

## Marsh & Parsons Chiswick

34-38 Turnham Green  
Terrace, London, W4 1QP  
020 8994 2556