



## Winchester Street, W3

£425,000



- One Bedroom
- First Floor
- Modern Interiors
- High Ceilings
- Bicycle Storage
- Close To Transport

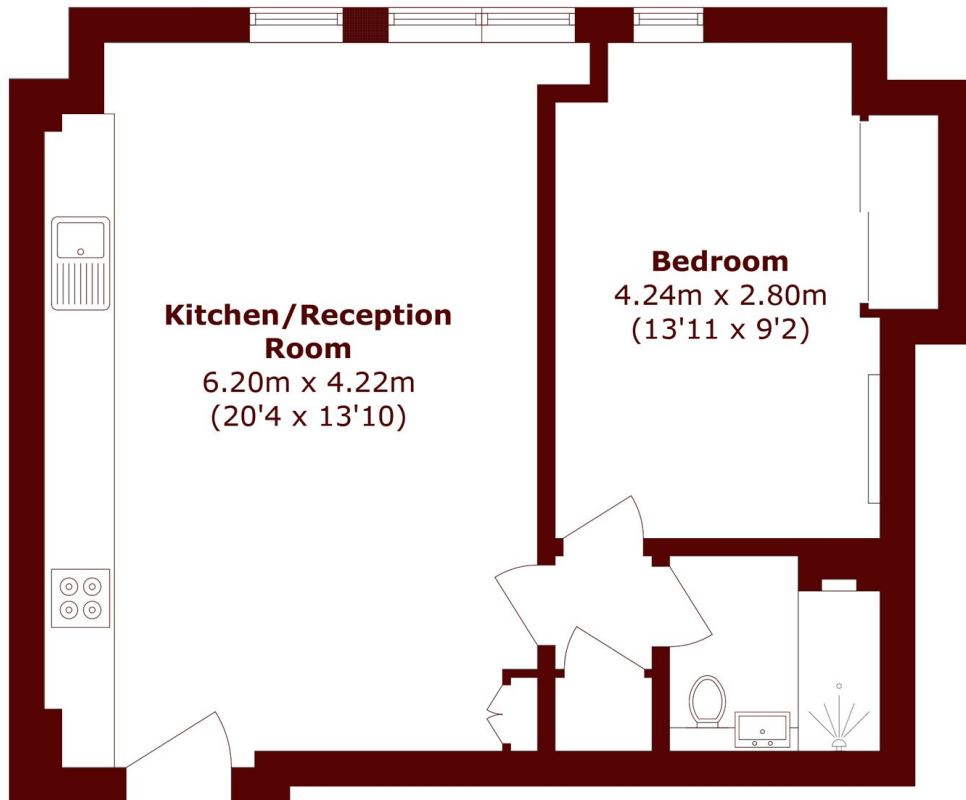

Total area (approx.): 43.9 sq. m (472.5 sq. ft)

## Marsh & Parsons Chiswick

34-38 Turnham Green  
Terrace, London, W4 1QP  
020 8994 2556