

FLAGSHIP
SHOREDITCH RETAIL
OPPORTUNITY

151 CURTAIN ROAD
EC2

3,835 SQ FT

BELCOR

CITY FRINGE REAL ESTATE



DESCRIPTION

The property is situated over ground and basement, forming part of this impressive warehouse building. The floors offer open plan character space with original wooden flooring, exposed brickwork and high ceilings.

FLAGSHIP SHOREDITCH RETAIL UNIT WITH 7-DAY TRADE

AMENITIES



7 DAY TRADE



EXCELLENT
TRANSPORT LINKS



GOOD FRONTAGE



EXCELLENT NATURAL LIGHT

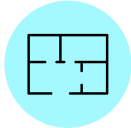

OPEN PLAN



GOOD FOOTFALL



TRANSPORT

Old Street - 8 mins



Shoreditch High Street - 9 mins



Hoxton - 9 mins



Liverpool Street - 13 mins



AREA

The premises are located in the heart of Shoreditch's most trendy area, close to the junction with Old Street roundabout, as well as being close to Redchurch Street. Nearby occupiers include; Free People Club Monaco, Sunspel and SneakersnStuff.

LOCATION

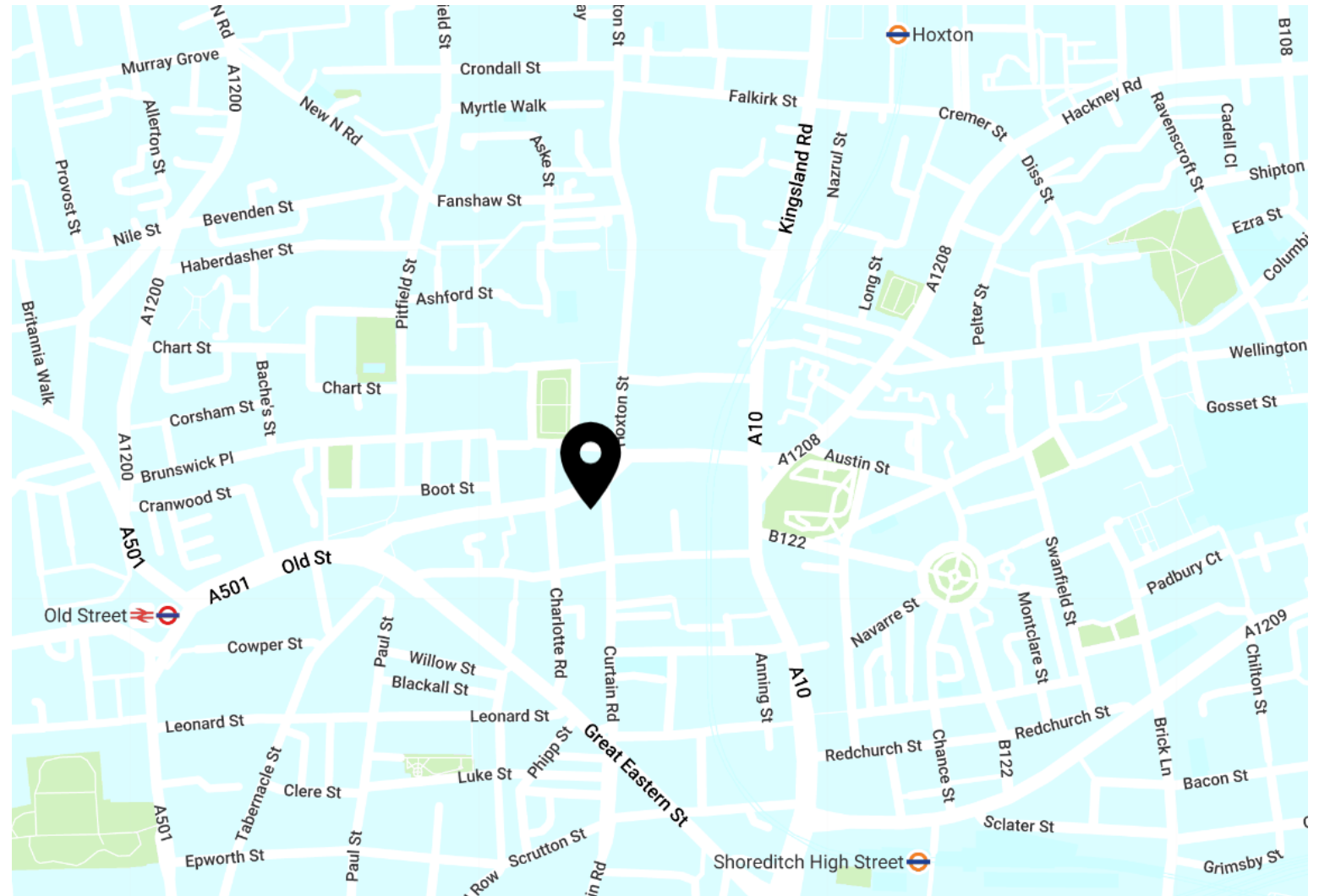

AVAILABILITY

UNIT	SIZE (SQ FT)	STATUS	RENT (PA)	RATES (PSF)	SERVICE CHARGE (PSF)
Ground	1,915				
Basement	1,920				
Total	3,835	Available	£135,000	TBC	TBC

LEASE

A new lease to be contracted outside the Landlord & Tenant Act

TIMING

Available May 2024.

CONTENT

View on our website



RATES

The rates given are a guide and Interested parties should make their own enquiries with the local authority.

VAT

VAT is applicable.

VIEWINGS VIA SOLE AGENTS

BELCOR

020 7375 3444
agency@belcor.london
www.belcor.london

TEAM

OLI COHEN PARTNER



oc@belcor.london
07740 110 063

JAMES DOFFMAN AGENCY



jd@belcor.london
07854 823 137

020 7375 3444
www.belcor.london

