



Parkhill Road, Belsize Park, NW3 2XY

£800,000

A first floor apartment providing three double bedrooms, within walking distance of Hampstead Heath. The property is bright and the accommodation within is well planned, and there is the benefit of a private entrance from the first floor. South End Green is nearby, along with the shops at Haverstock Hill and Belsize Park station.

- THREE DOUBLE BEDROOMS
- CLOISE TO HAMPSTEAD HEATH
- LARGE KITCHEN/DINER
- LEASEHOLD - 87 YEARS REMAINING (CAMDEN FREEHOLD)
- BATHROOM
- ANNUAL SERVICE CHARGE £1200 APPROX.
- RECEPTION ROOM
- EPC D
- PRIVATE ENTRANCE
- COUNCIL TAX BAND F



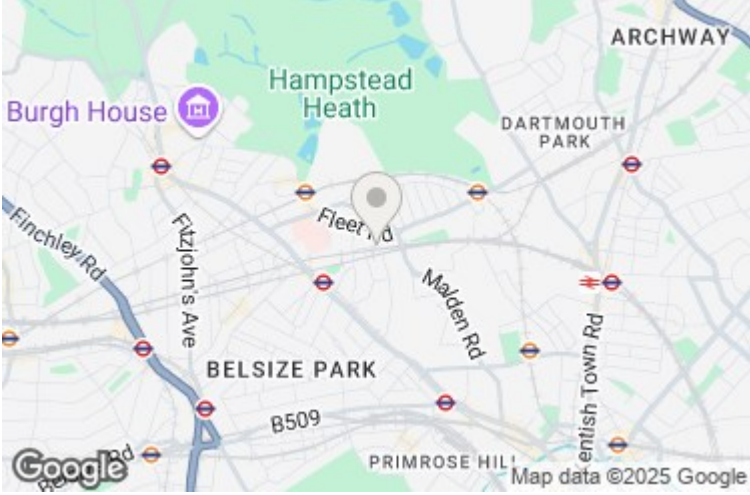

Parkhill Road, NW3 2XY

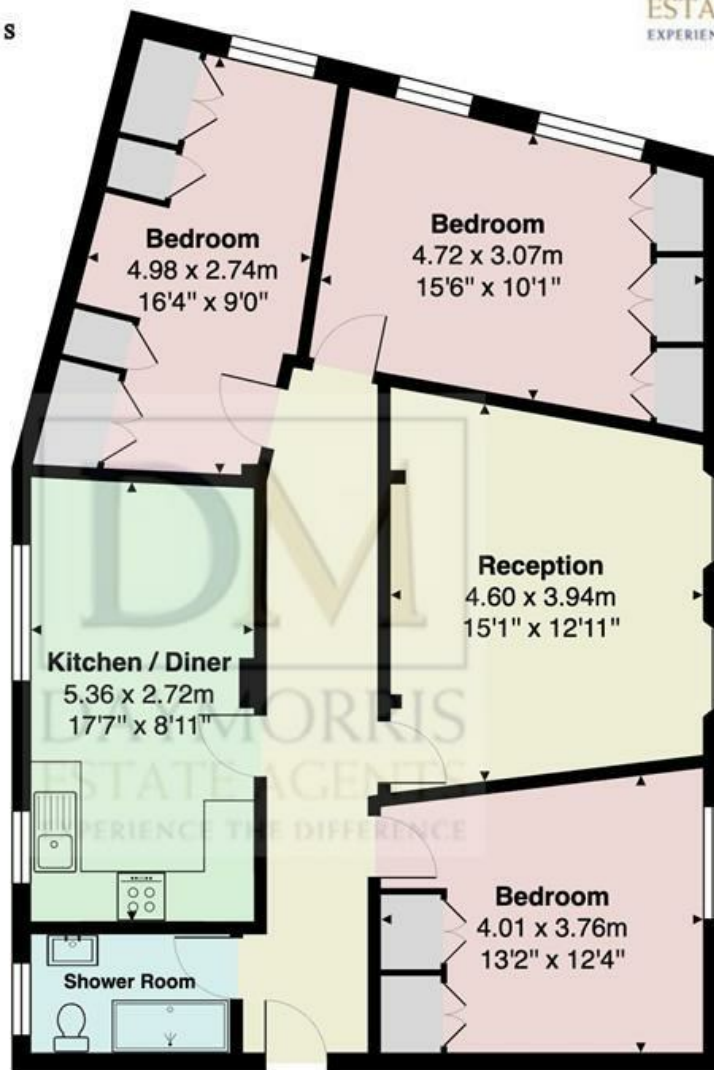

First Floor

Total Area: 92.3 m² ... 993 ft²

All measurements are approximate and for display purposes only.

These details are subject to contract

Energy Efficiency Rating

	Current	Potential
Very energy efficient - lower running costs		
(92 plus) A		
(81-91) B		
(69-80) C		
(55-68) D		
(39-54) E		
(21-38) F		
(1-20) G		
Not energy efficient - higher running costs		
	58	79
England & Wales	EU Directive 2002/91/EC	

Environmental Impact (CO₂) Rating

	Current	Potential
Very environmentally friendly - lower CO ₂ emissions		
(92 plus) A		
(81-91) B		
(69-80) C		
(55-68) D		
(39-54) E		
(21-38) F		
(1-20) G		
Not environmentally friendly - higher CO ₂ emissions		
England & Wales	EU Directive 2002/91/EC	