

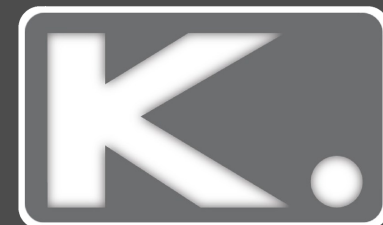

**3 Bed
House - Terraced
located in Hove**

Asking Price £575,000

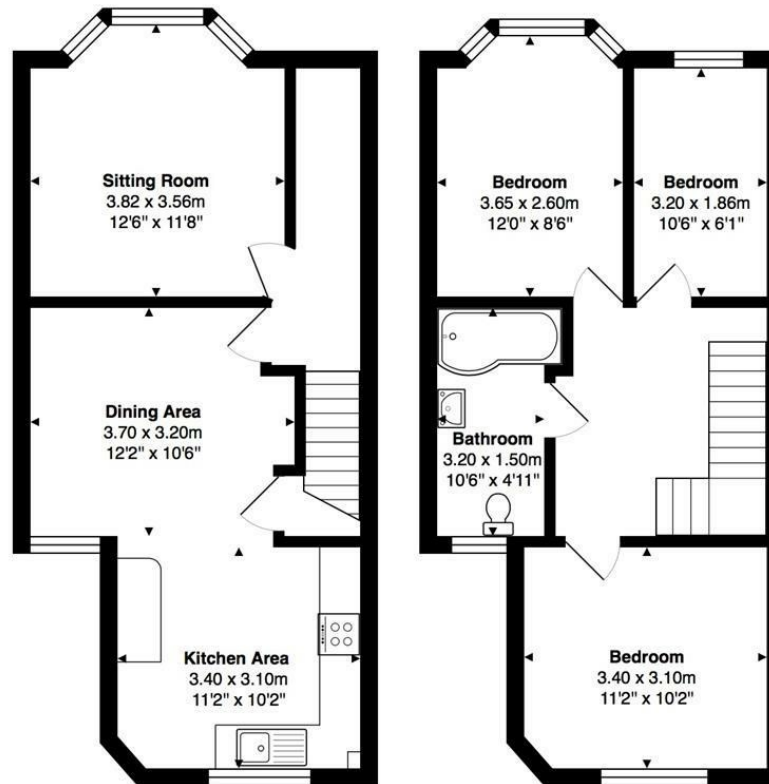



Ground Floor
 Area: 42.4 m² ... 457 ft²

First Floor
 Area: 42.0 m² ... 452 ft²

Total Area: 84.5 m² ... 909 ft²

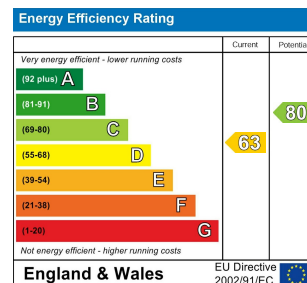

DIRECTIONS

CONTACT

Kendrick Property Services - Brighton
 10-12 Lewes Road
 Brighton
 East Sussex
 BN2 3HP

E:
sales@kendrickpropertyservices.co.uk
 T: 01273 600162
www.kendrickpropertyservices.co.uk

