

NORTH LANE

---

PORTSLADE



54



## KENDRICK PROPERTY SERVICES



***Kendrick Property Services are delighted to bring to market this charming property located on North Lane in the picturesque area of Portslade. This delightful home boasts 2 spacious double bedrooms, perfect for a family or professionals looking for extra space. Situated in the sought-after Mile Oak area of Portslade, this property offers easy access to the vibrant city of Brighton. With the convenience of a Brighton bus route nearby (including new 1X route), commuting and exploring the city couldn't be easier. Step inside to discover a modern open plan kitchen living room, complete with bi-fold doors that flood the space with natural light. The seamless flow between the kitchen and living area creates a welcoming atmosphere, ideal for entertaining guests or simply relaxing after a long day. This property is in superb condition, ready for you to move in and make it your own. Don't miss out on the opportunity to own a piece of this thriving community in Portslade. Contact us today to arrange a viewing and experience the charm of this lovely home for yourself.***







KENDRICK PROPERTY SERVICES



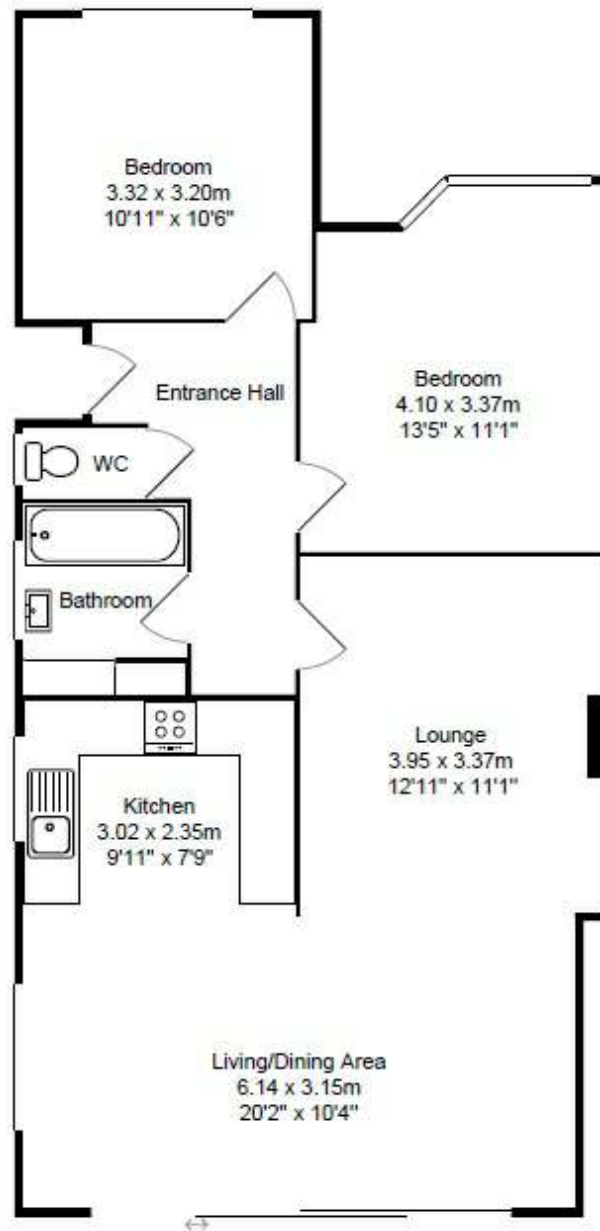

54 North Lane . BN41 2HG

Total Area: 78.0 m<sup>2</sup> ... 839 ft<sup>2</sup>

All measurements are approximate and for display purposes only.



10 - 12 Lewes Road, Brighton, BN2 3HP

01273 600162

[sales@kendrickpropertyservices.co.uk](mailto:sales@kendrickpropertyservices.co.uk)



*A. These sales and particulars do not constitute any part of an offer of contract, and are for the guidance of prospective purchasers only and should not be relied on as statements of fact.*

*B. No representations are made in these particulars as to the condition of the property or as to whether any service or facilities are in good working order.*

*C. All measurements are approximate.*