

Bampfylde House, Black Torrington, Beaworthy, EX21

Approximate Area = 5471 sq ft / 508.2 sq m
Garage = 201 sq ft / 18.6 sq m
Outbuilding = 266 sq ft / 24.7 sq m
Total = 5938 sq ft / 551.5 sq m
For identification only - Not to scale

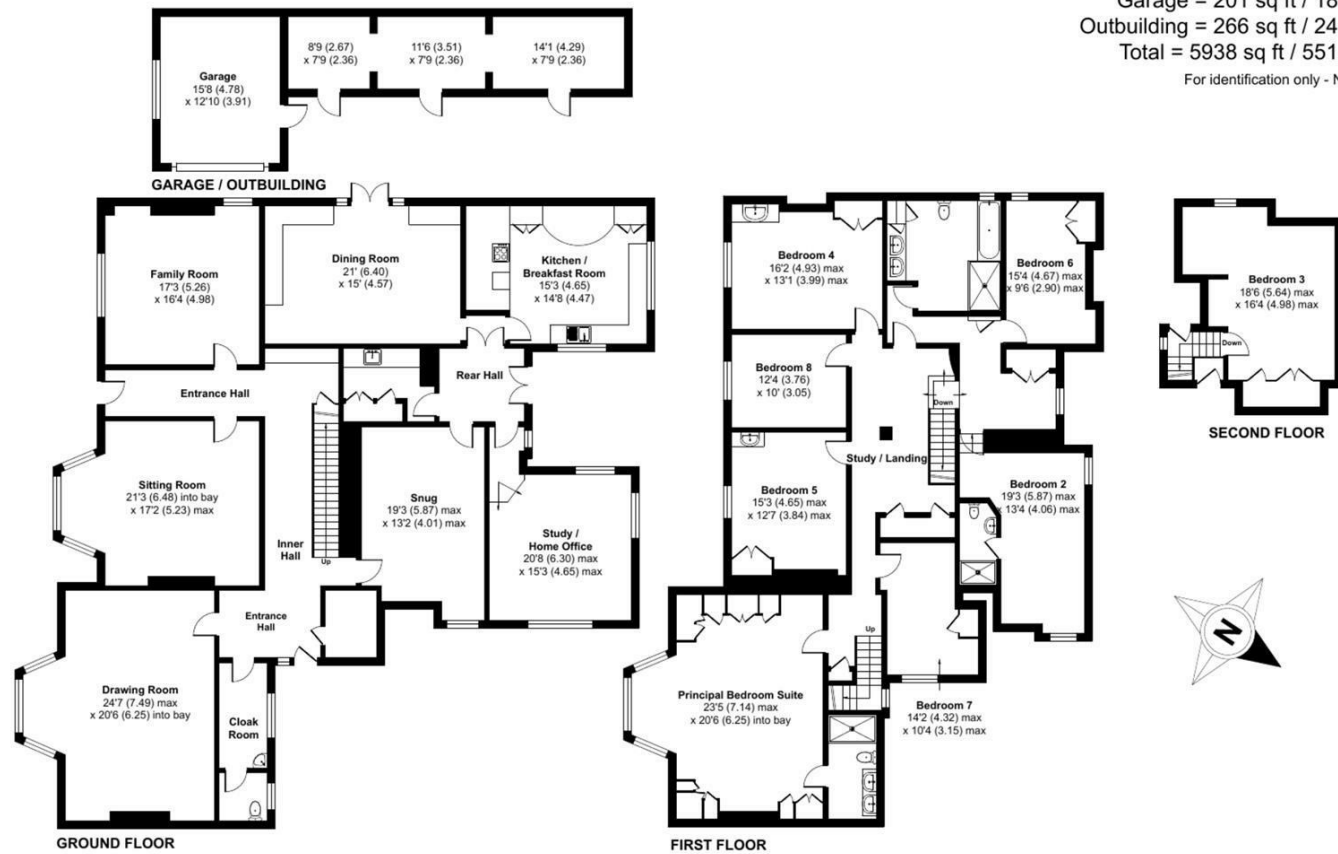

Directions

Looking to sell? Let us value your property for free!

Call 01271 327878
or email barnstaple@phillipsland.com

8 Bed Character Property

Bampfylde House Black Torrington, Beaworthy, EX21 5PU

£1,200,000

These particulars are believed to be correct but their accuracy is not guaranteed. They do not form part of a contract.
Copyright 2016 Phillips Smith & Dunn. All rights reserved. Phillips Smith & Dunn is a name of P. S. & D. Limited.
Our company registration number is 04753854 and we are registered in England and Wales.



Room list:

Overview

Black Torrington is bustling with energy with the highly regarded Black River Inn at the heart of the community. There is also a post office, parish church, village hall, Dr's surgery with pharmacy, toddlers play area, playing field and Ofsted rated outstanding village primary school. Independent schooling is nearby at Shebbear College, around 13 minutes away by car.

The village is in a pivotal position within mid-Devon, in the pretty Torrridge Valley and perfectly placed for access to Dartmoor National Park.

The world class beaches in North Devon and Cornwall are within an easy drive for the water sports enthusiast. Wider local amenities can be found in the larger surrounding towns of Holsworthy, Hatherleigh and Oakhampton.

The A30 provides an excellent link to the Cathedral City of Exeter with its airport, mainline station to London and the M5.

Sat Nav:EX 21 5PU and turn down East Street lane at the junction of East Steet and Broad Street ,by the post office.

what3words: unscathed.reliving.congratulations

Services

Type your text here

Council Tax band

EPC Rating

Tenure

Freehold

Viewings

Strictly by appointment with the Phillips, Smith & Dunn Barnstaple branch on 01271 327878



Outside

