





Kempton Legh Road

Knutsford

Recently built luxury home in Legh Rd conservation area. 5,300 sq ft with exquisite design, stunning kitchen, 4-bed suites, mature gardens, private gates, double garage. Ultimate contemporary luxury living!

Council Tax band: H

Tenure: Freehold

EPC Energy Efficiency Rating: B

- Newly built house (2021) with exceptional attention to detail and finished to exacting standards throughout.
- Over 5300 sqft of accommodation in total.
- Stylish interior design with high end fixtures and fittings.
- Impressive kitchen/living/dining space with bespoke hand painted kitchen.
- Four bedroom suites all with en suites.
- Fantastic room proportions throughout.
- Extensive rear lawns with planting, and stone patio.
- Private gated entrance with double garage.



GROUND FLOOR
2720 sq.ft. (252.7 sq.m.) approx.

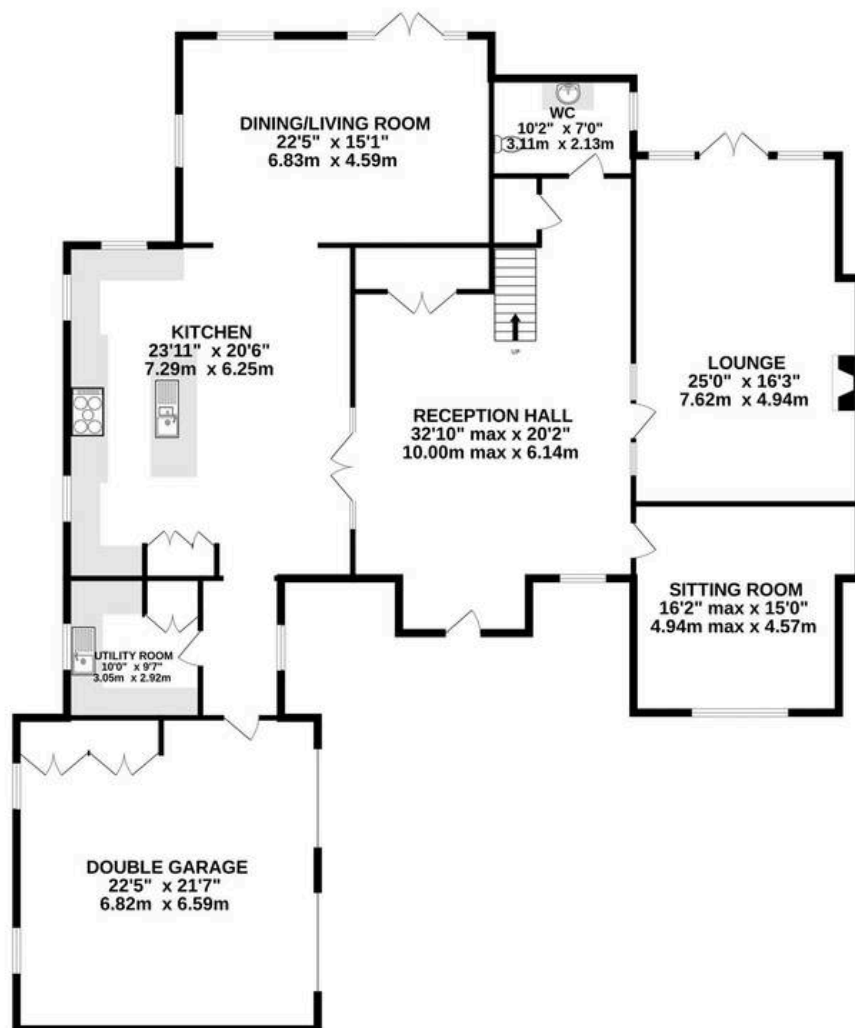

1ST FLOOR
2639 sq.ft. (245.1 sq.m.) approx.



TOTAL FLOOR AREA : 5359 sq.ft. (497.8 sq.m.) approx.

Whilst every attempt has been made to ensure the accuracy of the floorplan contained here, measurements of doors, windows, rooms and any other items are approximate and no responsibility is taken for any error, omission or mis-statement. This plan is for illustrative purposes only and should be used as such by any prospective purchaser. The services, systems and appliances shown have not been tested and no guarantee as to their operability or efficiency can be given.
Made with Metropix ©2023



Stuart Rushton & Company

Stuart Rushton & Co, 35 King Street – WA16 6DW

01565 757000

enquiries@srushton.co.uk

www.srushton.co.uk



We are not authorised to make or give any representations or warranties in relation to the property either here or elsewhere. We assume no responsibility for any statement that may be made in these particulars, and they do not form part of any offer or contract and must not be relied upon as statements or representation of fact. Any areas, measurements or distances are approximate. The text, photographs and plans are for guidance only. Importantly, it should not be assumed that the property has all necessary planning, building regulations or other consents and we have not tested any services, equipment or facilities. Purchasers must satisfy themselves by inspection or otherwise.