





29 St. Johns Road

Knutsford

A wonderful opportunity to buy a beautifully detailed Edwardian Town House situated in the highly desirable St Johns conservation area. This striking property has a wealth of original features and has been kept to a high standard of character and design.

Council Tax band: F

Tenure: Freehold

EPC Energy Efficiency Rating: D

EPC Environmental Impact Rating: D

- Superb Edwardian Town House within the St Johns conservation area
- Four bedrooms, two bathrooms and three reception rooms
- Excellent lower ground family room/home office conversion
- Retaining exquisite original features, character and charm
- Moments walk from the amenities of Knutsford town centre
- Attractive enclosed gardens to the front and the rear



LOWER GROUND FLOOR
274 sq.ft. (25.4 sq.m.) approx.

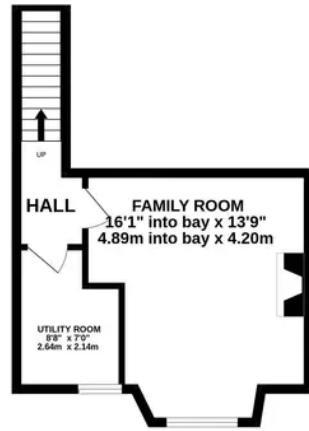

GROUND FLOOR
784 sq.ft. (72.9 sq.m.) approx.



1ST FLOOR
667 sq.ft. (62.0 sq.m.) approx.

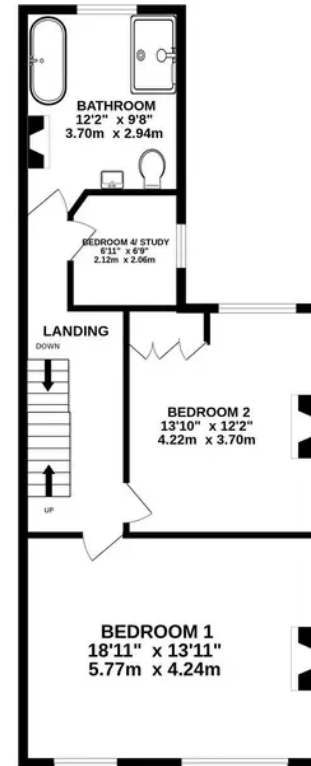

2ND FLOOR
203 sq.ft. (18.8 sq.m.) approx.

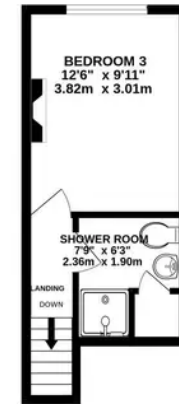

TOTAL FLOOR AREA : 1928 sq.ft. (179.1 sq.m.) approx.

Whilst every attempt has been made to ensure the accuracy of the floorplan contained here, measurements of doors, windows, rooms and any other items are approximate and no responsibility is taken for any error, omission or mis-statement. This plan is for illustrative purposes only and should be used as such by any prospective purchaser. The services, systems and appliances shown have not been tested and no guarantee as to their operability or efficiency can be given.

Made with Metropix ©2023



Stuart Rushton & Company

Stuart Rushton & Co, 35 King Street – WA16 6DW

01565 757000

enquiries@srushton.co.uk

www.srushton.co.uk



We are not authorised to make or give any representations or warranties in relation to the property either here or elsewhere. We assume no responsibility for any statement that may be made in these particulars, and they do not form part of any offer or contract and must not be relied upon as statements or representation of fact. Any areas, measurements or distances are approximate. The text, photographs and plans are for guidance only. Importantly, it should not be assumed that the property has all necessary planning, building regulations or other consents and we have not tested any services, equipment or facilities. Purchasers must satisfy themselves by inspection or otherwise.