



20 Bryndlee Court , Holmfirth, HD9 2TT

A two bedroom first floor apartment in this low density purpose built apartment development on the edge of Holmfirth with balcony. Enjoying level walking access to the heart of Holmfirth and beautiful walks the property is available with no vendor chain. Contemporary and neutral throughout the apartment briefly comprises hallway, open plan lounge, dining room and kitchen, two bedrooms, family bathroom, utility cupboard and storage. Private and visitor parking.
NO VENDOR CHAIN.

£159,950

20 Bryndlee Court

, Holmfirth, HD9 2TT



- TWO BEDROOM FIRST FLOOR APARTMENT
- OPEN PLAN LOUNGE, DINING ROOM AND KITCHEN
- LEVEL WALK TO THE HEART OF HOLMFIRTH AND RIVER WALK
- WALK IN UTILITY CUPBOARD WITH PLUMBING FOR A WASHER
- GAS CENTRAL HEATING AND DOUBLE GLAZING
- NO VENDOR CHAIN

Entrance

Bathroom

6'1" x 5'9" (1.85m x 1.75m)

Master Bedroom

10'9" x 10'0" (3.28m x 3.05m)

Bedroom 2

11'5" x 8'10" (3.48m x 2.69m)

Open Plan Lounge, Dining Room and Kitchen

21'2" x 20'7" (6.45m x 6.27m)

Parking and Grounds



Directions

Located along the Woodhead Road between Holmfirth and Holmbridge.



Floor Plan

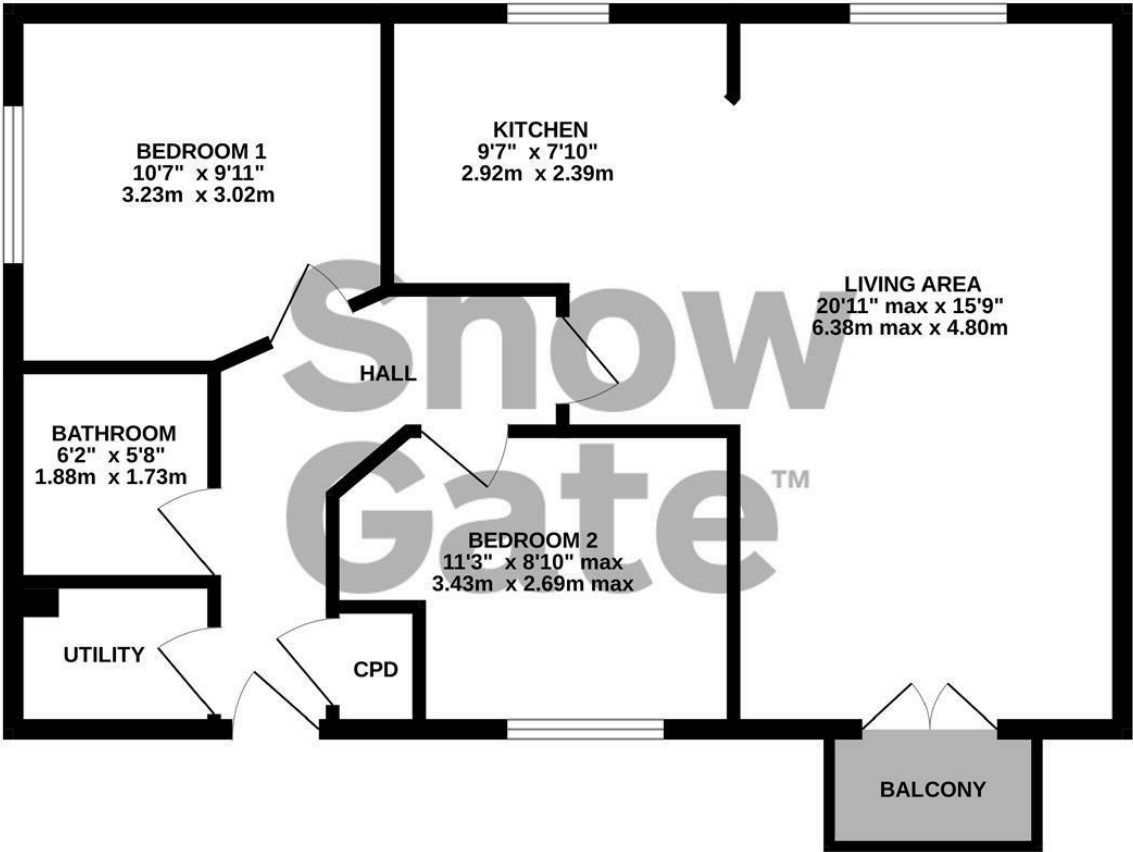

TOTAL FLOOR AREA : 656 sq.ft. (60.9 sq.m.) approx.
Whilst every attempt has been made to ensure the accuracy of the floorplan contained here, measurements of doors, windows, rooms and any other items are approximate and no responsibility is taken for any error, omission or mis-statement. This plan is for illustrative purposes only and should be used as such by any prospective purchaser. The services, systems and appliances shown have not been tested and no guarantee as to their operability or efficiency can be given.
Made with Metropix ©2025

These particulars, whilst believed to be accurate are set out as a general outline only for guidance and do not constitute any part of an offer or contract. Intending purchasers should not rely on them as statements of representation of fact, but must satisfy themselves by inspection or otherwise as to their accuracy. No person in this firms employment has the authority to make or give any representation or warranty in respect of the property.

