



## Plot 1 Spindle Row, off Marsh Lane

Shepley, Huddersfield, HD8 8AS

A four bedroom detached family home at the entrance of this exclusive development in this extremely sought after village. Expected to be ready AUGUST 2026 the property will be built from dyed and tumbled stone with both period and contemporary detailing. Comprises entrance hall way, downstairs wc, utility, lounge and open plan living/dining kitchen. To the first floor are four double bedrooms, master with ensuite and family bathroom. Off road parking, EV point and solar panels.

£500,000

# Plot 1 Spindle Row, off Marsh Lane

Shepley, Huddersfield, HD8 8AS

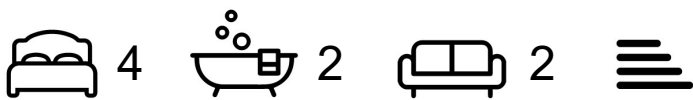

- FOUR BEDROOM DETACHED FAMILY HOME
- HUGE OPEN PLAN LIVING/DINING KITCHEN AND SEPARATE LOUNGE
- DOWNSTAIRS WC AND SEPARATE UTILITY ROOM
- OFF ROAD PARKING AND GARDEN
- APPROXIMATELY 1400 SQUARE FEET
- AVAILABLE AUGUST 2026

## General/Important

Entrance

Cloakroom

Lounge

Utility

Open plan living/dining kitchen

## First Floor Landing

Master Bedroom

Ensuite

Bedroom 2

Bedroom 3

Bedroom 4

## Family Bathroom

Garden and Parking



## Directions

The Orchard is accessed from Marsh Lane and situated slightly further up from the entrance to the cricket club but on the opposite side.





## Floor Plan

## GROUND FLOOR

## 1ST FLOOR

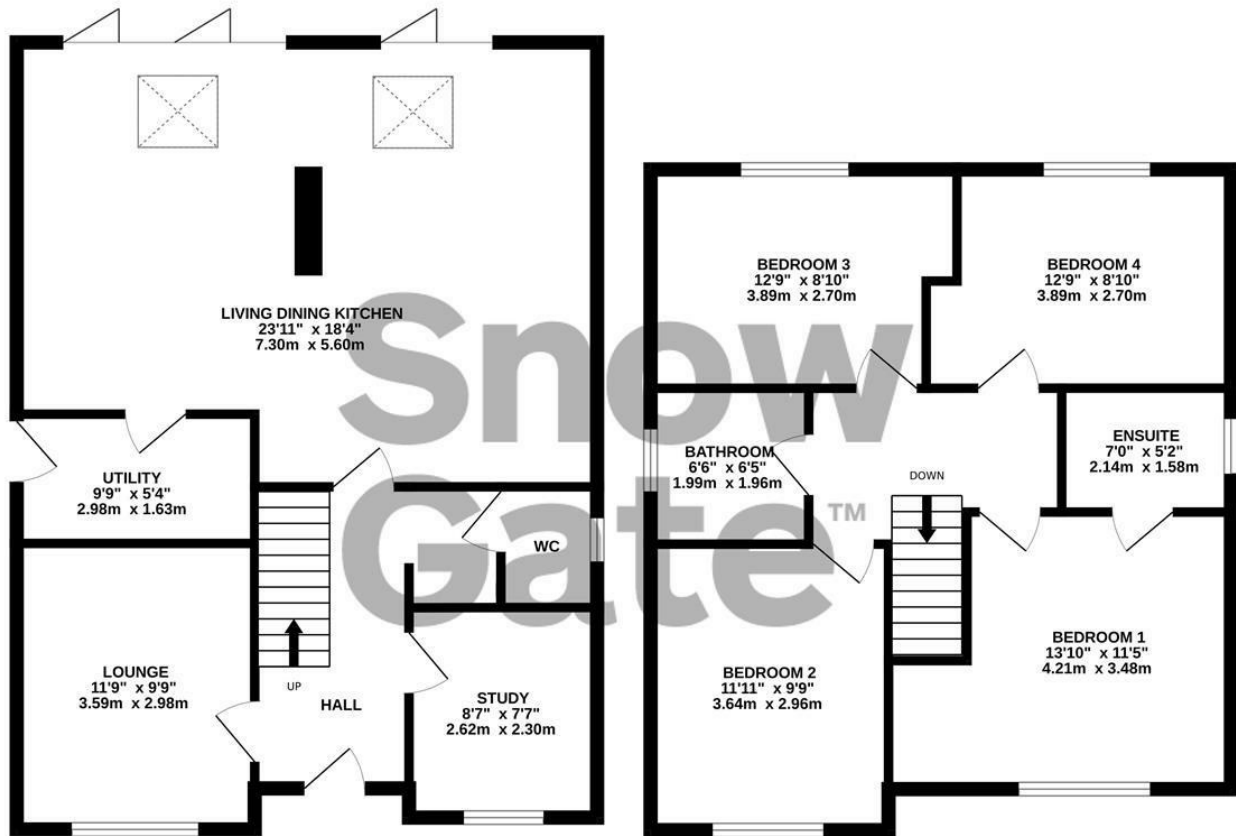

### PLOT 1

Whilst every attempt has been made to ensure the accuracy of the floorplan contained here, measurements of doors, windows, rooms and any other items are approximate and no responsibility is taken for any error, omission or mis-statement. This plan is for illustrative purposes only and should be used as such by any prospective purchaser. The services, systems and appliances shown have not been tested and no guarantee as to their operability or efficiency can be given.

Made with Metropix ©2025

These particulars, whilst believed to be accurate are set out as a general outline only for guidance and do not constitute any part of an offer or contract. Intending purchasers should not rely on them as statements of representation of fact, but must satisfy themselves by inspection or otherwise as to their accuracy. No person in this firms employment has the authority to make or give any representation or warranty in respect of the property.

