

HUNTERS®

HERE TO GET *you* THERE



Portway Road

Twyford, Buckingham, MK18 4EE

£350,000

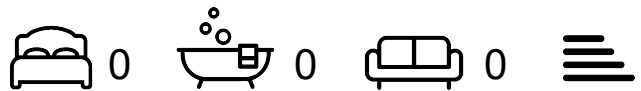

A rare opportunity to acquire two building plots with planning permission granted for two three bedroom, two bathroom detached dwellings on the former site of Elm Cottage.

The plots are a mirror image and both have parking for 2 cars. The vendor advises that the site has a mains water supply to a standpipe and capped pipes at the front of the site ready for connection to mains sewerage.

There are connection points for electricity, Gigaclear fibre broadband and BT in the corner of the plot. Heating will be via air source / underfloor heating. Further working drawings and buildings regulations specifications including SAPs are available upon request.

Twyford local amenities include a community shop, cafe, church, primary school and pub.



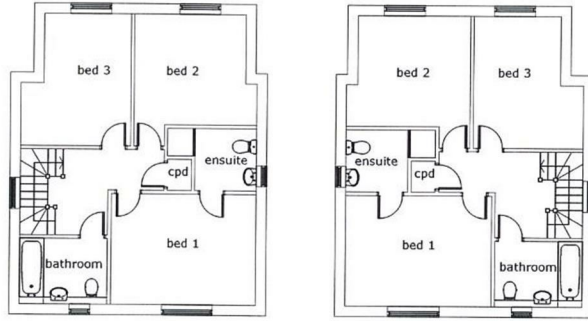

PROPOSED FIRST FLOOR PLAN 1:100

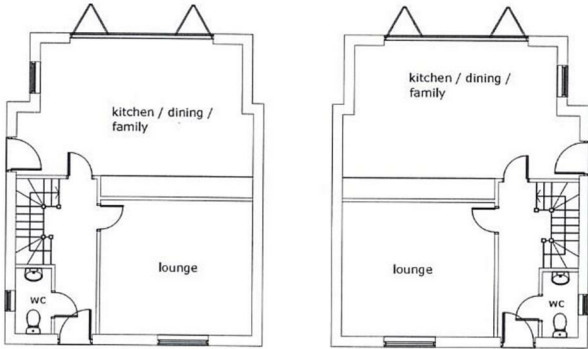

PROPOSED GROUND FLOOR PLAN 1:100

ALL DIMENSIONS, LEVELS AND CLEARANCES TO BE CHECKED ON SITE PRIOR TO WORKS COMMENCING

THIS DRAWING SHOULD BE READ IN CONJUNCTION WITH ALL OTHER PROJECT RELATED DRAWINGS, SPECIFICATIONS AND DOCUMENTS AS PART OF A SINGLE PROJECT PACKAGE.

ANY DISCREPANCY BETWEEN THIS DRAWING, OTHER DRAWINGS FORMING PART OF THIS CONTRACT, OR THE SPECIFICATION / BILLS OF QUANTITIES MUST BE CLARIFIED BEFORE COMMENCEMENT OF ANY WORK OR ORDERING OF ANY MATERIALS.

PLEASE CONSULT THE AUTHOR OR PROJECT MANAGER SHOULD THE READER REQUIRE CLARIFICATION ON ANY PART OF THIS DRAWING.

THE COPYRIGHT OF THE DRAWING AND DESIGN IS THE PROPERTY OF THE COMPANY. THIS INFORMATION HAS BEEN ISSUED UNDER SPECIFIC TERMS FOR THIS PROJECT AND MAY ONLY BE USED AND REPRODUCED ACCORDINGLY.

Rev	Date	By	Chk	Comment

Client:

Project Title:
2 New Dwellings
Elm Cottage, Portway Road
Twyford, Buckinghamshire

Drawing Title:
Floor Plans

Status:
FOR INFORMATION

Drawn By: SC Designed By: - Checked By: - Approved By: -

Original Issue Date: - Scale @ A3: 1:100

Job No/ File Ref: 210926

Drawing Number: 1001 Revision: -

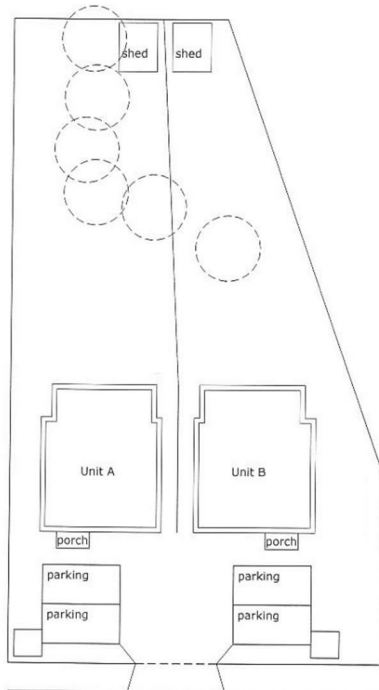

PROPOSED SITE PLAN 1:200

ALL DIMENSIONS, LEVELS AND CLEARANCES TO BE CHECKED ON SITE PRIOR TO WORKS COMMENCING

THIS DRAWING SHOULD BE READ IN CONJUNCTION WITH ALL OTHER PROJECT RELATED DRAWINGS, SPECIFICATIONS AND DOCUMENTS AS PART OF A SINGLE PROJECT PACKAGE.

ANY DISCREPANCY BETWEEN THIS DRAWING, OTHER DRAWINGS FORMING PART OF THIS CONTRACT, OR THE SPECIFICATION / BILLS OF QUANTITIES MUST BE CLARIFIED BEFORE COMMENCEMENT OF ANY WORK OR ORDERING OF ANY MATERIALS.

PLEASE CONSULT THE AUTHOR OR PROJECT MANAGER SHOULD THE READER REQUIRE CLARIFICATION ON ANY PART OF THIS DRAWING.

THE COPYRIGHT OF THE DRAWING AND DESIGN IS THE PROPERTY OF THE COMPANY. THIS INFORMATION HAS BEEN ISSUED UNDER SPECIFIC TERMS FOR THIS PROJECT AND MAY ONLY BE USED AND REPRODUCED ACCORDINGLY.

Rev	Date	By	Chk	Comment

Client:

Project Title:
2 New Dwellings
Elm Cottage, Portway Road
Twyford, Buckinghamshire

Drawing Title:
Site Plan

Status:
FOR INFORMATION

Drawn By: SC Designed By: - Checked By: - Approved By: -

Original Issue Date: - Scale @ A3: 1:200

Job No/ File Ref: 210926

Drawing Number: 1004 Revision: -

These particulars are intended to give a fair and reliable description of the property but no responsibility for any inaccuracy or error can be accepted and do not constitute an offer or contract. We have not tested any services or appliances (including central heating if fitted) referred to in these particulars and the purchasers are advised to satisfy themselves as to the working order and condition. If a property is unoccupied at any time there may be reconnection charges for any switched off/disconnected or drained services or appliances - All measurements are approximate. **THINKING OF SELLING?** If you are thinking of selling your home or just curious to discover the value of your property, Hunters would be pleased to provide free, no obligation sales and marketing advice. Even if your home is outside the area covered by our local offices we can arrange a Market Appraisal through our national network of Hunters estate agents.