

THE HOME AGENCY

'Passion for property'



20 Palmerston Road, Southampton, Hampshire, SO14 1LL

£1,500 PCM

- Three Story Town House
- White Goods
- Gas Central Heating
- Short Term Six Month Let
- Downstairs WC
- Part Furnished
- Close To University
- Large Kitchen
- Off Road Parking
- Available Now

20 Palmerston Road SO14 1LL

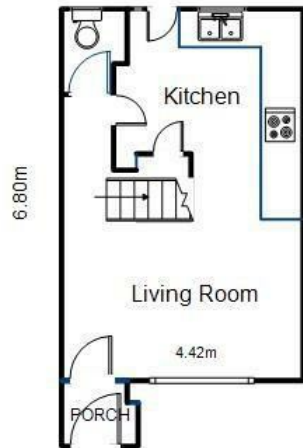

Ground Floor

30.06 m²

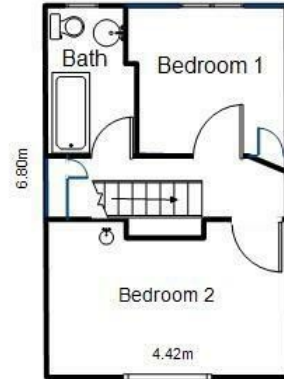

First Floor

30.06 m²



Second Floor

30.06 m²

ALL MEASUREMENTS ARE APPROXIMATE

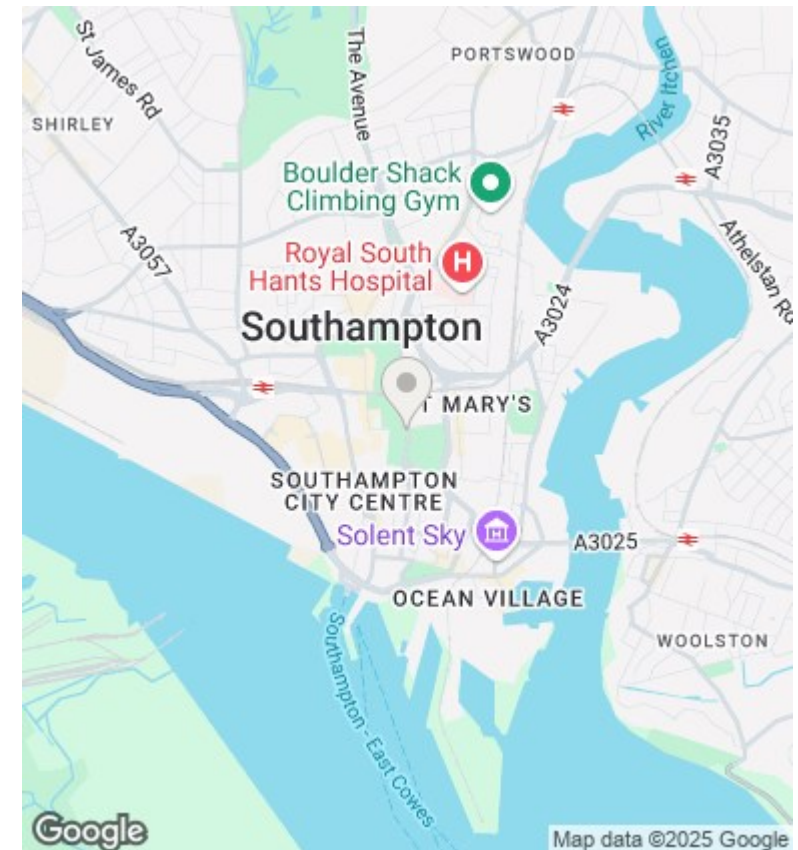

Directions

Viewings

Viewings by arrangement only. Call 02380 632632 to make an appointment.

Council Tax Band

B

EPC Rating:

D

Energy Efficiency Rating		
	Current	Potential
Very energy efficient - lower running costs		
(92 plus) A		87
(81-91) B		
(69-80) C		65
(55-68) D		
(39-54) E		
(21-38) F		
(1-20) G		
Not energy efficient - higher running costs		
England & Wales		EU Directive 2002/91/EC