

THE HOME AGENCY

'Passion for property'



86 Downs Park Crescent, Eling, Totton, Hampshire, SO40 9GP

£1,150 PCM

- End Terraced House
- Two Double Bedrooms
- White Goods
- Pets Considered
- Double Glazing
- Garden
- Modern Shower Room
- Gas Central Heating
- Conservatory
- Downstairs WC

11 London Road, Southampton, Hampshire, SO15 2AE
02380 632632

enquiries@thehomeagency.net
<https://thehomeagency.net>

86 Downs Park Crescent SO40 9GP

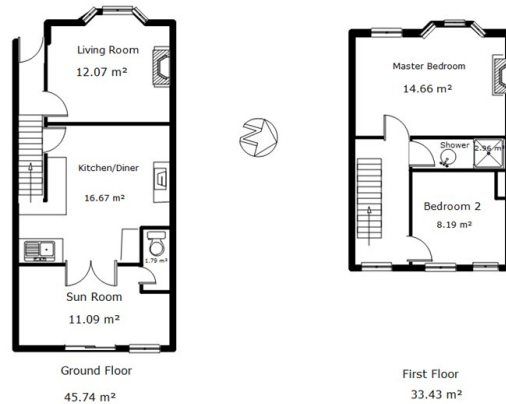

ALL MEASUREMENTS ARE APPROXIMATE

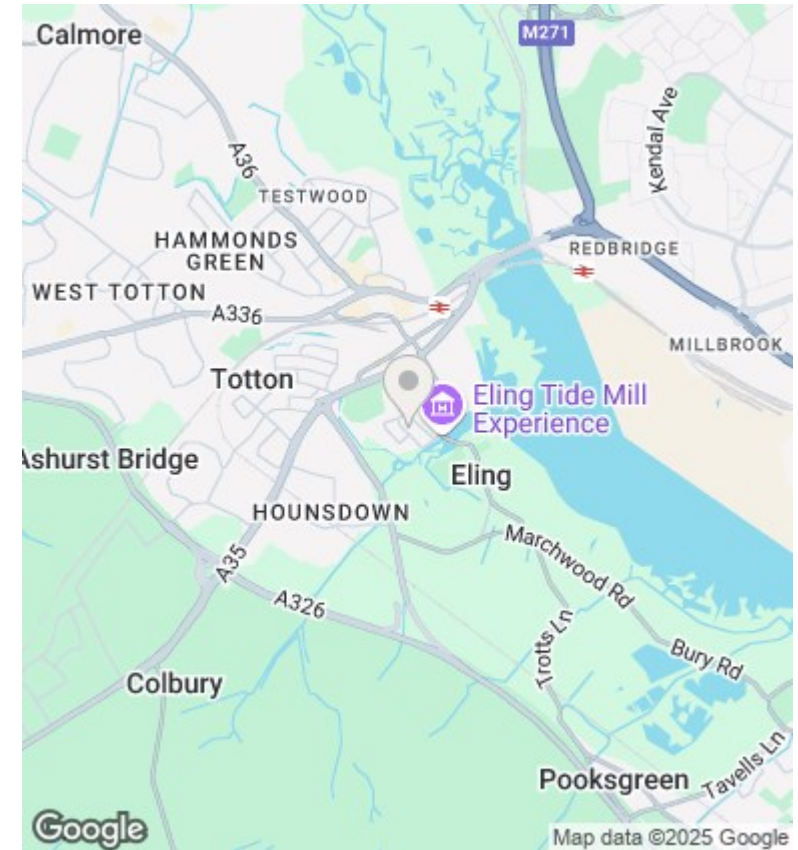

Directions

Viewings

Viewings by arrangement only. Call 02380 632632 to make an appointment.

Council Tax Band

C

EPC Rating:

D

Energy Efficiency Rating		
	Current	Potential
Very energy efficient - lower running costs		
(92 plus) A		
(81-91) B		80
(69-80) C		
(55-68) D	55	
(39-54) E		
(21-38) F		
(1-20) G		
Not energy efficient - higher running costs		
England & Wales		EU Directive 2002/91/EC