

# THE HOME AGENCY

*'Passion for property'*



## 6 Royston Avenue, Eastleigh, SO50 4NJ

Asking Price £449,950

- Three double bedrooms
- Two additional bedrooms
- Downstairs W.C
- No forward chain
- Extended to ground floor
- Detached garage with electric door and pit
- Beautiful kitchen diner
- Master bedroom with en suite
- Ample parking
- Large Lounge Diner



6 Royston Avenue SO50 4NJ

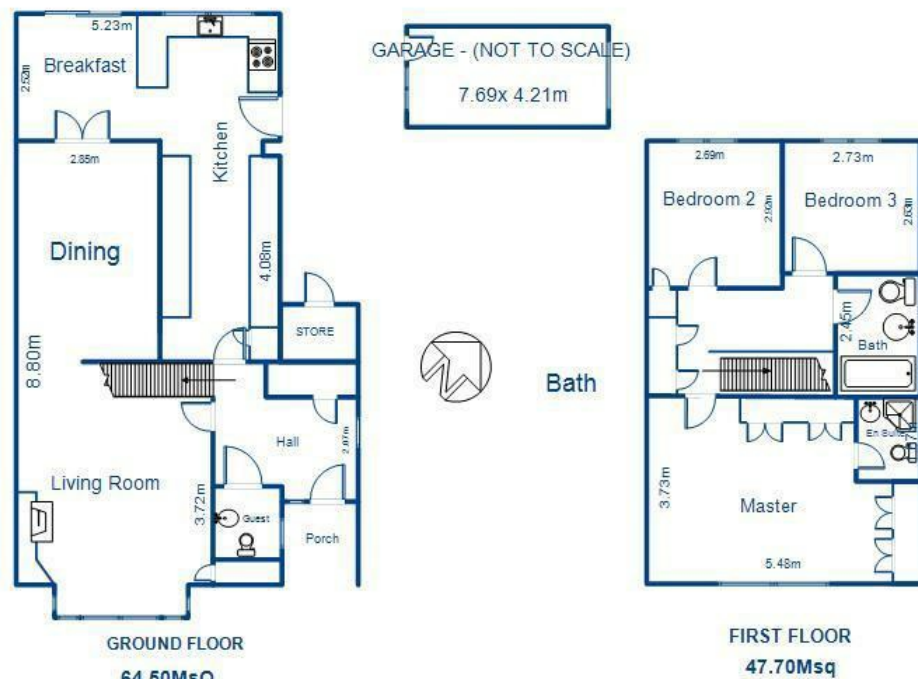

ALL MEASUREMENTS ARE APPROXIMATE

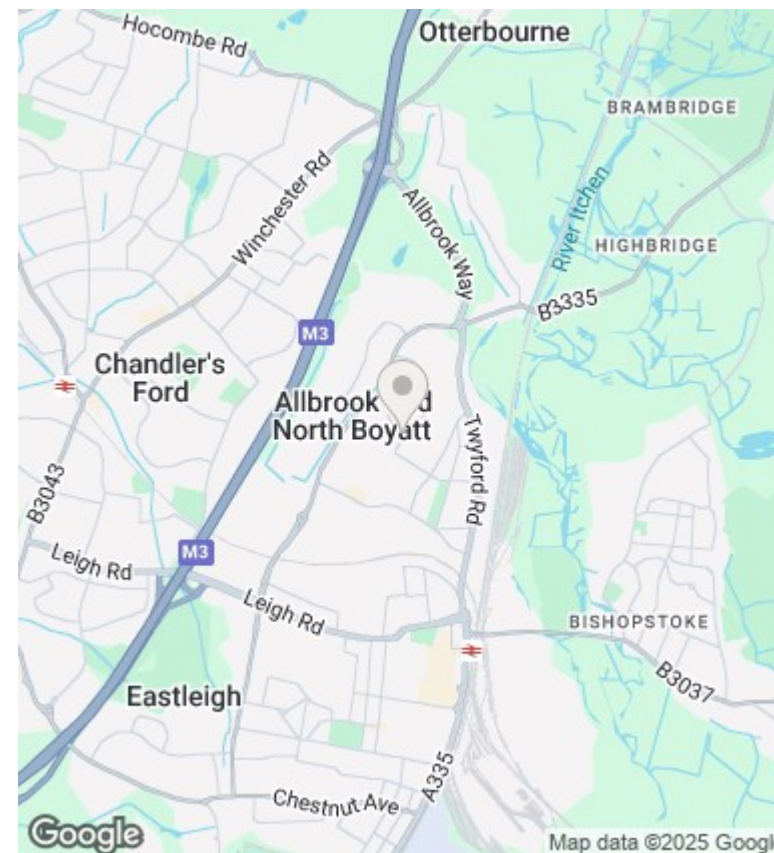

## Directions

## Viewings

Viewings by arrangement only. Call 02380 632632 to make an appointment.

## Council Tax Band

B

## EPC Rating:

C

Energy Efficiency Rating		
	Current	Potential
Very energy efficient - lower running costs		
(92-plus) <b>A</b>		
(81-91) <b>B</b>		85
(69-80) <b>C</b>	69	
(55-68) <b>D</b>		
(39-54) <b>E</b>		
(21-38) <b>F</b>		
(1-20) <b>G</b>		
Not energy efficient - higher running costs		
England & Wales		EU Directive 2002/91/EC