

THE HOME AGENCY

'Passion for property'



6 Royston Avenue, Eastleigh, SO50 4NJ

Asking Price £460,000

- Three double bedrooms
- Two additional bedrooms
- Downstairs W.C
- No forward chain
- Extended to ground floor
- Detached garage with electric door and pit
- Beautiful kitchen diner
- Master bedroom with en suite
- Ample parking
- Large Lounge Diner

6 Royston Avenue SO50 4NJ

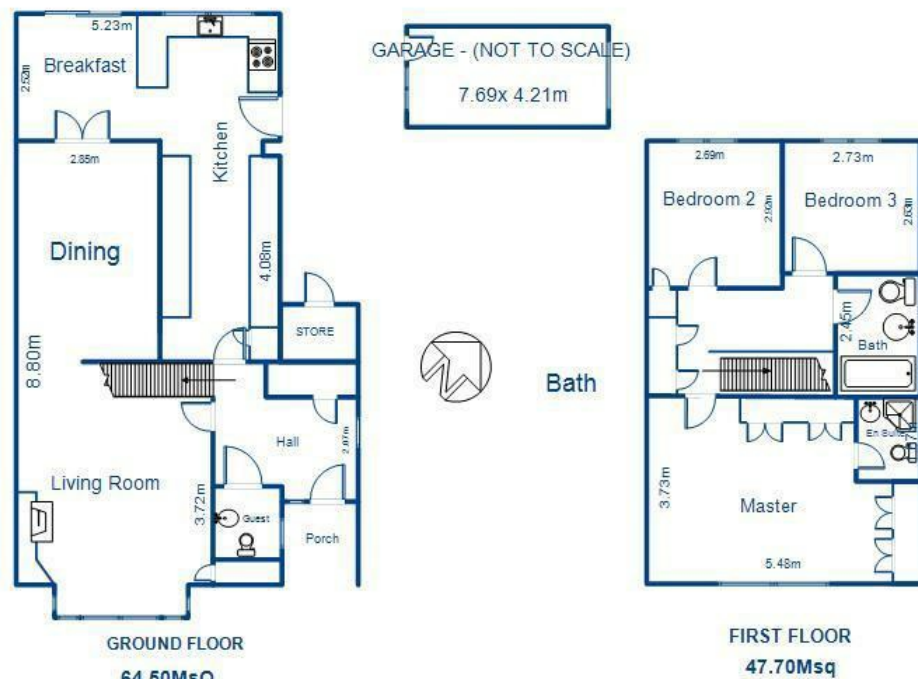

ALL MEASUREMENTS ARE APPROXIMATE

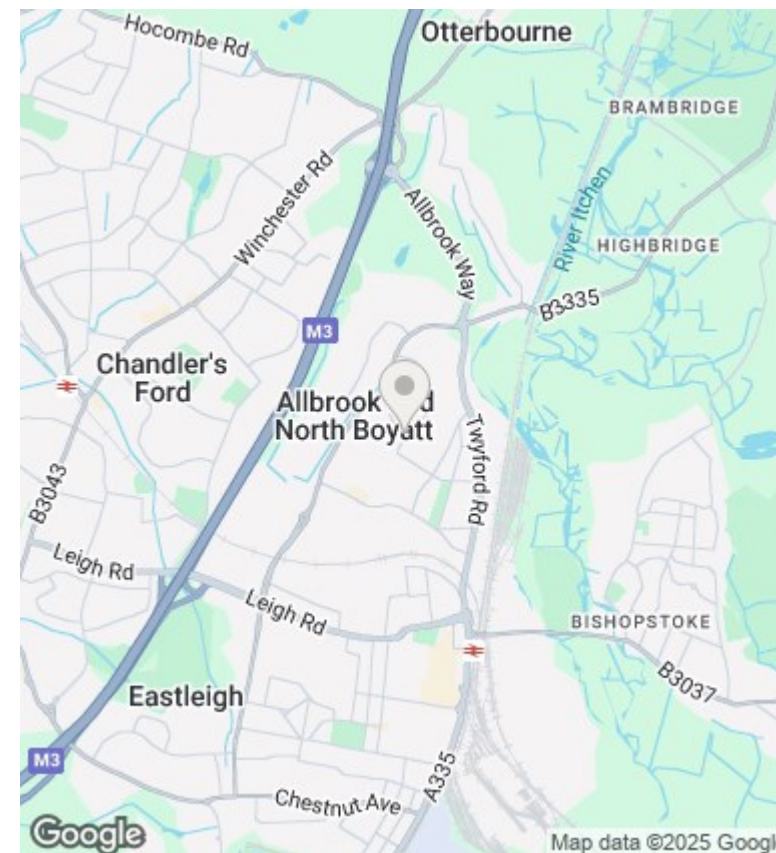

Directions

Viewings

Viewings by arrangement only. Call 02380 632632 to make an appointment.

Council Tax Band

B

EPC Rating:

C

Energy Efficiency Rating		
	Current	Potential
Very energy efficient - lower running costs		
(92 plus) A		85
(81-91) B		
(69-80) C	69	
(55-68) D		
(39-54) E		
(21-38) F		
(1-20) G		
Not energy efficient - higher running costs		
England & Wales		EU Directive 2002/91/EC