

THE HOME AGENCY

'Passion for property.'



Bridge House Chilworth Drive, Chilworth, Southampton, Hampshire,

£4,750 Per Month

- Four bedroom main residence
- High specification
- Annex never used
- Available know
- Three Bedroom secondary residence
- Nearly new finish
- Under floor heating
- Sought after location
- Seven bathrooms in total
- Viewing a must



Ground Floor
Floor area 84.3 sq.m. (907 sq.ft.) approx



First Floor
Floor area 99.6 sq.m. (1,072 sq.ft.) approx

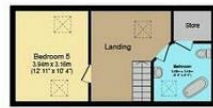

Second Floor
Floor area 33.1 sq.m. (356 sq.ft.) approx



Annex Ground Floor
Floor area 107.4 sq.m. (1,156 sq.ft.) approx



Annexn First Floor
Floor area 78.8 sq.m. (848 sq.ft.) approx

Total floor area 403.1 sq.m. (4,339 sq.ft.) approx

This Floor Plan is for illustration purposes only and may not be representative of the property. The position and size of doors, windows and other features are approximate. Unauthorized reproduction prohibited. © PropertyBOX



Directions

Viewings

Viewings by arrangement only. Call 02380 632632 to make an appointment.

Council Tax Band

B

EPC Rating:

C

Energy Efficiency Rating		Current	Potential
Very energy efficient - lower running costs			
(92 plus)	A		
(81-91)	B		
(69-80)	C		
(55-68)	D		
(39-54)	E		
(21-38)	F		
(1-20)	G		
Not energy efficient - higher running costs			
England & Wales		EU Directive 2002/91/EC	