



Ashley Drive

Borehamwood, WD6 2JB

£450,000 Freehold

A well presented and rarely available, extended two bedroom semi detached house situated on the Southside of Borehamwood. The home comprises of a lounge and kitchen diner to the ground floor with two double bedrooms and shower room to the first. There is parking for several vehicles to the front of the home and the rear garden is well tended and mainly laid to lawn.

- Two Bedroom Semi
- Extended
- Off Street Parking
- Lovely Garden
- Modern Shower Room
- Chain Free

Viewing

Please contact our Carrington Estate Agents Office on 02089531818 if you wish to arrange a viewing appointment for this property or require further information.



Floor Plan

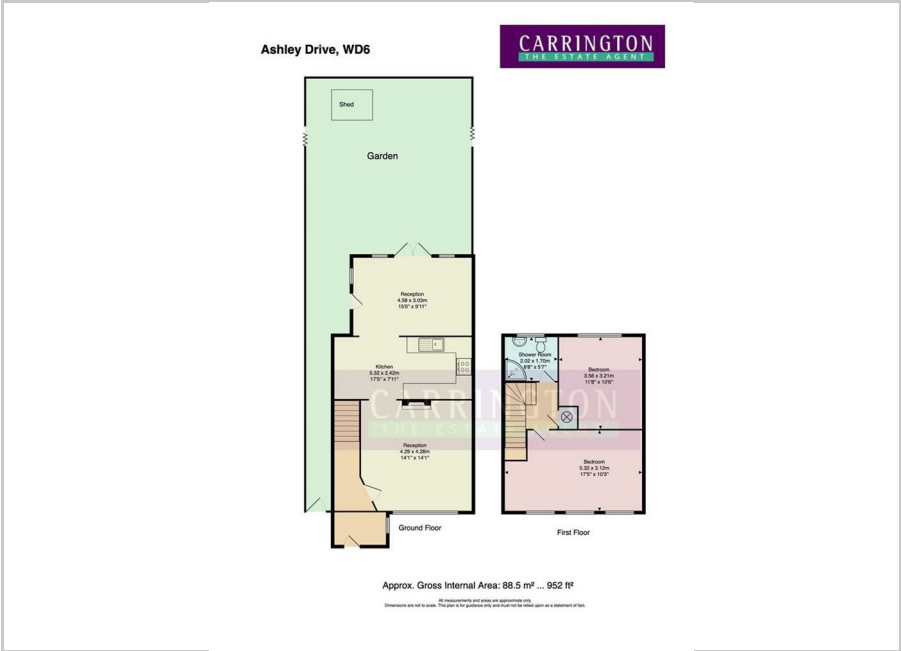

Area Map



Energy Efficiency Graph

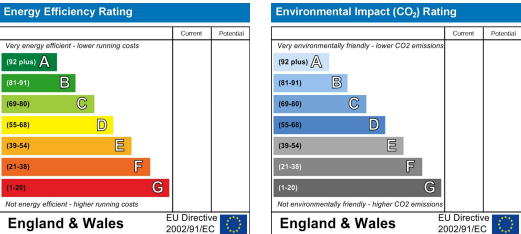

These particulars, whilst believed to be accurate are set out as a general outline only for guidance and do not constitute any part of an offer or contract. Intending purchasers should not rely on them as statements of representation of fact, but must satisfy themselves by inspection or otherwise as to their accuracy. No person in this firm's employment has the authority to make or give any representation or warranty in respect of the property.

138 Shenley Road, Borehamwood, Hertfordshire WD6 1EF
Tel: 020 8953 1818 Fax: 020 8953 0808

Email: info@carrington-borehamwood.co.uk Website: www.carrington-borehamwood.co.uk



COMPANY DIRECTOR: E. A. HUSSAIN
REGISTERED ADDRESS: 1 WARNER HOUSE, HARROVIAN BUSINESS VILLAGE,
BESSBOROUGH ROAD, HARROW, MIDD., HA1 3EX.
COMPANY REGISTRATION No: 09830132