



## Lemsford Court

Borehamwood, WD6 2LG

**£425,000 Freehold**

This delightful two bedroom end-terrace house sits within a quiet 'Southside' cul-de-sac moments from 'Yavneh College'. This spacious home includes both gas central heating and double glazing. There is also a fitted kitchen/diner that leads directly to a wonderful landscaped rear garden. The first floor comprises of two spacious bedrooms and a fully tiled family bathroom. An internal inspection is highly recommended. Please contact Carrington to arrange a mutually convenient appointment.

- Two Bedrooms
- End-Terrace
- Southside Location
- Gas Central Heating
- Double Glazing
- Off Street Parking

### Viewing

Please contact our Carrington Estate Agents Office on 02089531818 if you wish to arrange a viewing appointment for this property or require further information.





# Floor Plan

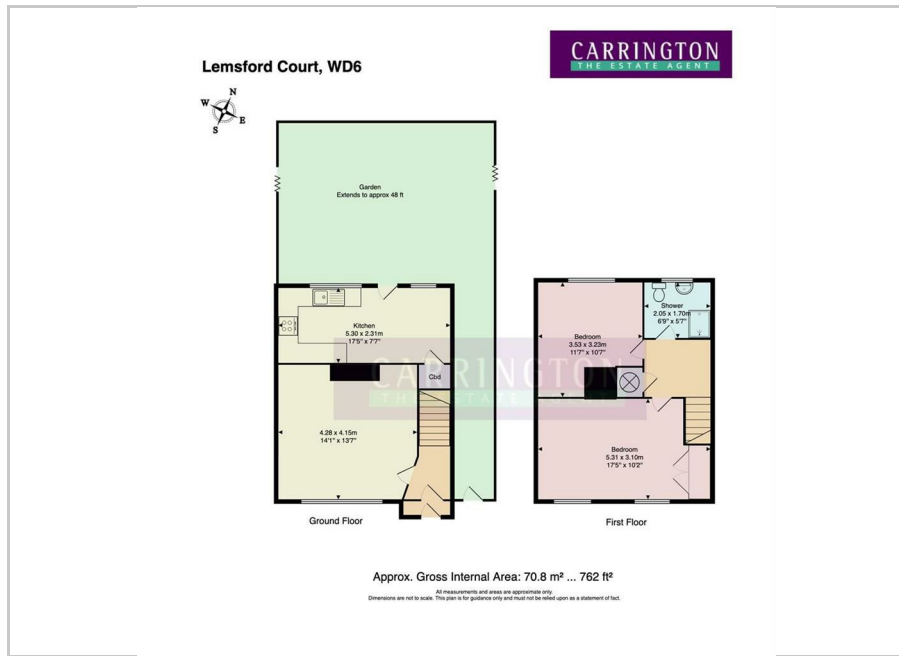

# Area Map

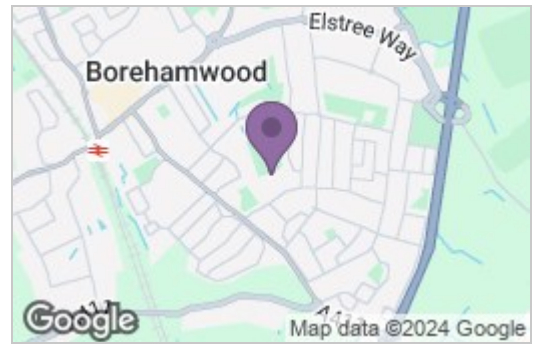

# Energy Efficiency Graph

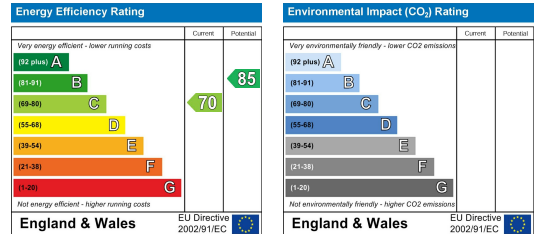

These particulars, whilst believed to be accurate are set out as a general outline only for guidance and do not constitute any part of an offer or contract. Intending purchasers should not rely on them as statements of representation of fact, but must satisfy themselves by inspection or otherwise as to their accuracy. No person in this firm's employment has the authority to make or give any representation or warranty in respect of the property.

138 Shenley Road, Borehamwood, Hertfordshire WD6 1EF  
Tel: 020 8953 1818 Fax: 020 8953 0808

Email: [info@carrington-borehamwood.co.uk](mailto:info@carrington-borehamwood.co.uk) Website: [www.carrington-borehamwood.co.uk](http://www.carrington-borehamwood.co.uk)



COMPANY DIRECTOR: E. A. HUSSAIN  
REGISTERED ADDRESS: 1 WARNER HOUSE, HARROVIAN BUSINESS VILLAGE,  
BESSBOROUGH ROAD, HARROW, MIDD., HA1 3EX.  
COMPANY REGISTRATION No: 09830132