

A three-story stone house with a bay window and a chimney. The house is made of dark stone with light-colored window frames. The bay window is on the left side of the house. The chimney is on the right side of the house. The house is set against a blue sky with some clouds.

Buy your next home with Next Home

Leading Perthshire Estate Agency

11a Addison Terrace, Crieff, PH7 3AT

Offers Over £69,950

■■■■
NEXTHOME
ESTATE & LETTING AGENTS

Buying with Next Home

11a Addison Terrace, Crieff, PH7 3AT

Many thanks for your interest with 11a Addison Terrace, Crieff, PH7 3AT.

Next Home Estate Agents dedicate themselves to be available when you are, offering an unbeatable service 7 days a week until 9pm.

We have the largest sales team in Perthshire, operating from our 5 offices throughout Perthshire and delivering more sales than any other estate agent.

Not only are we Perthshire's Number 1 choice but we are also local. One of the reasons we know the local markets so well is because we live here. So let us guide you through the selling and buying process.

If you're a first time buyer we have incentives to help get you onto the property ladder - our consultants can advise you through the whole process.

We offer free, no obligation mortgage advice to all our buyers.

If you have a property to sell, contact us to arrange a valuation. We are renowned in getting our customers moving quicker and at a higher price than our competitors. Put us to the test and get your free valuation today, call 01738 444342.

If you would like to be kept informed of other great properties like this one please register on our hot buyers list, where we will email you of new property listings and property open days.

About the Area

The vibrant town of Crieff offers a wide range of shops and visitor attractions including Crieff Visitor Centre and Glenturret Distillery.

Crieff is positioned on the edge of the Scottish Highlands therefore the beautiful countryside can be found not far away from the town centre.

There are primary and secondary schools within the town including the reputable Morrisons Academy and public transport is regular and close to hand.



Property Summary

A rare opportunity to purchase this GROUND FLOOR ONE BEDROOM APARTMENT situated within a popular residential area in the town of Crieff.

The accommodation comprises entrance hall; spacious lounge with gas fire, recessed alcove with display shelving and front facing windows; dining kitchen with cooker, fridge/freezer and washing machine together with space for formal dining; double bedroom and bathroom with shower over the bath.

There is double glazing and gas central heating throughout.

Externally there is an area of garden pertaining to the property, a shared secure cellar and parking is available on street to the front.

There are lovely views from the property to the rear over the town.

Early viewing is highly recommended.



Key property features

- ✓ Ground floor apartment
- ✓ Spacious Lounge
- ✓ Dining Kitchen
- ✓ Double Bedroom
- ✓ Bathroom with shower over the bath
- ✓ Double Glazing
- ✓ Gas Central Heating
- ✓ Garden
- ✓ Lovely views to the rear
- ✓ Central Location







Have a property to sell?

An expert from our local branch will provide you with the most accurate valuation.

%epcGraph_c_1_365%



Floorplans

Ground Floor

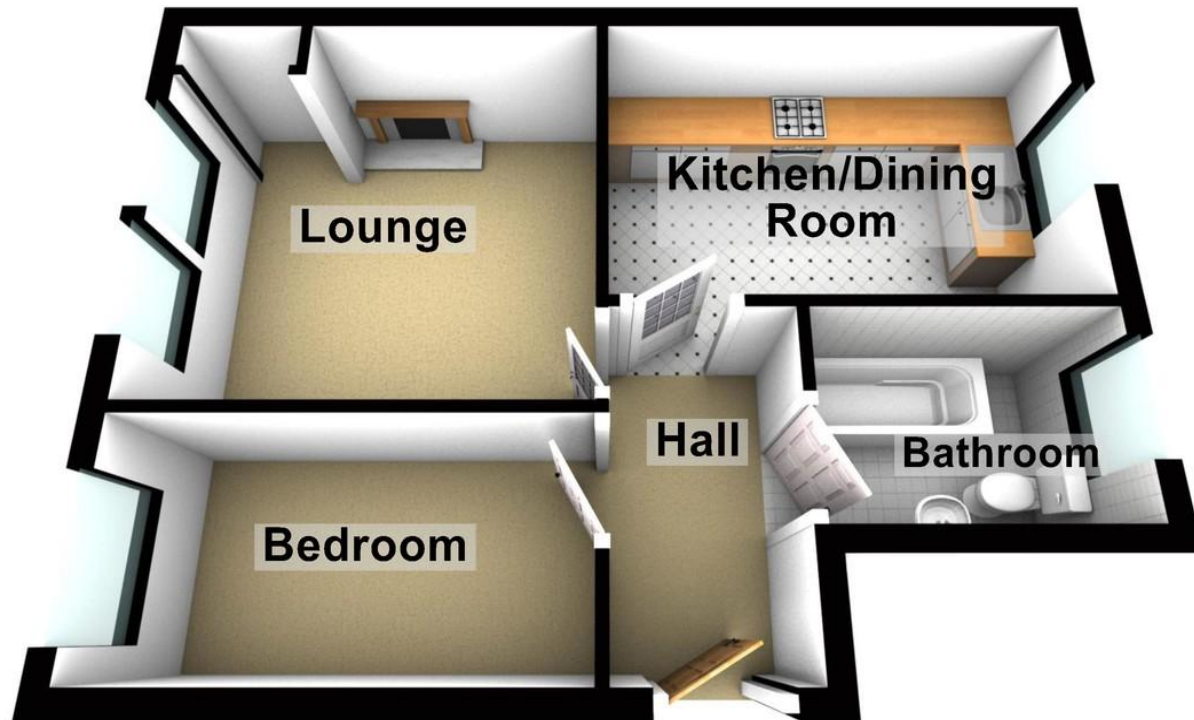

Property Room Sizes

HALL

11' 4" x 5' 1" (3.45m x 1.55m)

LOUNGE

13' 11" x 11' 10" (4.24m x 3.61m)

DINING KITCHEN

12' 6" x 10' 3" (3.81m x 3.12m)

BEDROOM

11' 7" x 8' 2" (3.53m x 2.49m)

BATHROOM

7' 0" x 5' 2" (2.13m x 1.57m)

PLEASE NOTE: These particulars whilst believed to be accurate are set out as a general outline only for guidance and do not constitute any part of an offer or contract intending, purchasers should not rely on them as statements or representations of fact, but must satisfy themselves by inspection or otherwise as to their accuracy. No person in this firm's employment has the authority to make or give representation or warranty in respect of the property. All room sizes are approximate and for general guidance only. They cannot be relied upon for fitting carpets, furniture etc.



TO ARRANGE A VIEWING OF THIS PROPERTY PLEASE TELEPHONE YOUR LOCAL BRANCH BELOW:

63 – 65 George Street, Perth 01738 44 43 42

41 - 43 Allan Street, Blairgowrie..... 01250 39 80 02

47a Atholl Road, Pitlochry..... 01796 54 80 14

1a James Square, Crieff.....01764 65 00 44

211 High Street, Auchterarder.....01764 66 36 66

Email sales@nexthomeonline.co.uk

For more information about Next Home and our services please visit www.nexthomeonline.co.uk

The only Perthshire estate agent available 7 days until 9pm

PLEASE NOTE: These particulars whilst believed to be accurate are set out as a general outline only for guidance and do not constitute any part of an offer or contract intending, purchasers should not rely on them as statements or representations of fact, but must satisfy themselves by inspection or otherwise as to their accuracy. No person in this firm's employment has the authority to make or give representation or warranty in respect of the property. All room sizes are approximate and for general guidance only. They cannot be relied upon for fitting carpets, furniture etc.

Registered Office Argyll House, Quarrywood Court, Livingston, West Lothian EH54 6AX. Registered in Scotland No. SC264812. NEXTHOME (Scotland) Ltd is an appointed representative of Kinggate Law Limited, which is authorised and regulated by the Financial Conduct Authority for advising on and arranging mortgages and insurance, broking and debt counselling of consumer credit agreements.



Next Home are proud to be members of the Property Ombudsman Scheme