

FOR SALE



Burgess House, Sanvey Gate

2 Bedrooms, 1 Bathroom

Asking Price Of £140,000



- City Centre Location
- APARTMENT
- Two bedrooms
- Open Plan Kitchen Living Area
- Family Bathroom
- Juliet balcony
- Allocated Parking Space

PROPERTY DESCRIPTION A two bedroom apartment located in the city centre. The property comprises in brief, entrance hallway, open plan living kitchen with fitted appliances, two double bedrooms, family bathroom, useful storage space. Allocated parking space with underfloor heating throughout. With a short walk to all shops, eateries and other forms of entertainment.

Energy Efficiency Rating

Score	Energy rating	Current	Potential
92+	A		
81-91	B	81 B	82 B
69-80	C		
55-68	D		
39-54	E		
21-38	F		
1-20	G		



ENTRANCE HALLWAY Accessed via front door, storage cupboard, open plan access to:

KITCHEN/LIVINGROOM 19' 10" x 12' 2" (6.05m x 3.71m) Wall and base units with work surfaces over, sink/drain unit, integrated cooker, hob and extractor fan, range of fitted appliances, two double glazed windows, laminate flooring

BEDROOM ONE 13' 6" x 9' 0" (4.11m x 2.74m) Double glazed window



BEDROOM TWO 13' 5" x 9' 5" (4.09m x 2.87m) Double glazed window

BATHROOM 7' 5" x 6' 9" (2.26m x 2.06m) Low level WC, panelled bath, hand wash basin, heated towel radiator

PARKING Allocated parking space

LEASE INFORMATION Lease remaining - 982 year left

Service charge and ground rent together per month - £178.92



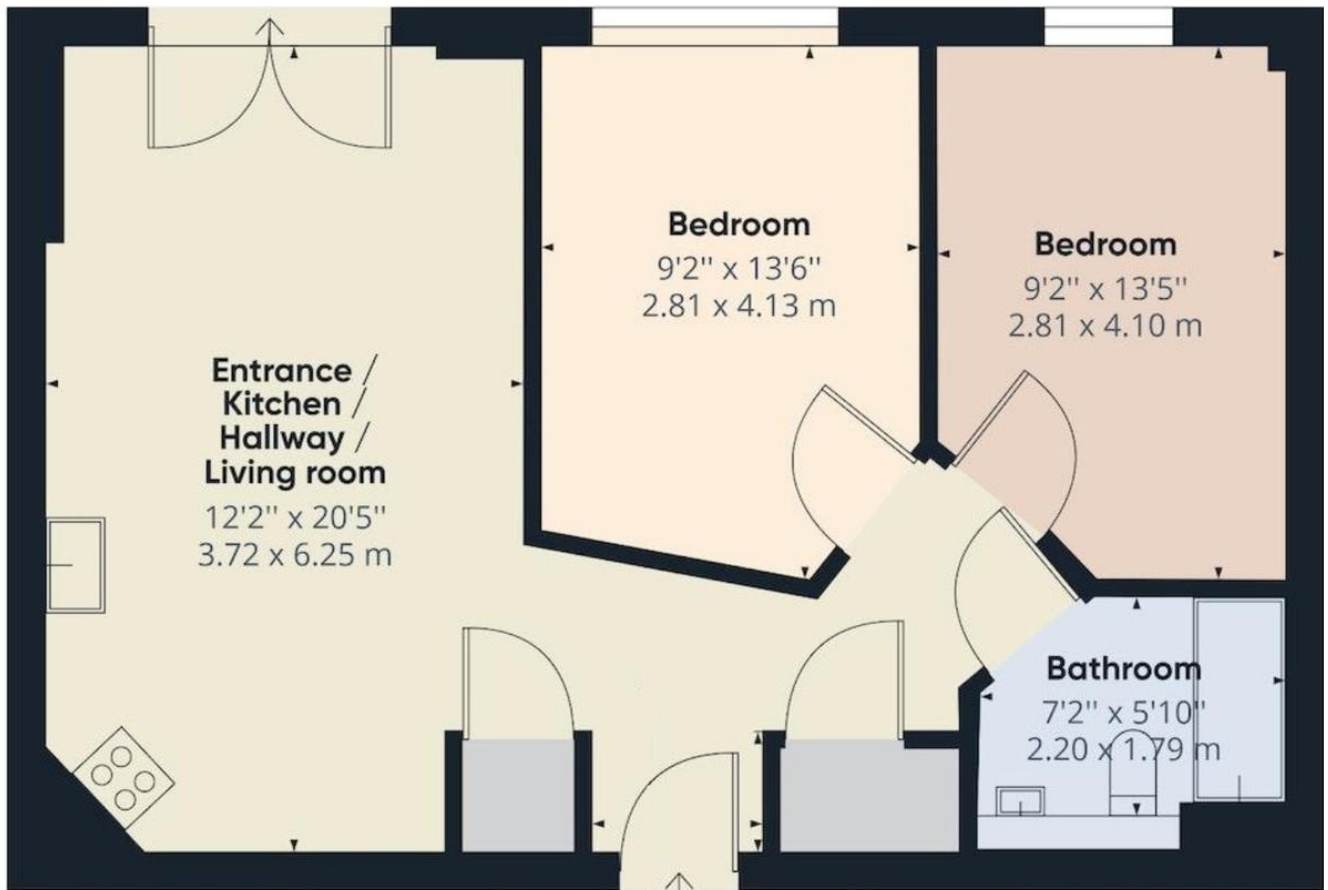

**** DO NOT USE** Martin & Co
Leicester (East)**

163 Narborough Road • Leicester • LE3 0BW

T: • E:

<http://www.martincto.com>



Accuracy: References to the Tenure of a Property are based on information supplied by the Seller. The Agent has not had sight of the title documents. A Buyer is advised to obtain verification from their Solicitor. Items shown in photographs including but not limited to carpets, fixtures and fittings are not included unless specifically mentioned within the sales particulars. They may however be available by separate negotiation. Buyers must check the availability of any property and make an appointment to view before embarking on any journey to see a property. No person in the employment of the agent has any authority to make any representation about the property, and accordingly any information given is entirely without responsibility on the part of the agents, sellers(s) or lessors(s). Any property particulars are not an offer or contract, nor for part of one. **Sonic / laser Tape:** Measurements taken using a sonic / laser tape measure may be subject to a small margin of error. **All Measurements:** All Measurements are Approximate. **Services Not tested:** The Agent has not tested any apparatus, equipment, fixtures and fittings or services and so cannot verify that they are in working order or fit for the purpose. A Buyer is advised to obtain verification from their Solicitor or Surveyor.