

2
BED

First Time Buyers / Investors
81, Telscombe Cliffs Way, East Sussex, BN10 7DD



Offers Over £255,000

Freehold

phillipmann
we do more

www.phillipmann.com

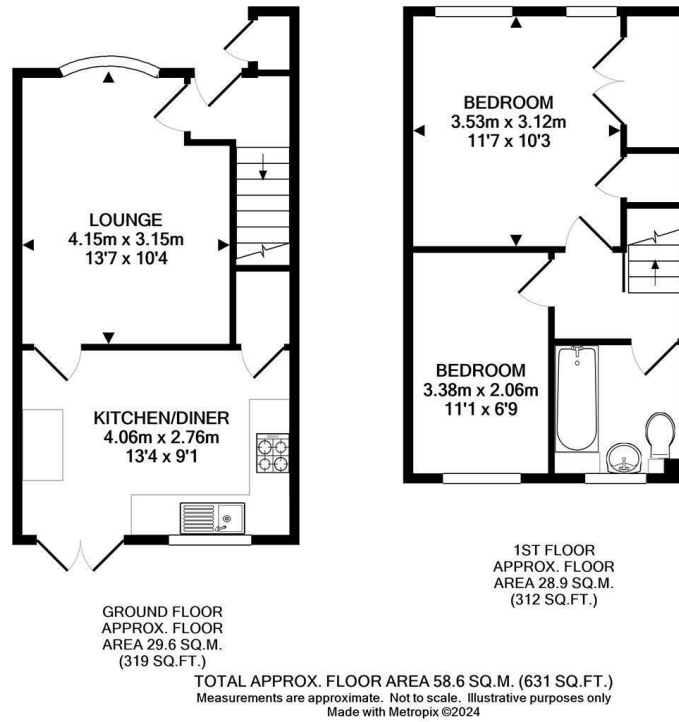

inbrief...

This superb modern home is certainly one not to be missed as alongside the well-proportioned, well-presented accommodation you will find a private sunny rear garden and modern fitted kitchen. The position is excellent as it is located in one of the most favoured areas of Telscombe Cliffs, where you will find Chatsworth Park and local school nearby. Furthermore, a short walk will take you to the local shop, bus routes to Brighton, open fields and countryside walks.

From the front door you gain access into the entrance hall, where you will find stairs that rise to the first floor. The west facing, bright and airy lounge is flooded with natural sunlight and overlooks the front garden. It offers plenty of space for all of your soft furnishings and associated furniture.

An opening at the rear leads into the kitchen/dining room. The kitchen has a number of matching wall and base units alongside space for appliances. There is a useful breakfast bar with further space for table and chairs with door leading to rear garden

Moving up to the first floor you will find two bedrooms one is located to the front and the other the rear. The master bedroom is positioned to the front and offers fitted storage whilst the second bedroom is situated to the rear and overlooks the garden. The bedrooms are serviced by the bathroom/wc which consists of a bath with shower over, wash basin, and wc.

Lastly outside will not disappoint, the front gardens are formal and mainly laid to lawn with centre path. The rear garden is private and offers a decked area, lawn covering, shrub borders and is enclosed by high fencing. It is the perfect spot to enjoy the sun right through the day. A gate to the rear of the garden accesses the parking area where your allocated spot can be found.



EPC - C

Council Tax Band - B

moreinfo...

Phillip Mann Peacehaven Office
226-230 South Coast Road, Peacehaven, BN10 8JR
01273 586622



To see more details on this & all our homes go to
www.phillipmann.com