

3
BED

Choice of Five Luxury New Homes

Plot 5, Violet Fields Close, Peacehaven, BN10 8GX



Price £425,000

Freehold

phillipmann
we do more

www.phillipmann.com

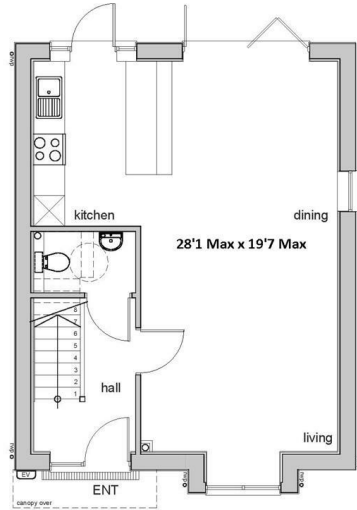

Ground Floor Plan

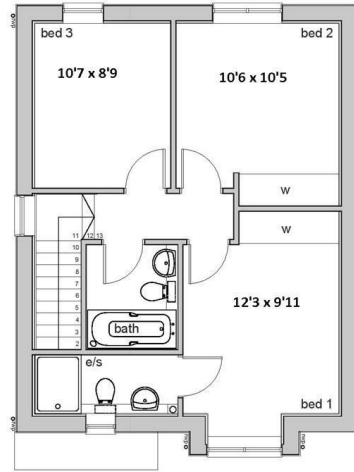

First Floor Plan

inbrief...

Last One Remaining!! ** Stamp Duty Paid for completions before Christmas - typical saving £8750 **

Violet Fields, features a bespoke development of just five private and contemporary detached homes all thoughtfully designed and beautifully finished. The development is set in a quiet road, offering views over the coast and countryside, in a thriving seaside town close to Brighton & Hove.

Five striking detached homes are positioned high on the Peacehaven weald with views over the surrounding countryside, and some with distant sea views. With high specification finishes and quality materials throughout, these homes will create a wonderful small enclave in the popular seaside town. With its down-land walks, new centenary Park and access to Brighton, Peacehaven is well worth exploring. Whether you are moving out, moving up or simply looking to relocate out of the City, these homes will have something to suit everyone.

Bright, spacious, and modern layouts - Designed over two floors with large loft space in the roof, these modern homes provide every possible on-trend feature. From the bright spacious cook/eat/living spaces, stunning designer kitchens through to the break-out garden rooms, they are very much designed for modern living. On the bedroom level are three sensibly balanced bedrooms and an en-suite to the main bedroom. Outside, the lawned gardens offer scope for offices and future extension (STP) and all driveways will come with a 7.2KW electric car charger point fitted as standard. With further ECO credentials these homes are designed to combat rising energy prices; making utility bills and the environment important factors in your next home. Expected to be rated EPC B these homes will be eligible for discounted mortgage rates available through the governments Green Mortgage initiative.

'PLEASE NOTE - floorplans and photos are indicative and some plots may have slightly different layouts - please refer to the agent for confirmation.'

** Conditions Apply



EPC Rating - B
Council Tax Band - TBC

moreinfo...



Phillip Mann Peacehaven Office
226-230 South Coast Road, Peacehaven, BN10 8JR
01273 586622

To see more details on this & all our homes go to
www.phillipmann.com