

2
BED

2 Bedroom Flat with Garage

Flat 3, 1, Lake Drive, Peacehaven, BN10 7QD



Price £205,000

Leasehold

phillipmann
we do more

www.phillipmann.com

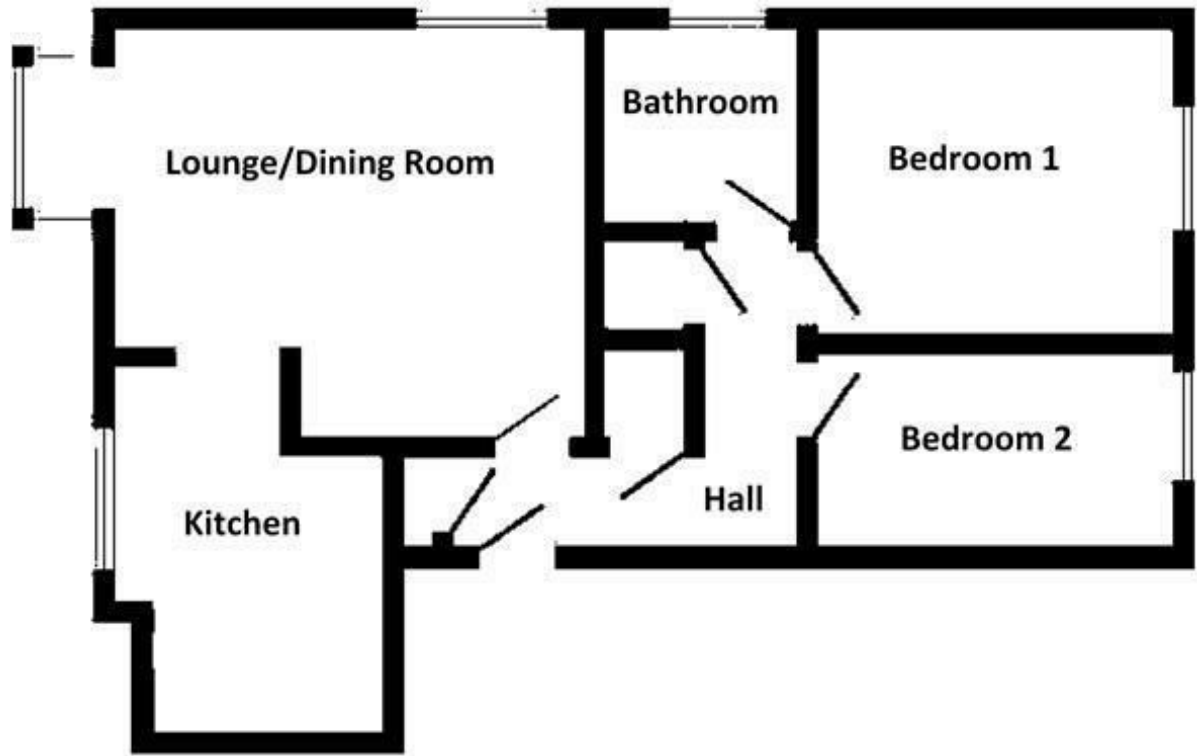

inbrief...

Phillipmann estate agents are pleased to offer for sale this spacious 2 bedroom apartment with GARAGE situated in the heart of Peacehaven, with the Meridian shopping centre, an array of amenities and local schools just a short walk away. This is the perfect property for first time or investment buyers looking to get on the ladder or looking for a buy to let investment.

ENTRANCE HALL Storage cupboard, airing cupboard housing hot and cold water tanks, laminate flooring and cloak cupboard.

DUAL ASPECT LOUNGE/DINING ROOM 15'2" max x 13'1" max (4.63m x 4.00m) South facing uPVC double glazed bay window with roof top and distant sea views, west facing uPVC double glazed window, laminate flooring and door to:

SOUTH FACING KITCHEN 9'8" max x 8'4" max (2.94m x 2.54m) A range of units to comprise of a single drainer sink unit, work surfaces with cupboards, drawers, space and plumbing for washing machine under, space for fridge/freezer, space for cooker with cooker hood over, wall mounted cupboards, part tiled walls, laminate flooring and uPVC double glazed window with roof top and distant sea views.

BEDROOM 1 11'4" x 9'10" (3.45m x 2.99m) uPVC double glazed window and laminate flooring.

BEDROOM 2 11'4" x 6'1" (3.45m x 1.85m) uPVC double glazed window and laminate flooring.

BATHROOM/WC 6'4" max x 6'3" max (1.93m x 1.90m) A white suite to comprise of a p-shape panelled shower/bath, vanity unit with wash hand basin and low level wc, fully tiled walls, uPVC frosted double glazed window and laminate flooring.

GARAGE 16'11" max x 7'11" max internal measurements (5.16m x 2.41m) Up-n-over door and lighting.

Lease: 125 years from 2016
Service Charge & Ground Rent: £187.83 per month



Council Tax - A

EPC - C

moreinfo...



Phillip Mann Peacehaven Office
226-230 South Coast Road, Peacehaven, BN10 8JR
01273 586622

To see more details on this & all our homes go to
www.phillipmann.com