

2  
BED

# Top Floor Flat in Convenient Location

Flat 11, 1 Meeching Road, Newhaven, BN9 9QX



Price £179,950

Leasehold

**phillipmann**  
we do more

[www.phillipmann.com](http://www.phillipmann.com)

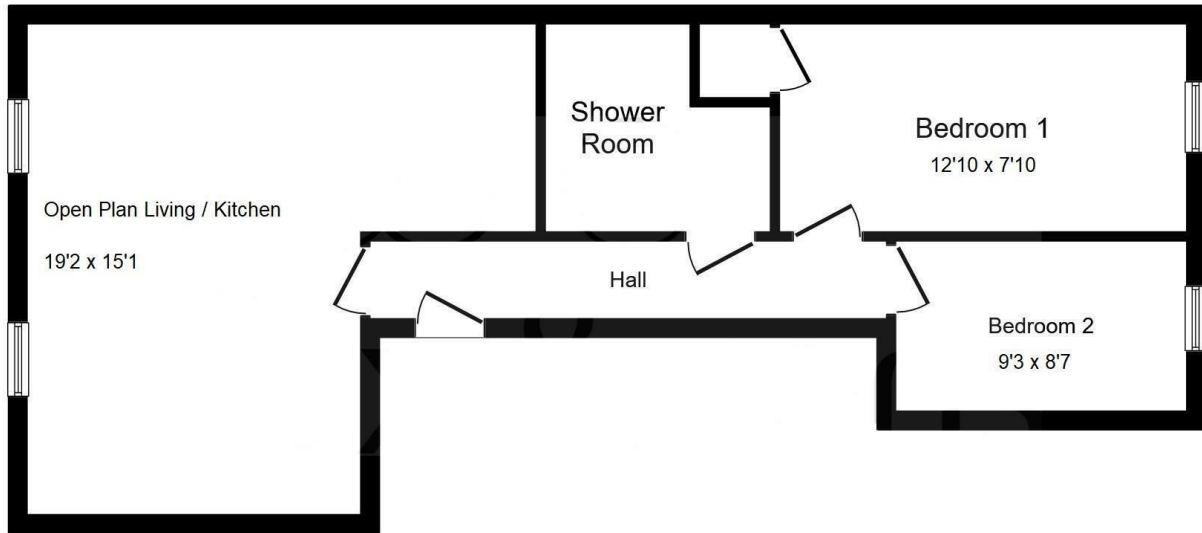

Floor Plan

## inbrief...

Phillip Mann estate agents are delighted to offer for sale this two bedroom third floor apartment located in a convenient location. The property forms part of this Grade Two listed building and is in excellent condition throughout.

The property is accessed via a communal entrance door with stairs which leads to the top floor (third). A private entrance door gives access to the entrance hall with tiled floor and loft access.

The open plan kitchen/lounge is a lovely bright spacious room with laminate flooring and several Velux windows overlooking the front with distant views of the South Downs. The kitchen area has a range of wall and base units which incorporates a selection of cupboards and drawers. There is a built in sink unit, electric hob with extractor hood above, electric oven and spaces for fridge/freezer and washing machine.

Bedroom one is a generous size room with a built in wardrobe and a Velux window overlooking the rear. Bedroom two is a further double with a Velux window. Completing the property is a shower room fitted with a shower cubicle, low level WC and wash hand basin.

Meeching Road is located in a convenient location being within a short walking distance to Newhaven Town Centre and bus routes to Eastbourne, Seaford and Brighton.



Energy Rating C

Council Tax Band B

moreinfo...



Phillip Mann Newhaven Office  
16 Bridge Street, Newhaven, BN9 9PJ  
01273 517517

To see more details on this & all our homes go to [www.phillipmann.com](http://www.phillipmann.com)