

1  
BED

# One Bedroom Ground Floor Flat With Patio

55a, Meeching Road, Newhaven, BN9 9RL



Offers Over £165,000

Leasehold

**phillipmann**  
we do more

[www.phillipmann.com](http://www.phillipmann.com)

55a Meeching Rd, BN9 9RL  
 Approximate Gross Internal Floor Area = 68.4 sq m / 736 sq ft

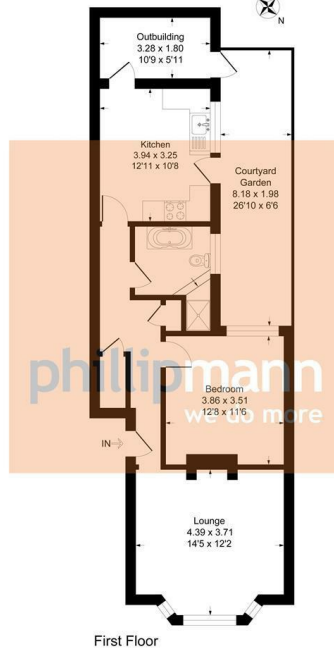

Illustration for identification purposes only, measurements are approximate, not to scale

## inbrief...

Phillip Mann estate agents are delighted to offer for sale this one bedroom ground floor flat located in a convenient location. The property has spacious accommodation and enjoys use of a small private patio.

A communal entrance door gives access to a communal hallway, from here, there is a private entrance door which leads to the flat.

There is a spacious entrance hall with several storage cupboards and doors which lead to the accommodation. The lounge is located at the front of the property and enjoys an open inset fireplace and a bay window overlooks the front.

The kitchen has been recently refitted and has a excellent range of wall and base units which incorporates a selection of cupboards and drawers. There is a built in cooker, four ring electric hob and there are space for washing machine and fridge/freezer. The room is complete with part tiled walls and a window overlooks the side.

The bedroom is a generous size with ample space for a double wardrobe and a window overlooks the rear patio. Completing the inside is a refitted bathroom which has a freestanding bath, separate shower cubicle, wash hand basin and low level WC.

Outside there is a low maintenance rear garden which is laid to patio.



Council Tax Band B

Energy Rating D

moreinfo...



Phillip Mann Newhaven Office  
 16 Bridge Street, Newhaven, BN9 9PJ  
 01273 517517

To see more details on this & all our homes go to  
[www.phillipmann.com](http://www.phillipmann.com)