

2  
BED

# Stunning Two Bedroom House With Large Garden

9, New Road, Newhaven, BN9 0HE



Offers Over £259,950

Freehold

**phillipmann**  
we do more

[www.phillipmann.com](http://www.phillipmann.com)

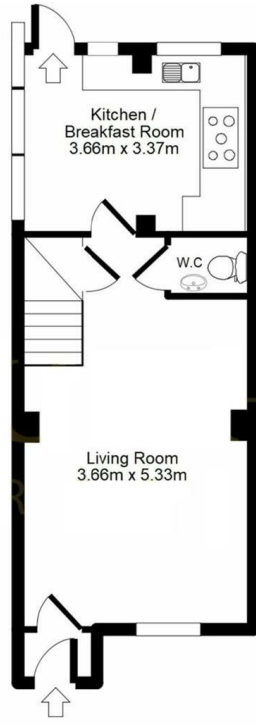

Ground Floor



First Floor

## inbrief...

Phillip Mann estate agents are delighted to offer for sale this stunning two bedroom terrace house located in South Heighton. The property has been tastefully refurbished and benefits from a 200' rear garden.

A part glazed stable door gives access to the house which leads directly into the large lounge/diner. This room is a lovely bright space with ample space for a dining table and a window overlooks the front of the property.

To the rear of the property is an excellent refitted kitchen which has a selection of cupboards and drawers. There is a built in sink unit which is set into work-surface, space for range cooker, washing machine and fridge/freezer. This room is complete with part tiled walls, tiled flooring, space for breakfast table and windows which overlook the rear garden. Completing the ground floor is a cloakroom.

The first floor landing has access to the remainder of the accommodation. Bedroom one is a generous size double overlooking the front. Bedroom two overlooks the rear garden with ample space for wardrobes. From this room there is access to a bathroom which has been tastefully refitted to include a paneled bath with shower over, low level WC and wash hand basin. Completing the inside is a further double bedroom which overlooks the front.

Outside the garden is a particular feature of this property measuring approx 200'. There are several different areas with established trees and plants. The garden is timber fence enclosed.



Council Tax Band B

Energy Rating D

moreinfo...



Phillip Mann Newhaven Office  
16 Bridge Street, Newhaven, BN9 9PJ  
01273 517517

To see more details on this & all our homes go to  
[www.phillipmann.com](http://www.phillipmann.com)