

2
BED

Stunning Two Bedroom House With Large Garden

9, New Road, Newhaven, BN9 0HE



Price £269,950

Freehold

phillipmann
we do more

www.phillipmann.com

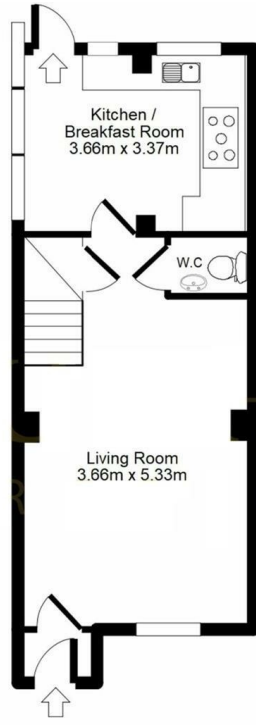

Ground Floor



First Floor

inbrief...

Phillip Mann estate agents are delighted to offer for sale this stunning two bedroom terrace house located in South Heighton. The property has been tastefully refurbished and benefits from a 200' rear garden.

A part glazed stable door gives access to the house which leads directly into the large lounge/diner. This room is a lovely bright space with ample space for a dining table and a window overlooks the front of the property.

To the rear of the property is an excellent refitted kitchen which has a selection of cupboards and drawers. There is a built in sink unit which is set into work-surface, space for range cooker, washing machine and fridge/freezer. This room is complete with part tiled walls, tiled flooring, space for breakfast table and windows which overlook the rear garden. Completing the ground floor is a cloakroom.

The first floor landing has access to the remainder of the accommodation. Bedroom one is a generous size double overlooking the front. Bedroom two overlooks the rear garden with ample space for wardrobes. From this room there is access to a bathroom which has been tastefully refitted to include a paneled bath with shower over, low level WC and wash hand basin. Completing the inside is a further double bedroom which overlooks the front.

Outside the garden is a particular feature of this property measuring approx 200'. There are several different areas with established trees and plants. The garden is timber fence enclosed.



Council Tax Band B

Energy Rating D

moreinfo...



Phillip Mann Newhaven Office
16 Bridge Street, Newhaven, BN9 9PJ
01273 517517

To see more details on this & all our homes go to
www.phillipmann.com