

## Coleridge Way, West Drayton, Middlesex, UB7 9HR

- Two bedroom split level maisonette
- Double bedrooms
- Available for February
- Furnished
- EPC Rating- C
- Council tax band D

**£1,525 PCM**

**Description**

Two Double bedroom split level apartment, situated within easy access of Heathrow Airport and major road links including M4 & M25. Accommodation set out over levels and comprises of; entrance hall, reception room, separate kitchen with appliances, two double bedrooms and a family bathroom all tailored to a neutral décor throughout. Available for February and presented furnished.

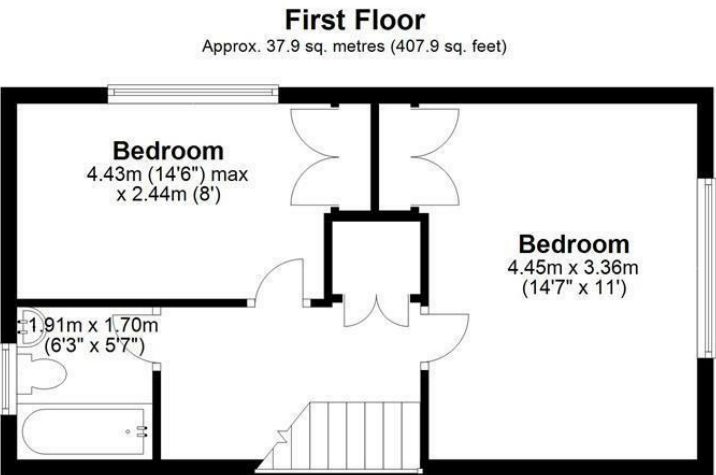
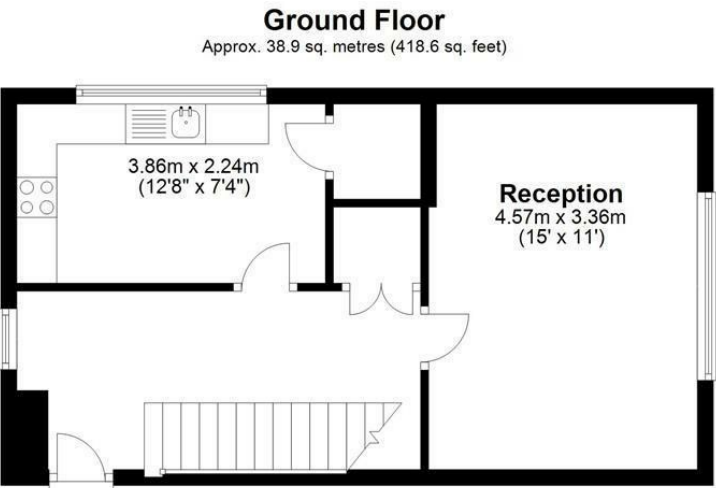

Total area: approx. 76.8 sq. metres (826.5 sq. feet)

**IMPORTANT NOTICE**

These particulars have been prepared upon information supplied by the Vendor and should be verified by your surveyors and solicitors. We have prepared these sales particulars as a general guide to give a broad description of the property. They are not intended to constitute part of an offer or contract. We have not carried out a structural survey and the services, appliances and specific fittings have not been tested. All photographs, measurements, floor plans and distances referred to are given as a guide only and should not be relied upon for the purchase of carpets or any other fixtures or fittings. Lease details service charge and ground rent (where applicable) are given as a guide only and should be checked and confirmed by your solicitor prior to exchange of contracts