



## Evergreen Drive, West Drayton, Middlesex, UB7 9GQ

- Drayton Garden Village
- Part Furnished
- Parking
- Available January
- Two bedroom house
- On site supermarket
- EPC Rating - C

**£1,900 PCM**



**Description**

A modern two bedroom end of terrace property situated in Drayton Garden Village constructed by Weston Homes. Accommodation comprises; entrance hall, downstairs W.C, modern kitchen with integrated appliances, spacious reception benefiting from patio doors leading to private rear garden, two double bedrooms and a luxury three piece suite bathroom all tailoring to a neutral decor and consisting of neat tidy finishes throughout. Available for January and presented part furnished.

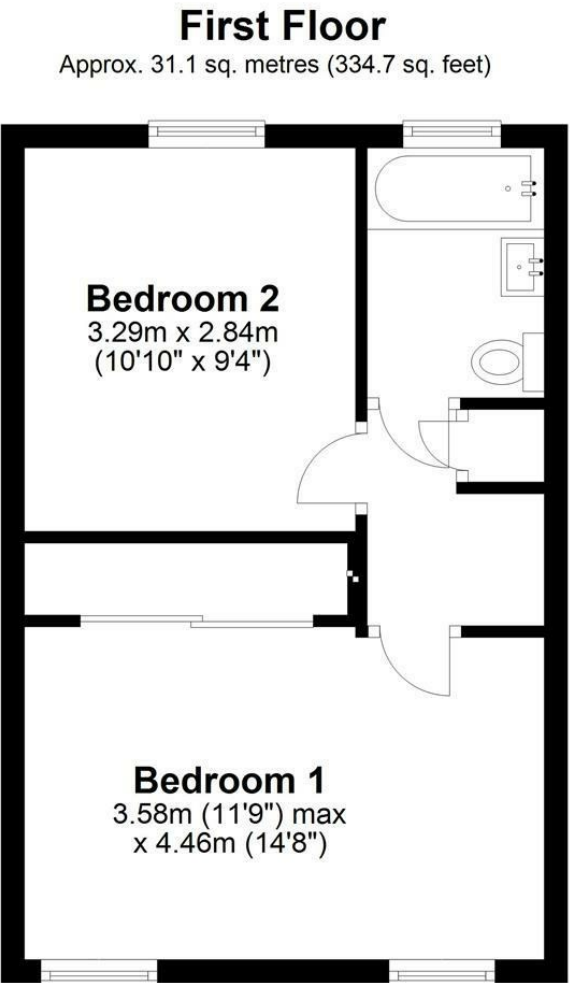
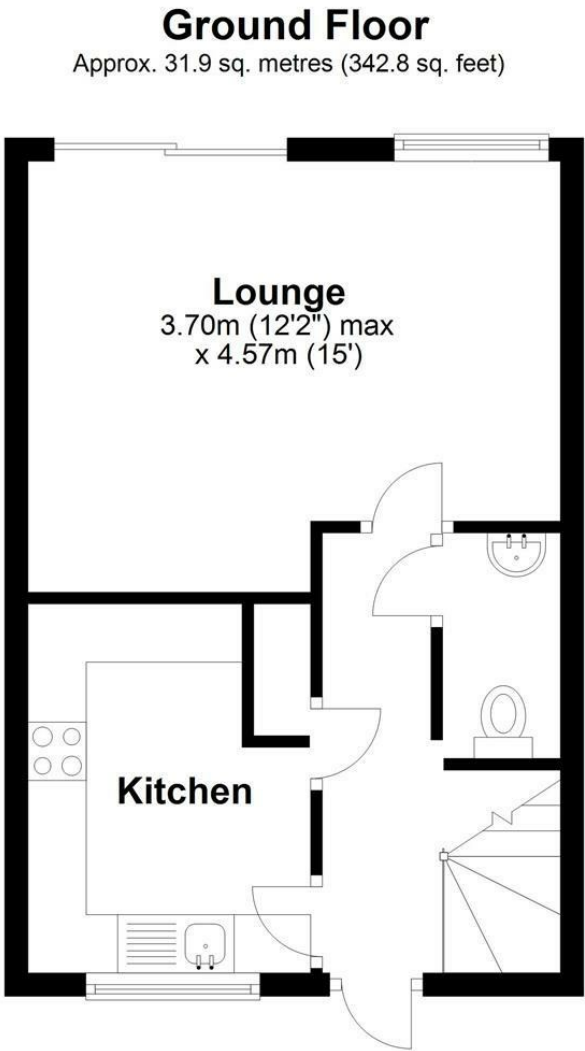

Total area: approx. 62.9 sq. metres (677.6 sq. feet)

**IMPORTANT NOTICE**

These particulars have been prepared upon information supplied by the Vendor and should be verified by your surveyors and solicitors. We have prepared these sales particulars as a general guide to give a broad description of the property. They are not intended to constitute part of an offer or contract. We have not carried out a structural survey and the services, appliances and specific fittings have not been tested. All photographs, measurements, floor plans and distances referred to are given as a guide only and should not be relied upon for the purchase of carpets or any other fixtures or fittings. Lease details service charge and ground rent (where applicable) are given as a guide only and should be checked and confirmed by your solicitor prior to exchange of contracts