



9 Pennyroyal Drive, West Drayton, UB7 9FF

- Richmond Court
- Two double bedrooms
- En suite
- Furnished
- Available August
- Top floor
- Bosch appliances
- Parking
- EPC Rating- B

£1,800 PCM

Description

A modern two double bedroom top floor apartment located in the ever popular eco friendly, landscaped Drayton Garden Village. This larger than average corner apartment benefits from a large balcony giving stunning views, open plan reception area with large windows allowing plenty of natural light, luxury fitted kitchen with built in Bosch appliances hard wood flooring throughout, two double bedrooms with built in wardrobe to the master, fully tiled luxury bathroom and en -suite, ample storage and allocated parking. Located within a short distance to the train line and high street, presented to the market furnished and available for August.

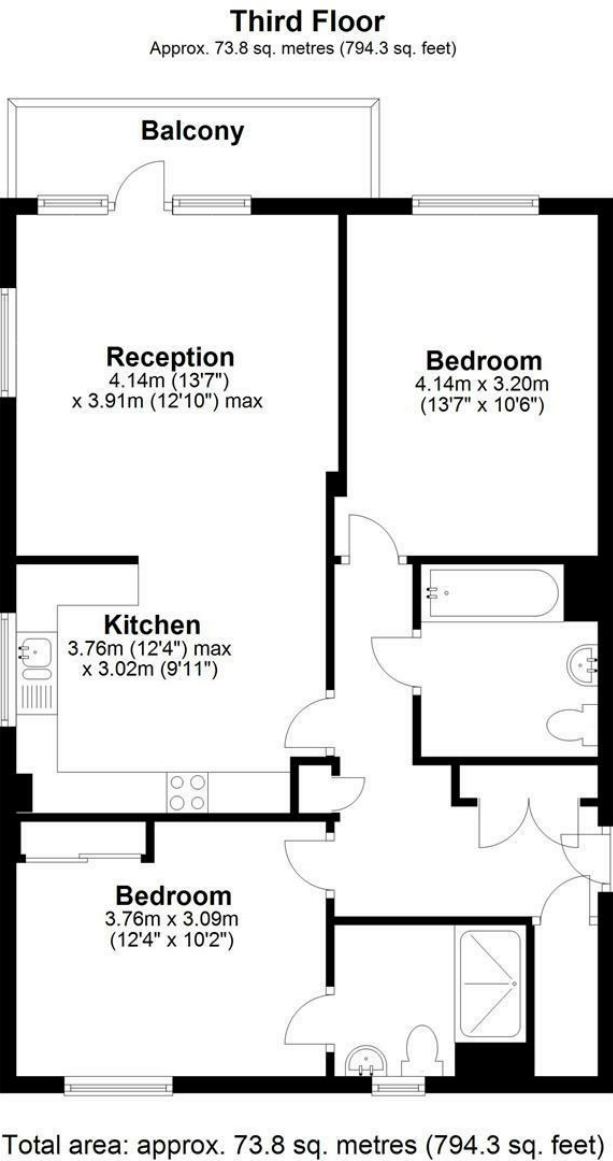

IMPORTANT NOTICE

These particulars have been prepared upon information supplied by the Vendor and should be verified by your surveyors and solicitors. We have prepared these sales particulars as a general guide to give a broad description of the property. They are not intended to constitute part of an offer or contract. We have not carried out a structural survey and the services, appliances and specific fittings have not been tested. All photographs, measurements, floor plans and distances referred to are given as a guide only and should not be relied upon for the purchase of carpets or any other fixtures or fittings. Lease details service charge and ground rent (where applicable) are given as a guide only and should be checked and confirmed by your solicitor prior to exchange of contracts