

New Road, Hillingdon, UB8 3DX

- Well Presented Throughout
- Small Private Court Yard
- Available June
- EPC rating D
- Reduced deposit
- One Bedroom House
- Off Street Parking
- Popular Location
- Several bus routes to key locations

£1,295 PCM

Description

A well represented one bedroom house located off Uxbridge Road. This property offers wood laminate flooring to the living room and carpet to the landing and bedroom. A fitted kitchen with appliances and bathroom with electric shower. Off street parking and a small private court yard. Well positioned providing strong transport links with direct bus route to Uxbridge town centre, Elizabeth Line in approx 20 minutes and Heathrow, recreational grounds, Hillingdon Hospital, Stockley Business Park and Brunel University. Available for end June and presented unfurnished. Reduced deposit.

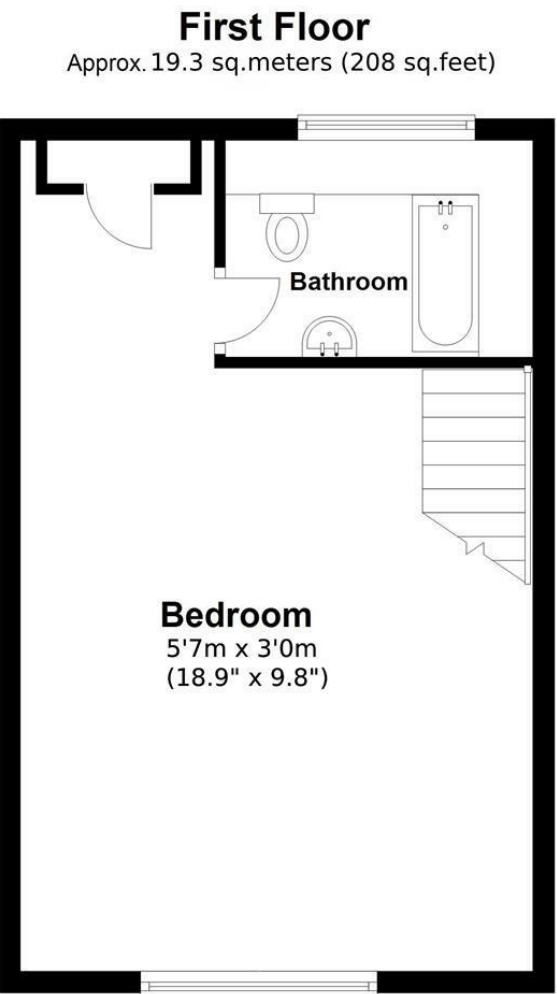
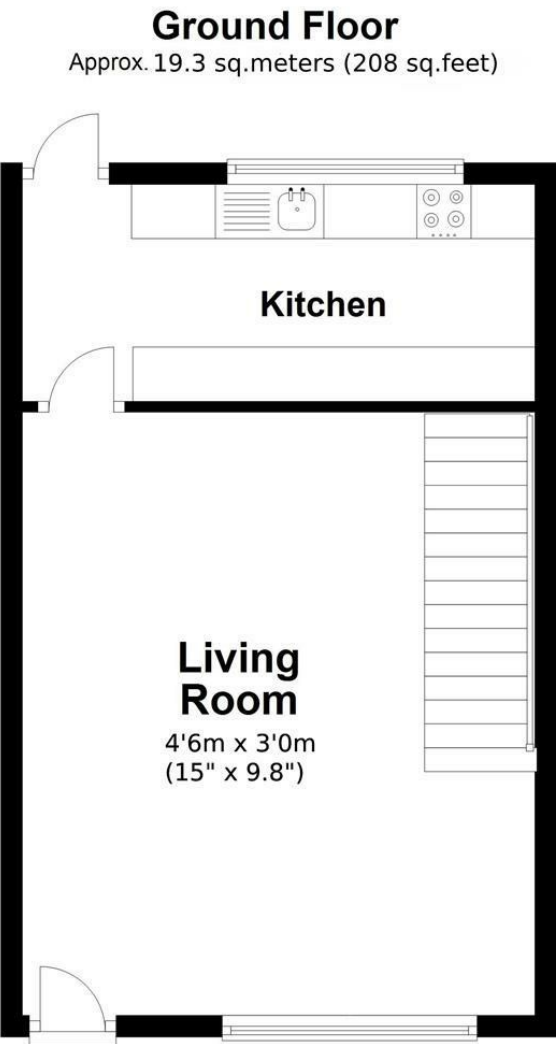

Total area: approx. 38.6 sq.meters (416 sq.feet)

IMPORTANT NOTICE

These particulars have been prepared upon information supplied by the Vendor and should be verified by your surveyors and solicitors. We have prepared these sales particulars as a general guide to give a broad description of the property. They are not intended to constitute part of an offer or contract. We have not carried out a structural survey and the services, appliances and specific fittings have not been tested. All photographs, measurements, floor plans and distances referred to are given as a guide only and should not be relied upon for the purchase of carpets or any other fixtures or fittings. Lease details service charge and ground rent (where applicable) are given as a guide only and should be checked and confirmed by your solicitor prior to exchange of contracts