



Bittern House, 28 Wraysbury Drive, Yewlsey, UB7 7FH

- Bittern House
- Lifts
- Furnished
- EPC Rating- C
- Fourth floor
- Two bedrooms
- Canal facing
- Available early September

£1,700 PCM

Description

A two bedroom, two bathroom penthouse located on the fourth floor on the Waterside Park development in Yiewsley. Close to local amenities and transport links. The apartment boasts two double bedrooms, two modern bathrooms (one en-suite), a large reception room with large windows overlooking the grand union canal, modern fitted kitchen and dining area. Available early September and presented furnished.

Fourth Floor
Approx. 64.0 sq. metres (689.2 sq. feet)

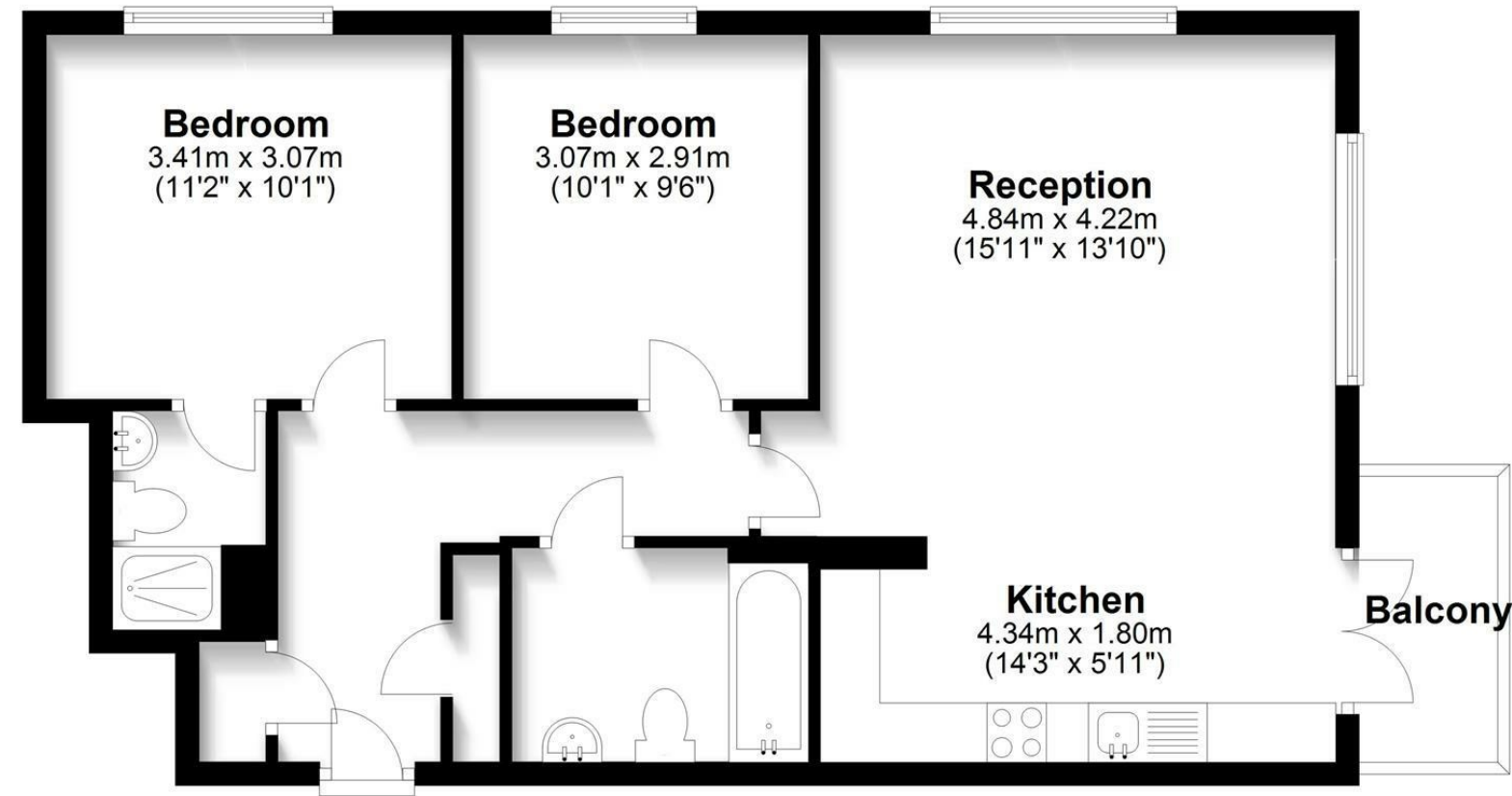

Total area: approx. 64.0 sq. metres (689.2 sq. feet)

IMPORTANT NOTICE

These particulars have been prepared upon information supplied by the Vendor and should be verified by your surveyors and solicitors. We have prepared these sales particulars as a general guide to give a broad description of the property. They are not intended to constitute part of an offer or contract. We have not carried out a structural survey and the services, appliances and specific fittings have not been tested. All photographs, measurements, floor plans and distances referred to are given as a guide only and should not be relied upon for the purchase of carpets or any other fixtures or fittings. Lease details service charge and ground rent (where applicable) are given as a guide only and should be checked and confirmed by your solicitor prior to exchange of contracts