

Station House, Station Approach, West Drayton, UB7

- Station House
- One bedroom apartment
- Furnished
- Available for July

£1,275 PCM

Description

A first floor one bedroom apartment located in the heart of West Drayton in an exclusive development, Station House, within a stones throw away from the station giving access onto the Elizabeth Line. Modern finishing throughout including quartz work tops, down lighting to the kitchen, built in appliances, high ceilings, luxury shower room with vanity lit mirror. Presented to the market furnished and available for July.

First Floor

Approx. 42.5 sq. metres (457.3 sq. feet)

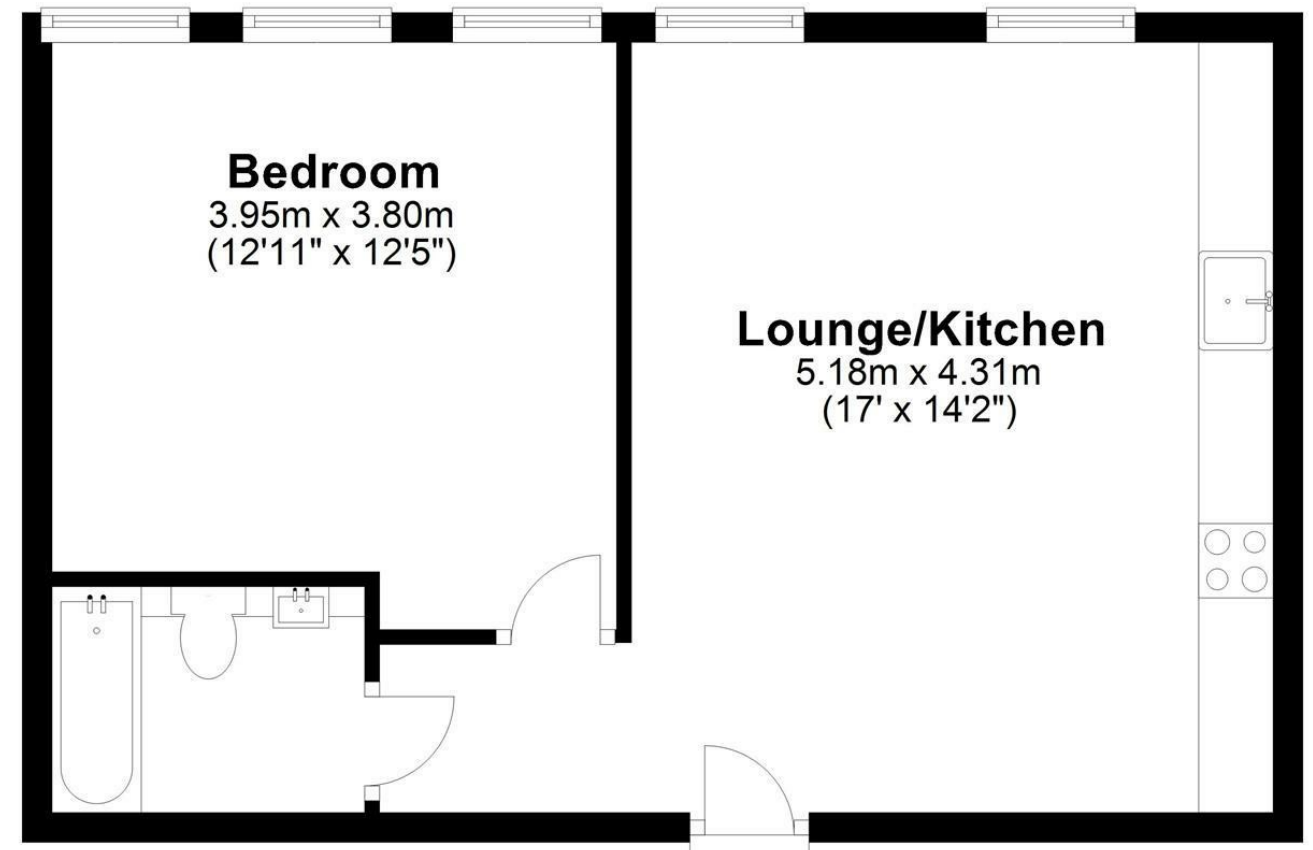

Total area: approx. 42.5 sq. metres (457.3 sq. feet)

IMPORTANT NOTICE

These particulars have been prepared upon information supplied by the Vendor and should be verified by your surveyors and solicitors. We have prepared these sales particulars as a general guide to give a broad description of the property. They are not intended to constitute part of an offer or contract. We have not carried out a structural survey and the services, appliances and specific fittings have not been tested. All photographs, measurements, floor plans and distances referred to are given as a guide only and should not be relied upon for the purchase of carpets or any other fixtures or fittings. Lease details service charge and ground rent (where applicable) are given as a guide only and should be checked and confirmed by your solicitor prior to exchange of contracts