



TO LET

Jasmine Square, Woodley, RG5 4DY

£3,000



- Four bedroom detached
- Available 11th August
- Unfurnished
- Overlooking a river & nature reserve
- Excellent condition throughout
- 3 mile cycle to Twyford Station

THE PROPERTY

Jasmine Square - Offered new to the market this four bedroom detached house for rent over looking a river and nature reserve. The property benefits from open plan living on the ground floor - lounge, kitchen/diner/breakfast room, additional separate kitchen, WC. Four double bedrooms, two en-suites and family bathroom over the first and second floor. Private landscaped rear garden small garage area, off road parking. Under floor heating downstairs, bi-folding doors from kitchen/diner/breakfast room opening to rear garden. Located in a cul-de-sac of four houses, 3 miles cycle or 3.7 miles drive to Twyford Station. Available 11th August, unfurnished. Council tax band F.

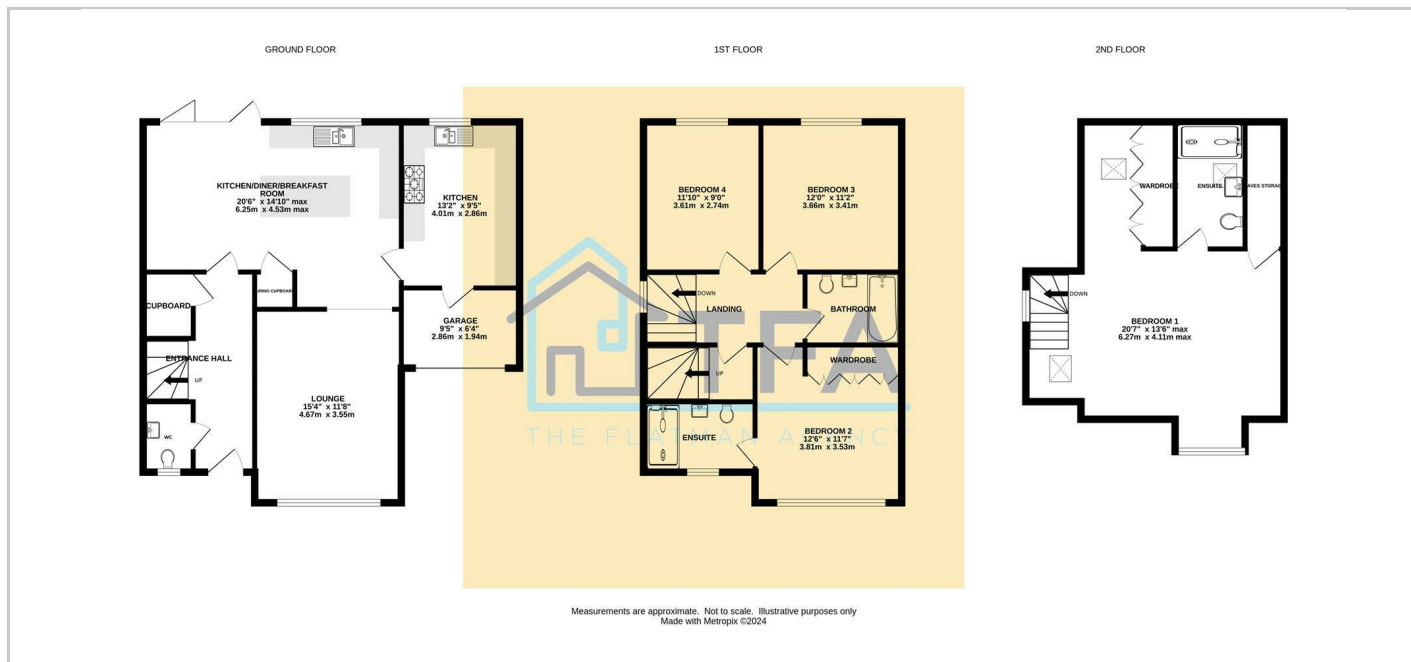

Directions