

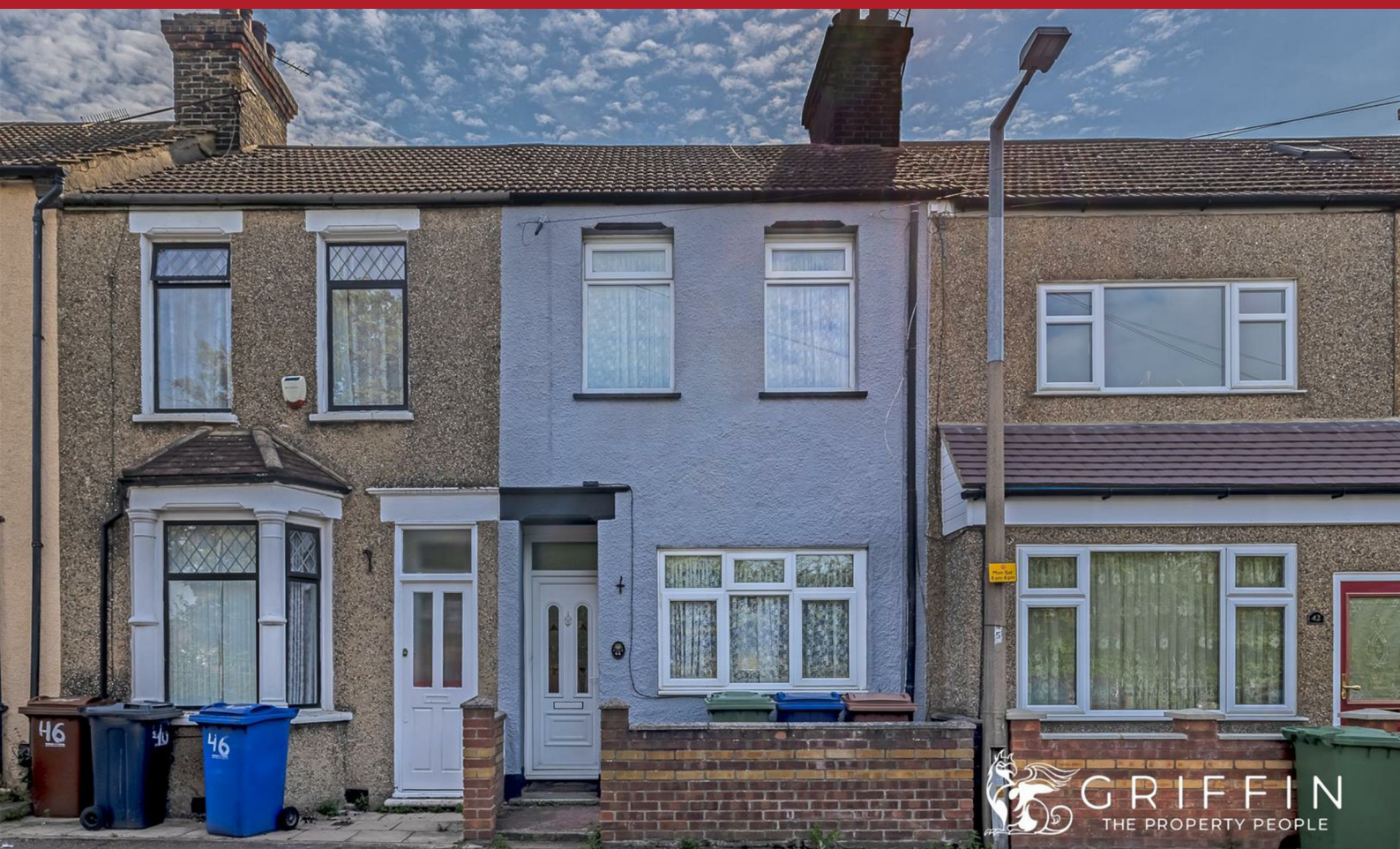

GRIFFIN

THE PROPERTY PEOPLE



Whitehall Lane , Grays, RM17 6SS

Guide price £330,000

Griffin are delighted to off For Sale this Three bedroom Terraced property in Grays. Accommodation comprises entrance hall, Lounge/Diner, Kitchen, Bathroom, first floor landing and three bedrooms. The property offers a modern fitted kitchen, double glazed window, gas central heating and a rear garden. The property is situated within reach of Local shops, bus routes and Grays Towncentre with mainline railway station. An early internal viewing is highly recommended.

*** GUIDE PRICE £330,000 - £350,000 ***

- THREE BEDROOMS
- MID TERRACED HOUSE
- ACCESS TO GRAYS TOWNCENTRE
- MODERN FITTED KITCHEN
- DOUBLE GLAZED
- GAS HEATING
- NO ONWARD CHAIN
- CALLING FIRST TIME BUYERS

Viewing

Please contact our Grays Sales Office on 01375 397872 if you wish to arrange a viewing appointment for this property or require further information.



Floor Plan

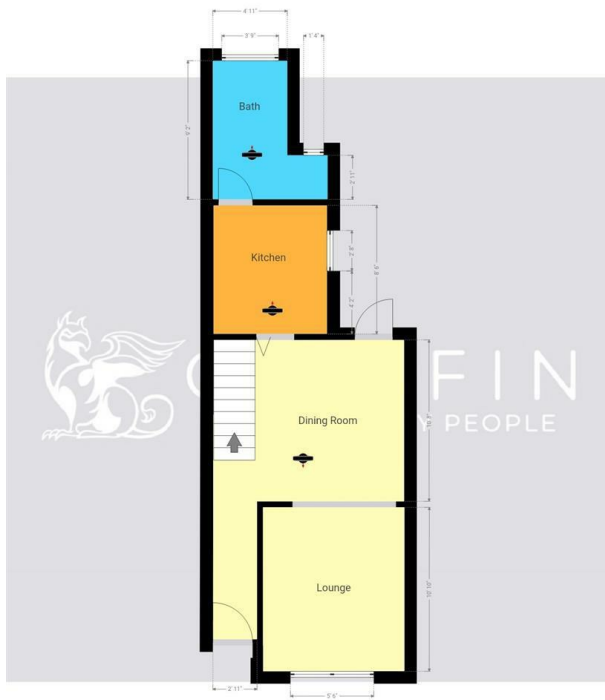

Total House area approximately 738sq ft.
The Griffin Property Group take no responsibility for any error, omission, misstatement or use of data shown. This plan is for illustrative purposes only and whilst every attempt has been made to ensure the accuracy of the floor plan shown, all measurements, positioning, fixtures, fittings and any other data shown are an approximate integration for illustrative purposes only. These plans are the property of The Griffin Property Group and must not be reproduced in any form without our permission.

Area Map



Energy Efficiency Graph

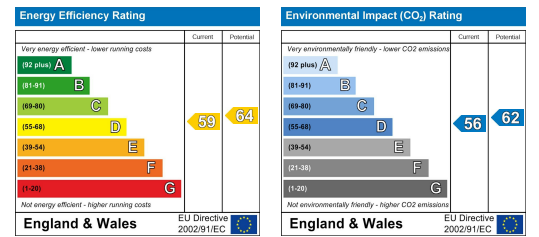

These particulars, whilst believed to be accurate are set out as a general outline only for guidance and do not constitute any part of an offer or contract. Intending purchasers should not rely on them as statements of representation of fact, but must satisfy themselves by inspection or otherwise as to their accuracy. No person in this firm's employment has the authority to make or give any representation or warranty in respect of the property.