



GRIFFIN

THE PROPERTY PEOPLE



Kempsters

Sundew Court , Grays, RM17 6UX

Guide price £375,000

This well presented three bedroomed semi detached house is situated in the popular Little Thurrock location and lies within walking distance of local schools, town centre and Grays station. Features include a bright lounge, fitted kitchen/diner, conservatory, rear garden 36' x 30 plus carport and driveway providing ample off road parking.

- Sought After Location
- Bright Lounge
- Fitted Kitchen/Diner
- Conservatory
- Stylish Bathroom
- Rear Garden 36' x 30'
- Carport And Driveway Providing Ample Off Road Parking
- Walking Distance To Local Schools, Town Centre And Grays Station

Viewing

Please contact our Grays Sales Office on 01375 397872 if you wish to arrange a viewing appointment for this property or require further information.

 3  1  2  D

Kempsters

Floor Plan

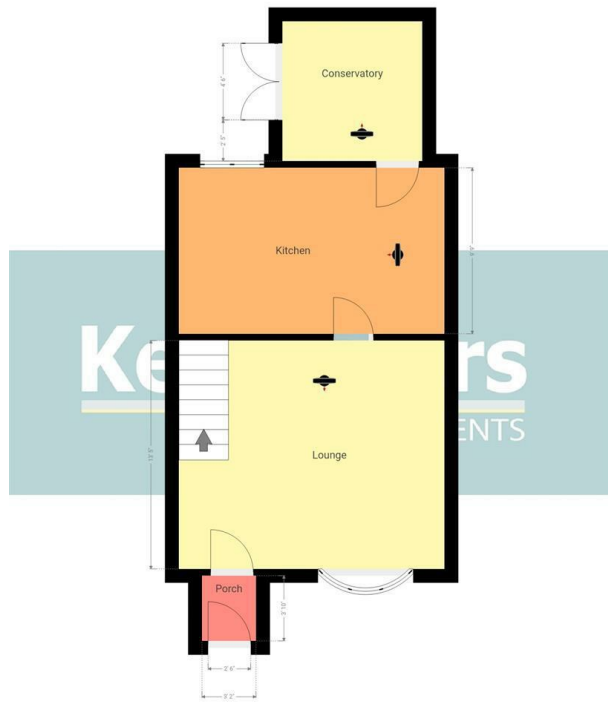

Kempsters Estate Agents take no responsibility for any errors, omissions, misstatement or use of data shown. This plan is for illustrative purposes only and whilst every attempt has been made to ensure the accuracy of the floorplan shown, all measurements, positioning, fixtures, fittings and any other data shown are an approximate interpretation for illustrative purposes only. These plans are the property of Kempsters Estate Agents Ltd and must not be reproduced in any form without our permission.

Area Map



Energy Efficiency Graph

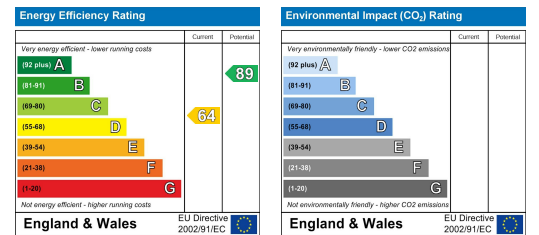

These particulars, whilst believed to be accurate are set out as a general outline only for guidance and do not constitute any part of an offer or contract. Intending purchasers should not rely on them as statements of representation of fact, but must satisfy themselves by inspection or otherwise as to their accuracy. No person in this firm's employment has the authority to make or give any representation or warranty in respect of the property.